

KOLSTRA

TRAVELSLEEPER

Gebrauchsanleitung (DE)

Brugsanvisning (DK)

Manual de utilización (ES)

Käyttöohje (FI)

Notice d'utilisation (FR)

Instruction manual (GB)

Istruzioni per l'uso (IT)

Gebruiksaanwijzing (NL)

Brukerveiledning (NO)

Manual de utilização (PT)

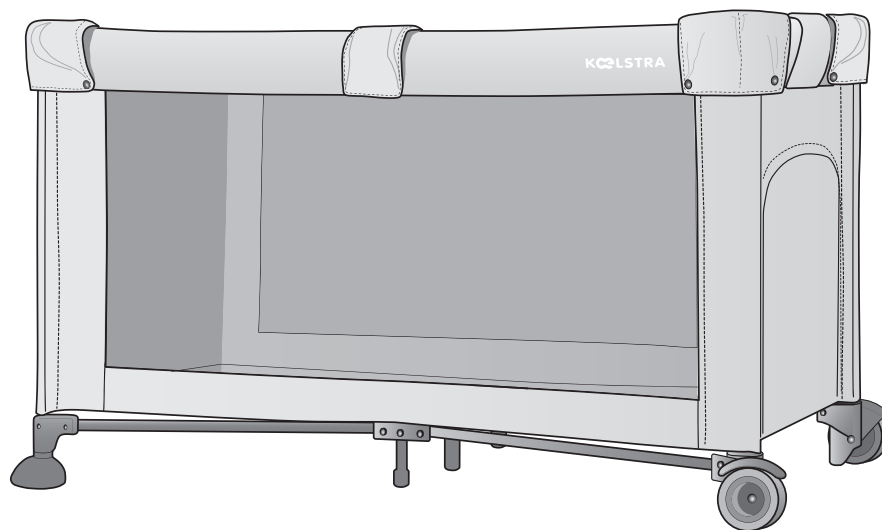

Deutsch DE 3 - 13

Dansk DK 3 - 13

Español ES 3 - 13

Suomi FI 3 - 13

Français FR 3 - 13

English GB 3 - 13

Italiano IT 3 - 13



Nederlands NL 3 - 13

Norsk NO 3 - 13

Português PT 3 - 13

Preface

Dear Customer,

Please read this instruction manual carefully and study the appendix with the safety information and warranty before using your travel cot. It is important that any other person using this travel cot reads and understands both documents. Demonstrate how the travel cot works (especially how to operate the central lock) before lending it to anyone else. If you do not follow up the instructions, maintenance suggestions and warnings, you may be jeopardising your child's safety. Keep both documents in a safe place for future reference. Safety instructions have the  symbol, tips the  symbol.

The travel cot can be used for children aged 0 to approximately 4 and has a load-bearing capacity up to a maximum weight of 18 kg.

It is important to check the complete travel cot and all its accessories before use. If a part is missing or damaged, please report this to your Koelstra point of sale within seven days of purchase.

We hope you enjoy using your Koelstra travel cot!
www.koelstra.com

This product has been manufactured in accordance with European standard EN 716-1 & -2:2008. This instruction manual has been compiled with care and meets the requirements and regulations in accordance with the Netherlands (NEN) 5509 standard.

Warning!

- Use the product only for its intended purpose. Using it for any other purpose is improper and dangerous. Koelstra BV cannot be held liable for any damage caused or injuries sustained due to incorrect or improper use of your product.
- This Koelstra product is not a toy, never allow children to play with the travel cot.

Attention!

- A child's safety is your responsibility.
- The safety regulations and warranty conditions can be found in a separate, attached appendix. To claim on the warranty you must be able to show the travel cot together with the serial number*, proof of purchase and a fully completed warranty form. The sticker with the serial number can be found on the bottom of the travel cot.

Tip!

- Save your proof of purchase in the designated place at the back of the book with the safety regulations and warranty conditions.

**Only so-called 'hard goods' have a serial number. 'Soft goods' do not have a serial number.*

Table of Contents

What's in the box?	6
Product Description	7
1 Unpacking and assembling the product	8
1.1 Before using it for the first time	8
1.2 Unfolding the travel cot	8
1.3 Positioning the mattress	9
1.4 Zip-up crawling hatch	9
2 Moving/positioning the travel cot	9
2.1 Positioning the travel cot	9
2.2 Moving the travel cot	10
3 Transporting and storing the travel cot	10
3.1 Folding up the travel cot	10
3.2 Storing the travel cot	11
3.3 Transporting the travel cot	11
4 Maintenance	11
4.1 General	11
4.2 Cleaning the travel cot	11
4.3 Faults	12
5 Accessories	12
5.1 Care bag (Optional)	12
6 Technical specifications	13
7 Disposing of product and packaging	13

What's in the box?

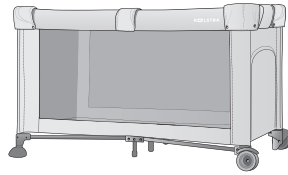

Travel cot



Travel bag



Instructions for use



Safety regulations
Warranty conditions

Product Description

Travel bag

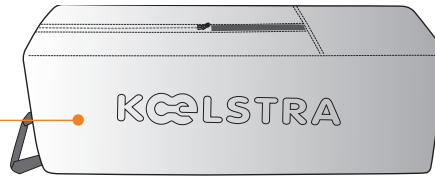

Castors/Supports

Velcro fastening (4x)

Slits for fastening the mattress (4x)

Velcro fastening bottom (2x)

Central lock

Castors/Supports

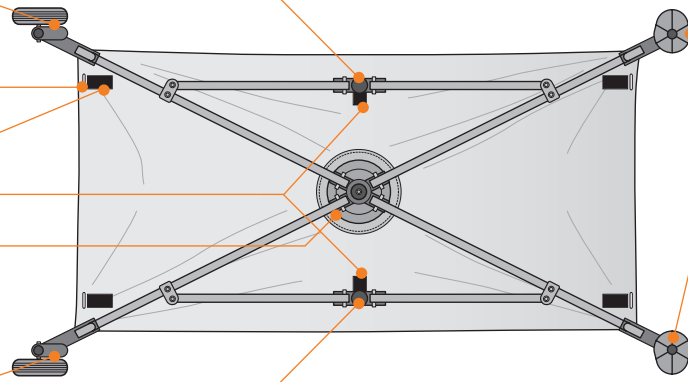

Feet

Frame lock

Corner piece

Press-stud

Zip

Crawling hatch

Castors

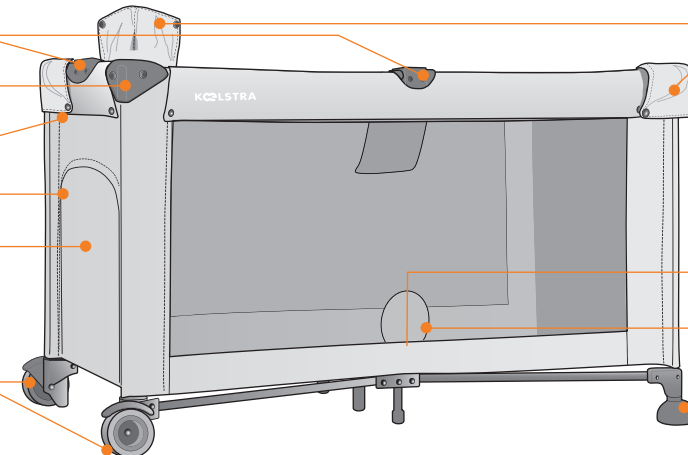

Corner protector

Central Lock

Cover flap

Feet

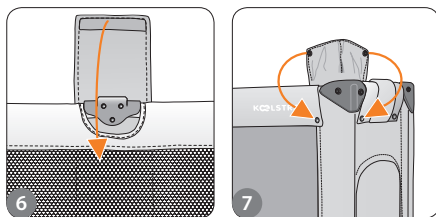
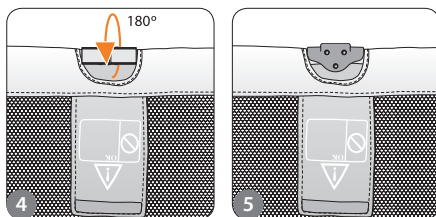
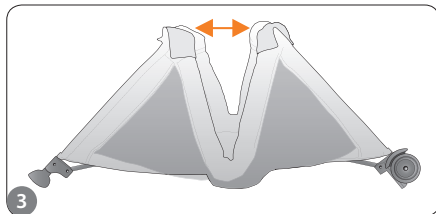
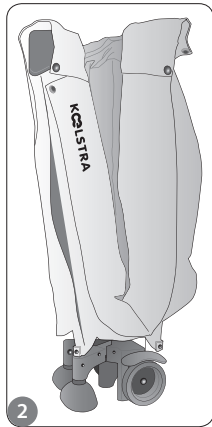
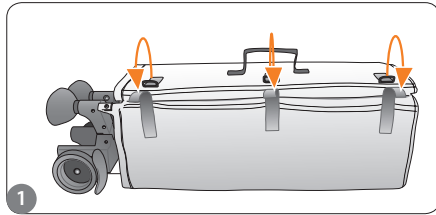

1 Unpacking and assembling the product

1.1 Before using it for the first time

- ⚠ Danger, risk of serious injury or death!
 - Keep plastic packaging materials away from children as they can present a choking hazard for children.
 - Beware of small parts. Your child may swallow a small part and choke.
 - Remove all objects from the travel cot (such as pillows and soft toys) which could cause strangulation or choking hazards.

⚠ Warning!

- Before use, check your product for any damage, loose or missing parts, sharp edges and/or protruding parts.
- Never exceed the maximum allowed weight for the travel cot (see p. 13 'technical specifications').

⚠ Caution!

- To prevent damage to the travel cot, do not remove logos or stickers. Some logos and stickers are required by law.

💡 Tip

- For environmental reasons we recommend that you discard the packaging at your local civic amenity site.

The travel cot is packed away

1. Remove the folded travel cot that is packed in the travel bag, from the box.
2. Remove all packaging materials and discard immediately.
3. Use the product description to check if the travel cot is complete (see p. 7).

1.2 Unfolding the travel cot

⚠ Warning!

- Beware of any moving parts or hinges when unfolding, folding or adjusting the travel cot. Beware of getting your fingers or hands, or your child's fingers or hands jammed.

⚠ Caution!

- To avoid danger of fingers becoming jammed or the travel cot suddenly folding, check that all the locks are securely engaged each time before use.
- Check each time before use whether all the corner pieces and locks are covered by the cover flaps.
- Check that the zips and press-studs are properly closed and/or attached.

The travel cot is folded.

Untie the mattress from the package:

1. Remove the travel cot from the travel bag.
2. Lay down the package in a horizontal position.
3. Open the three Velcro mattress (see fig. 1).
4. Lay the mattress aside for now.

Assembling the travel cot:

⚠ Caution!

- When assembling the travel cot it is very important that you **first** set up all the edges and only **then** push the central lock towards the floor. **If you do not adhere to the sequence below, you may (permanently) damage the product.**

A. Set up the edges of the cot

1. Position the folded package in a vertical position (see fig. 2).
2. Gently separate the four legs slightly (see fig. 3).
3. Pull one edge of the cot upwards to form a straight horizontal line (the side of the travel cot is now taut, see fig. 4).
4. Rotate the frame lock on the edge of the travel cot 180 degrees around its axis towards the inside of the travel cot so it can be locked (see fig. 5). **Attention:** The frame lock must be rotated at an angle of 180 degrees, otherwise the lock is not correctly secured and the travel cot may suddenly fold.
5. Repeat the two above steps until all four edges of the travel cot have been secured.
6. Fold the four cover flaps over the frame locks and attach the Velcro (see fig. 6).
7. Fold the four corner cover flaps over the corner pieces and attach the Velcro and fasten the press-studs (see fig. 7).

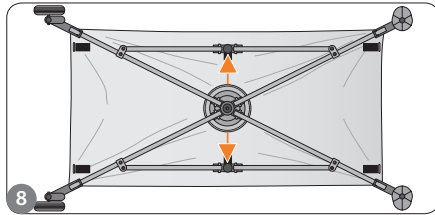

B. Locking the central lock

- Push the central lock down towards the floor until the bottom is taut.

Bottom attachments:

Check that the two Velcro attachments on the bottom of the travel cot are attached to the relevant hooks on the frame (see fig. 8).

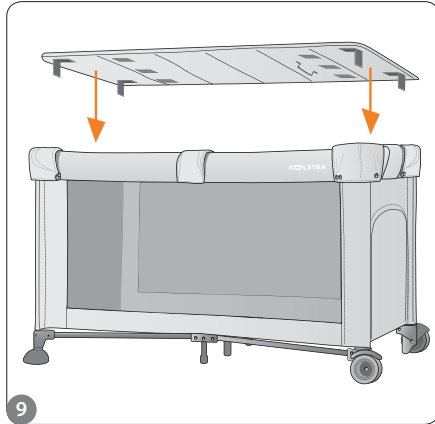

1.3 Positioning the mattress

- ⚠️ Danger, risk of serious injury or death!**
- The maximum allowed thickness of the mattress is 3 cm (centimetres).
- Never place an extra mattress on top of the mattress supplied.
- Check that the mattress has been attached correctly and is completely flat. A detached mattress can present a risk of suffocation.

⚠️ Warning!

- Only use a mattress supplied by Koelstra.

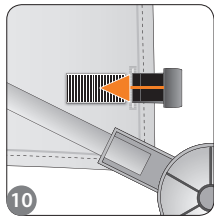

The travel cot is unfolded.

- Position the mattress so that the carry handle is facing downwards in the travel cot (see fig. 9).
- Push the strips of Velcro on the corners of the bottom of the mattress through the relevant slits in the bottom of the travel cot (see fig. 10).
- Attach the Velcro to the bottom of the travel cot.
- Repeat the above steps for all four corners of the mattress.

1.4 Zip-up crawling hatch

⚠️ Warning!

- Make sure the crawling hatch is completely closed when your child is put in the travel cot for a rest.
- Never leave your child in the travel cot unsupervised when the crawling hatch is partially or completely open.

⚠️ Attention!

- The zip fastening is on the outside of the travel cot to prevent your child from opening the crawling hatch.



- The crawling hatch is not for babies, only for bigger children.

Only open the crawling hatch when you are there to supervise. Your child can then crawl out of the travel cot by itself (see fig. 11).

2 Moving/positioning the travel cot

2.1 Positioning the travel cot

⚠️ Danger, risk of serious injury or death!

- Never place the travel cot near heaters, open fire or other sources of heat as this could pose a fire hazard.
- Keep the travel cot away from loose leads, wires and cables in case of falling objects, strangulation or choking hazards.

⚠️ Warning!

- Never put more than one child in the travel cot, the maximum load is 18 kg.
- Make sure your child cannot climb over the edge of the travel cot. This can cause the travel cot to become unstable and it may tip over, causing your child to become (seriously) hurt.
- Remove all objects around the travel cot that may be within your child's reach and that may cause a dangerous situation (such as white spirit or matches).
- Remove all objects around the travel cot that your child might use to pull itself up from.
- Remove all objects from the travel cot that may help your child to climb out of bed.
- Aluminium, metal and synthetic parts can become very hot in the sun. Make sure your child cannot burn itself on any hot parts.

⚠️ Caution!

- Never place the travel cot in the sun for prolonged periods of time. The fabric can discolour and plastic parts can be damaged.
Koelstra fabrics are of the highest UV protection category.

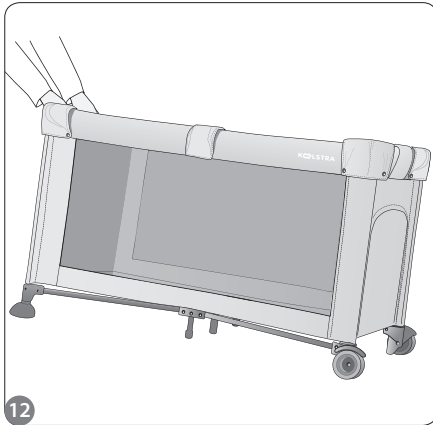

⚠ Attention!

- Do not attach any toys to the travel cot with a cord.

Place the travel cot on a level, stable floor.

2.2 Moving the travel cot

⚠ Warning!

- Use the correct posture when moving the travel cot. Keep your back straight and slightly bend your knees.
- Never lift or move the travel cot with your child standing, sitting or lying in it.

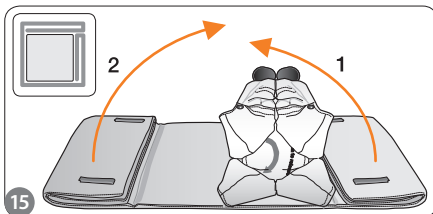
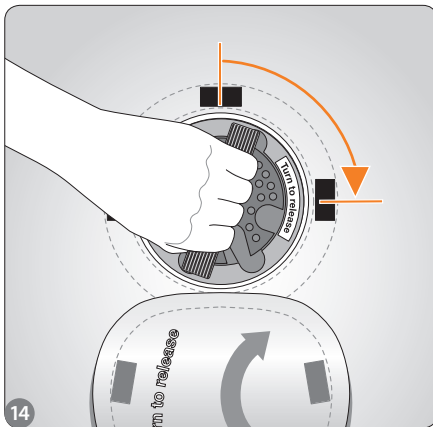
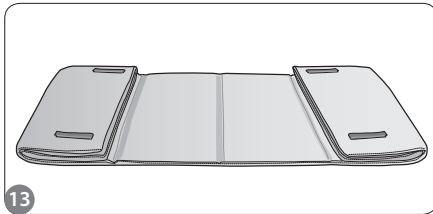

1. Take hold of the travel cot by the short edge of the bed on the side of the feet.
2. Lift up this side of the travel cot until you feel that the wheels can touch the floor and move freely (see fig. 12).
3. Hold the travel cot in this position and roll it to the desired location.

3 Transporting and storing the travel cot

⚠ Warning!

- Use the correct posture when transporting the travel cot. Keep your back straight and slightly bend your knees.

⚠ Caution!

- Transport the travel cot carefully. The frame and the fabric can be damaged if you bump or scrape it.

3.1 Folding up the travel cot

⚠ Attention!

- Always store folded products away from children.

The travel cot is unfolded.

1. Remove all the cover flaps from the frame locks.
2. Remove all the corner cover flaps from the corner pieces.

Attention: To avoid the corner cover flaps from jamming when folding the travel cot, completely pull away the Velcro.

Unlocking the central lock:

1. Undo the Velcro fastenings of the mattress from the bottom of the travel cot.
2. Remove the mattress from the travel cot and lay it down on a flat surface (see fig. 13).
3. Rotate the central lock a quarter of a turn in the direction of the arrow to unlock it, and pull it in an upward motion (see fig. 14).
4. Keep the central lock in this position.

Caution: When folding up the travel cot it is very important that you first turn the central lock a quarter of a turn to the right, pull it upwards and hold it there and then fold the travel cot. If you do not adhere to the sequence below, you may (permanently) damage the product.

Folding up the travel cot:

1. Rotate all the frame locks 180 degrees around their axis towards the outside of the travel cot.
2. Push all corner pieces as tightly as possible against the central lock you are holding up, thus creating a small package.
3. Put the package horizontally on the mattress as shown in figure 15.

Tip: Make sure the mattress is positioned as far as possible towards the top of the travel cot. The wheels must remain clearly visible.

4. Fold the mattress around the travel cot (see fig. 15).
5. Attach the three Velcro fastenings tightly onto the mattress.

4 Maintenance

4.1 General

⚠ Attention!

- Only use Teflon spray or silicon spray for lubricating the moving parts. Never use oil, grease or other lubricants as these attract dirt and dust.

💡 Tip

- If your product has been involved in an accident, please pay a visit to your Koelstra dealer to have the it checked for any technical faults.

- Lubricate the moving parts regularly. This will prolong the life of your travel cot.
- Regularly check that all the parts of your travel cot are functioning properly.

4.2 Cleaning the travel cot

⚠ Caution!

- Do not bleach or dry clean the fabric.
- Clean the travel cot immediately after it has been used in a sandy and/or salty environment (for example at the seaside). Sand can damage moving parts and/or the locking devices. Salt will cause metal parts to rust.
- If wet, dry the unfolded fabric in a dark room to prevent it from discolouring.

💡 Tip

- Stains can be removed using a mild detergent or soap stick.

General:

- Use a damp cloth to clean stains on the fabric.
- Dry the travel cot with a soft cloth after cleaning.

3.2 Storing the travel cot

⚠ Caution!

- To avoid any damage, do not place any objects on or against the folded product.

💡 Tip

- When folded, the travel cot can be stored in a vertical position. This will save space.

The travel cot is folded.

1. Lay the package on the floor horizontally.

Tip: Check that the handle on the mattress is on the side where the feet of the folded travel cot are located (see fig. 17)..

2. Pull the bottom of the travel bag over the undercarriage of the travel cot.

Tip: The wheels will fit through the largest holes, the feet through the smaller holes (see fig. 16).

3. Position the package vertically.
4. Pull the travel bag up around the package and zip it up.
5. Pull the handle through the hole in the travel bag, specially made for that purpose.

3.3 Transporting the travel cot

⚠ Caution!

- The travel cot must always be transported in the travel bag. This is to protect the travel cot.

The travel cot can be transported in two ways.

By carrying the travel cot:

Lift up the package by the handle attached to the mattress (see fig. 17).

Rolling the travel cot:

1. Position the package upright with the handle on the travel bag and the wheels positioned towards you.
2. Just pull the package along behind you (see fig. 18).

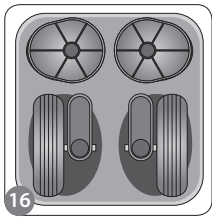

16

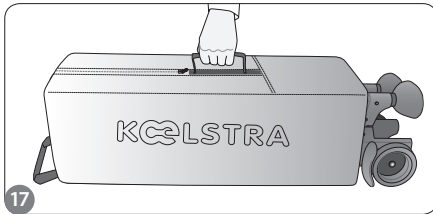

17



18

4.3 Faults

⚠ Warning!

- To avoid dangerous situations and further damage, never use a faulty travel cot.
- Immediately replace faulty parts. Always have this done by an authorised Koelstra dealer.
- Do not use the travel cot if the lining material is showing through the fabric.

⚠ Attention!

- Do not make any modifications to the product yourself. This is unsafe and invalidates your warranty.
- Report any faults to your Koelstra dealer.
- If any parts start to show signs of wear or become faulty, always have them replaced by an authorised Koelstra dealer.

5 Accessories

⚠ Attention!

- Only use accessories and/or parts that have been recommended and approved by Koelstra BV.

Visit our website www.koelstra.com for a complete overview of the various accessories and other Koelstra products.

5.1 Care bag (Optional)

Specifications:

- Care bag with adjustable carry strap.
- Plenty of storage with seven zippable compartments, including a thermal compartment.
- Supplied with changing mat.
- The carry strap also has a name badge and a handy hook.

6 Technical specifications

This product has been manufactured in accordance with European EN 716-1 & -2:2008 standard.

Intended age	0 to approximately 4
Max. load	18 kg
Max. number of children	1
Weight	9.8 kg
Dimensions (l x w x h): - Folded - Unfolded	22 cm x 22 cm x 75 cm 120 cm x 60 cm x 75 cm
Recommended cleaning agents for fabric	Mild detergent, soap stick
Recommended lubricants	Silicon spray, Teflon spray

7 Disposing of product and packaging

Koelstra BV develops its products in accordance with the directives of the European packaging agreement. For environmental reasons we recommend that you discard both the packaging and the product (at the end of its product life) at your local civic amenity site.

This instruction manual has been compiled with care and meets the requirements and regulations in accordance with the Netherlands (NEN) 5509 standard. However, Koelstra BV cannot be held responsible for any inaccuracies or for the completeness of the information and does not accept any responsibility for damages and/or injury of any kind, as a result of actions and/or decisions that have been based on the information in this manual.

The product purchased may differ from the product as described in the manual.

The most recent manuals can be requested from Koelstra BV. See also www.koelstra.com.

© Copyright 2010 Koelstra BV

Koelstra BV

Leitswei 6, 8401 CL Gorredijk – NL
P.O. Box 1, 8400 AA Gorredijk – NL
info@koelstra.com