

SE6

Take your sound game to the next level with the SE6 Elevated Speaker Stand. Standing at a height of 6.9", the SE6 boosts your speakers up and off the surface of your desk so that they're better aligned with your ears to give you a flawless on-axis response. Its cantilevered and angled platform is designed to absorb resonance and deliver a pure sound without any reflections from nearby surfaces. 2.5mm of silicone padding provide a strong grip that helps keep your speakers and stand in-place. For maximum protection, the SE6 comes with a set of mounting screws that you can use to secure compatible speakers to the stand to prevent falls and accidents. The SE6 is available in both black and white and can hold up to 22 lbs.



FEATURES & SPECIFICATIONS

- Elevated design for Large desktop or bookshelf speakers
- Perfect for Kanto YU6's, TUK, YU Passive 5.25" or similarly sized speakers
- Built out of solid steel with a painted finish
- Silicone pads to reduce vibration and provide grip
- Mounting hole and 1/4"-20 screw allow for securing compatible speakers in place
- Supports speakers weighing up to 22 lb (10 kg)
- Speaker resting surface measures 5.3" wide by 7.4" deep
- Sold as a pair
- Gift box dimensions: 9.6" x 7.0" x 7.6" (24.5 x 17.7 x 19.2 cm)
- Product dimensions: 8.8" x 6.9" x 6.9" (22.4 x 17.5 x 17.5 cm)
- Product weight: 8.2 lb (3.7 kg)
- UPC: 800152720777 - SE6
- UPC: 800152720784 - SE6W

COLORS

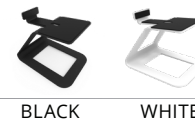

BLACK

WHITE

TECHNICAL ILLUSTRATIONS

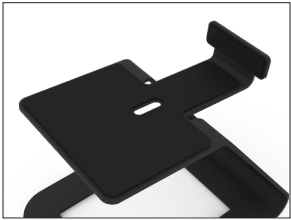

STELLAR SOUND QUALITY

The SE6's cantilevered design and 2.5mm silicone padding absorbs resonance from the speaker cabinet to produce a clean, distortion-free sound. Use the included mounting screws to couple the speaker and stand together to increase the mass of your set-up and further reduce resonance.



ACCURATE, ON-AXIS OUTPUT

Elevate and align your speakers with your ears so that you can enjoy flawless on-axis sound and prevent reflection from nearby surfaces.



SAFE AND SECURE

2.5mm of silicone speaker dampening offer a high grip to keep your speakers and stand firmly in-place. Mounting screws are included to help you further secure compatible speakers to the stand.



RECLAIM YOUR WORKSPACE

SE6's clean, clutter-free design is built so that you can place extra items directly below the speakers, maximizing the utility of your desk surface and using the space normally taken up by traditional speakers.



MINIMALIST DESIGN

Who says functional can't be beautiful? The SE6 stand boasts a minimal design that matches the style and colour of other Kanto accessories for a clean, consistent look. Available in a black or white finish.

