

# Video Smart Pet Feeder

## Quick Operation Guide

Please read the quick instructions carefully when using the product



**Packing List**  
After opening the package, please make sure that the pet feeder is in good condition, Please check the list to see if the accessories are complete.  
Feeder machine X1  
Power cable X1, Quick operation guider X1

### First use

- 01 Open the top of the feeder and take out the cord adapter of the food barrel.
- 02 Plug the power cord into the power interface below the host and connect the adapter for power.
- 03 Place the host at a horizontal position and install the food plate at the corresponding position of the host
- 04 Add pet food to the feeder bucket
- 05 The desiccant is put in the dryer box by default, and it should be replaced regularly after long-term use (Clean up when it is not in use).
- 06 Three D size batteries can be installed in the battery compartment for manual feeding when there is no power (optional)
- 07 Bind the feeder to the APP, and you can set the feeding and planning for your pet

### Button Function Description

**RESET button:** Mode switch/ RESET 1. Long press 10 seconds to make two "ding dong" sound to restore factory settings in both connected and locked states, 2. Long press 10 seconds to make two "ding dong" sound and switch into distribution network mode(Quick configuration/hot configuration)

**Microphone button:** Long press and sound a beep to start recording, release and make two "beep" sounds to end and play the recording. Recording duration can be up to 10 seconds

**Feed Button:** Short press and feed the food, long press the red indicator light for 10 seconds to lock the device, then press the red indicator again for 10 seconds and flash twice to unlock, it cannot be set in the locked state.

### Status Indicator Light instructions

- Red light:Flashing when lock/unlock/ mode switch
- The blue light (signal indicator) is always on means working normally, Flashing quickly means waiting for network distribution.

### APP Binding

Scan the QR code to download the APP and complete the installation.



### Product Appearance Introduction

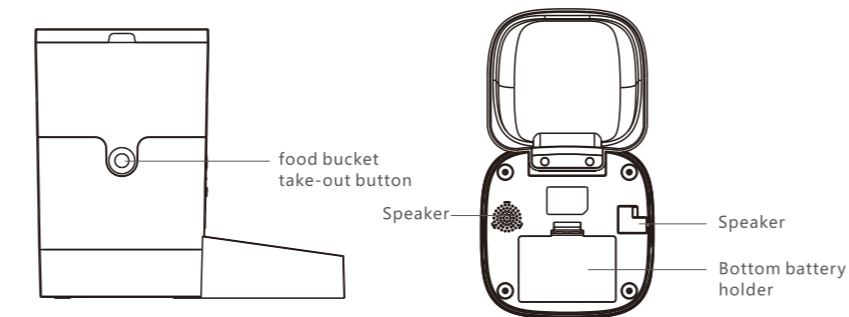
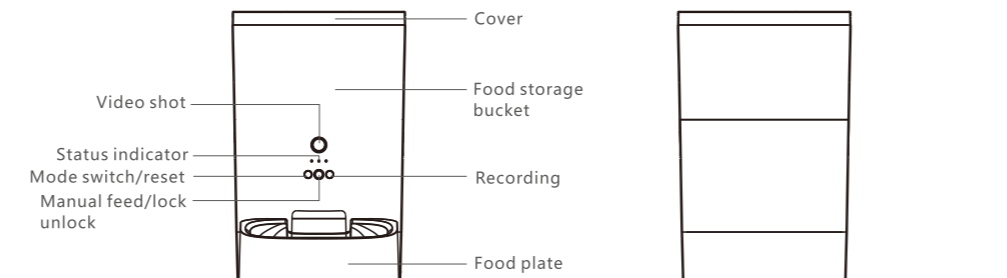

### How to use App Tuya Smart" App Operation steps

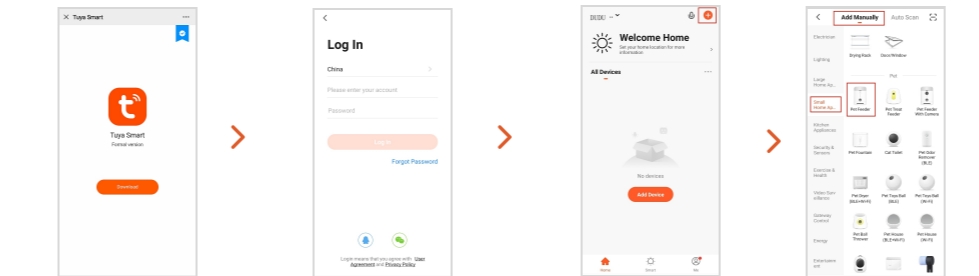

01 Download "Tuya Smart" App

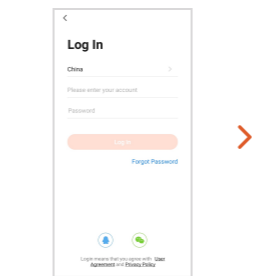

02 Register an account and sign in

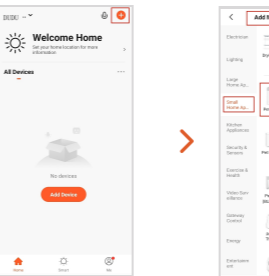

03 Click "Add Device" or "+" on the top right corner

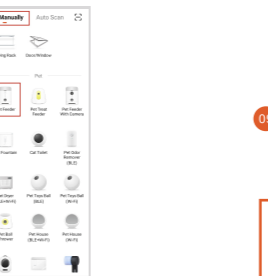

04 Add Manually - Small Home Appliances - Pet Feeder

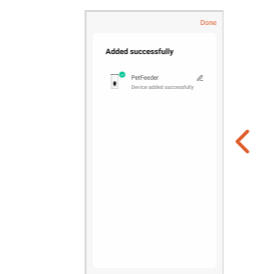

06 Add feeder successfully - Complete - Customized the name of the feeder

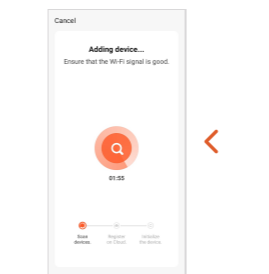

07 Waiting for network distribution.

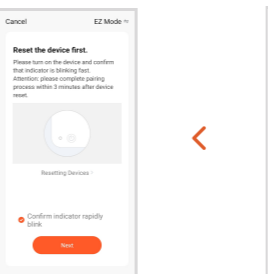

08 Confirm the indicator light is flashing, and then go to next step

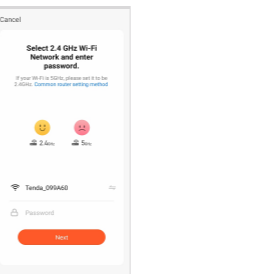

05 Enter Wifi name and Password (Note: the password does not have special symbols and does not support SGWIFI)

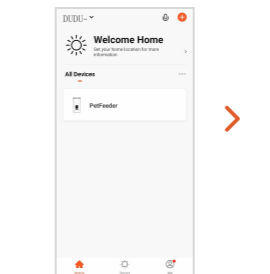

09 Click the feeder icon to enter the operation interface

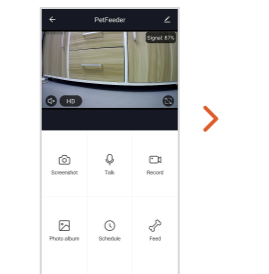

10 Click the Schedule icon to set the feeding schedule

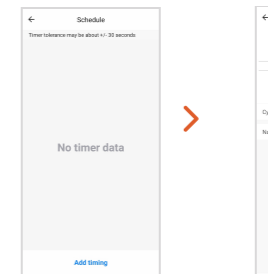

11 Click "Add timing" to set the feeding time and number of meals

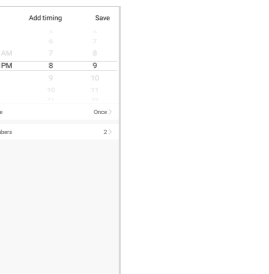

12 Chosen the time, Repeat to the day and choose portions of per meals

### Feeder Interface function

- Speaker: Turn on and you can hear the feeder sound.
- HD/STANDARD definition: Video definition can be selected according to the network speed.
- Full screen: Click to watch the video in full screen.
- Photograph: Take pictures of your pet and save them in your phone album
- Microphone: Click the icon to turn blue, you can talk with your pet through the phone.
- Recording: Record pet videos and save phone photo albums.
- Playback: Playback is not supported on this device.
- Regular feeding: Set a daily feeding time and amount for your pet.
- Feeding: Feed your pet by hand
- Alarm: This device does not support the alarm function
- Cloud video playback: This function is a fee-based service.
- Setting options: device name, shared device, device information basic function settings, motion detection settings common problem and feedback, firmware information.

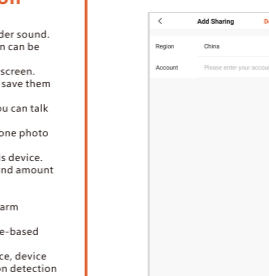

14 Add sharing and link accounts (become family members only after linking)

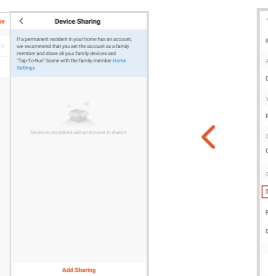

15 Click the step 10 at the top to access settings - Shares Device (Share with multiple people to operate the feeder)

### Cleaning And Maintenance

After the feeder has been used for a certain period of time, the food plate and bucket should be cleaned with detergent, so as not to affect the health of pets due to the bacteria caused by food residues left too long.

### Video Smart Pet Feeder Common Troubleshooting

- Question 1:** The pet feeder is unresponsive when it is electrified  
**Answer:** Check whether the device is properly plugged in. The electrical outlet in your home is out of contact so that the product is not energized. Whether the power supply or the power cord is properly plugged in (you can replace the normal 5-volt mobile phone charger at home or install 3 D-size batteries to test)
- Question 2:** APP prompts that 2.4GWIFI network is only supported, please select again, or the configuration is unsuccessful for many times  
**Answer:** Feeders do not support 5GWIFI. If it is a dual-band router, please go inside the router to turn off the 5GWIFI signal. If the mobile phone has a router management APP, you can directly enter the management software to turn off 5GWIFI. If there is no management software, please input the IP address of the router in the mobile phone or computer browser, which is generally 192.168.1.1 or 192.168.0.1. Enter the router password to enter, find the wireless settings, turn off 5GWIFI. After saving and restarting the router, reconfigure the feeder. After setting up the feeder, 5G WIFI can be restarted.

- Question 3:** The network connection is unsuccessful  
**Answer:** a. The distance between the feeder and the router is less than 10 meters (It is most stable in a room), the router's WIFI signal attenuates so far that the feeder is often offline. b. Restart the router and feeder. c. Router compatibility is poor, and the router should be reconfigured after replacement. d. Go to router Settings. (Enter the ROUTER IP address, which is generally 192.168.1.1 or 192.168.0.1 in a mobile phone or computer browser, and then enter the router password.) Find the wireless setting and wireless channel, Change the channel to 7 or 11, or try another channel. Reduce interference from surrounding wifi and improve compatibility.
- Question 4:** The pet feeders are often offline.

- Problem 5:** There is no food or pet feeder doesn't feed food or the food is stuck.  
**Answer:** a. The food bucket runs out of food, resulting in no food falling down. b. The pick in the food bucket has come loose so that the food can't be pulled down. Just put the picks in the container. c. The food bucket is not in alignment resulting the motor or below is filling. d. Food particles are too large, or the surface is rough and oily, resulting in food caking. If the pick can not go down then you can put less food. f. there are too many food piled up in the outlet aisle, which will fall off after pet eating. Reduce the number of meals at feeding time. g. Clean the feeder, feeder food bucket and Food residue inside the device with a dry cloth.

### Attentions

- Please place the equipment correctly to turn over the equipment. This equipment is only suitable for small and medium-sized pets under 20kg.
- Please replace the desiccant in the lid of the storage bucket regularly, there is no desiccant and no need to be treated.
- Please keep the food bucket dry and sealed, and check regularly to make sure there is no food residue.
- Do not drop all the substances other than dry food into the food bucket, otherwise it will cause abnormal use of equipment and even cause pet safety problems.
- To prevent pets from falling down the product, it is recommended to place it in a corner or against a wall.
- The anti-biting wire of the product should be installed in a concealed way to avoid damage to the equipment caused by pets' biting wires.
- If children use this device, be sure to use it under adult supervision.
- Manual operation of the equipment after the installation of a spare dry battery to provide normal power supply function in case of power failure.
- It is not recommended to use this device for infants within three months.