

PET WATER FOUNTAIN
USER MANUAL V1.5w
F-016

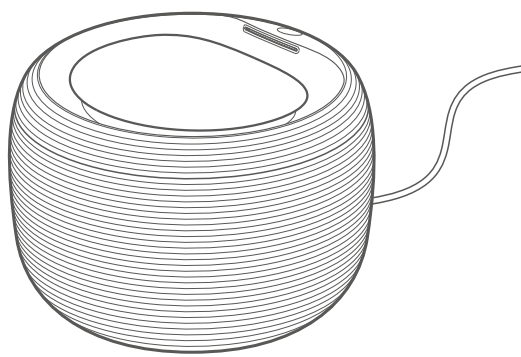

NOTICE Please Read The User Manual Carefully Before Use and Keep It in A Safe Place!

Please Page Right



Designed and manufactured in China

Contents

Important Safety Information	1 2 3
What's in The Box	4
Learn About Your Fountain	5 6 7
How The Fountain Works	8
How to Use	9 10 11 12
How to Clean	13 14 15
Precautions	16
FAQ	17
Terms of Use & Limitation of Liability	18
Certification Statements	19 20 21
Specifications	21

Important Safety Information

Safety Instructions for This Product

WARNING This equipment is not recommended for pets under 3 months old.	
CAUTION Please use the original USB power cable, otherwise it will damage the device or cause safety hazards. This product is a low-voltage product, but pets biting on the cable will still cause electrical leakage. Please guide your pets properly. If the water in the product is not consumed for a long time, the water must be changed in time. Please make sure the pet's drinking water is clean, non-toxic and harmless.	
CAUTION Keep it level and do not knock over the product, otherwise it will cause the equipment to malfunction or spill water.	

What's in The Box

Components

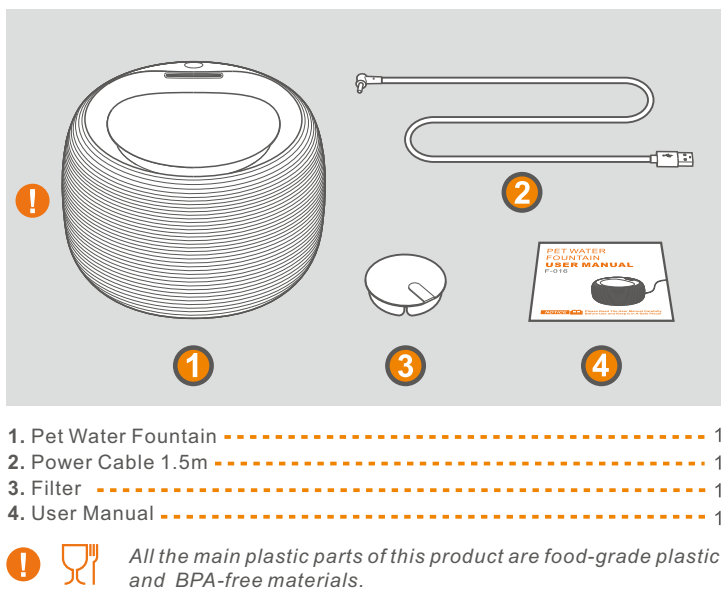

1. Pet Water Fountain
2. Power Cable 1.5m
3. Filter
4. User Manual
- All the main plastic parts of this product are food-grade plastic and BPA-free materials.

Learn about Your Fountain

Features



How The Fountain Works

The Basic Principles of Purification

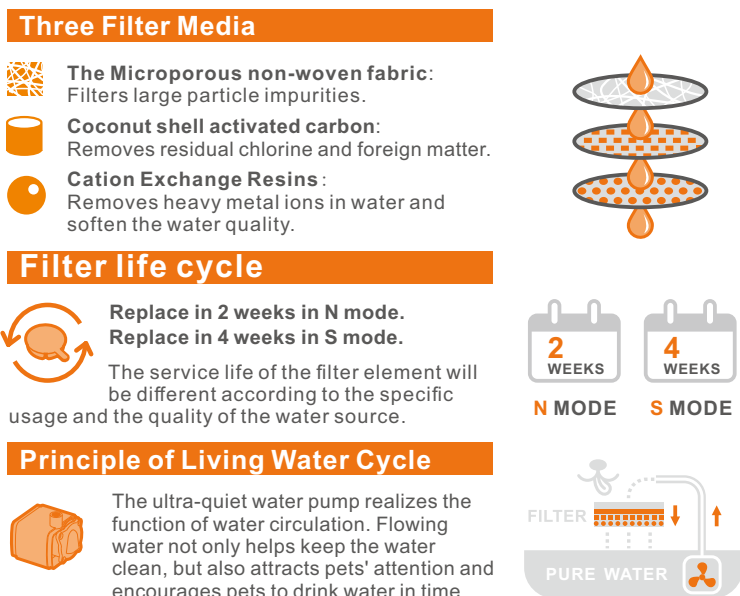

Important Safety Information

Explanation of Attention Words and Symbols

WARNING	WARNING indicates a hazardous situation which, if not avoided, could result in death or serious injury.
CAUTION	CAUTION, used with the safety alert symbol, indicates a hazardous situation which, if not avoided, could result in minor or moderate injury.
CAUTION	CAUTION, without the safety alert symbol, is used to address practices not related to personal injury.
NOTICE	NOTICE is used to address practices not related to personal injury.
PROHIBITED	PROHIBITED indicates that the operation is prohibited.
EXCLAMATION MARK	EXCLAMATION MARK indicates some information that requires additional attention.

Important Safety Information

Safety Instructions for This Product

CAUTION This product can only filter drinking water, please do not place other pet beverage products or other non-pure water liquids in the fountain. Please use this product in an indoor environment. When the product contains water, the indoor ambient temperature cannot be lower than 0°C (33.8°F). Otherwise, freezing will damage the product.	
NOTICE This product is forbidden to be washed in a dishwasher. When not using the product for a long time, please unplug the power supply, empty the water in the bucket, and store it properly. In order to provide better products, we regularly carry out product improvements. The actual product may be different from the package picture. Please refer to the actual product.	

Learn about Your Fountain

Introduction of Components

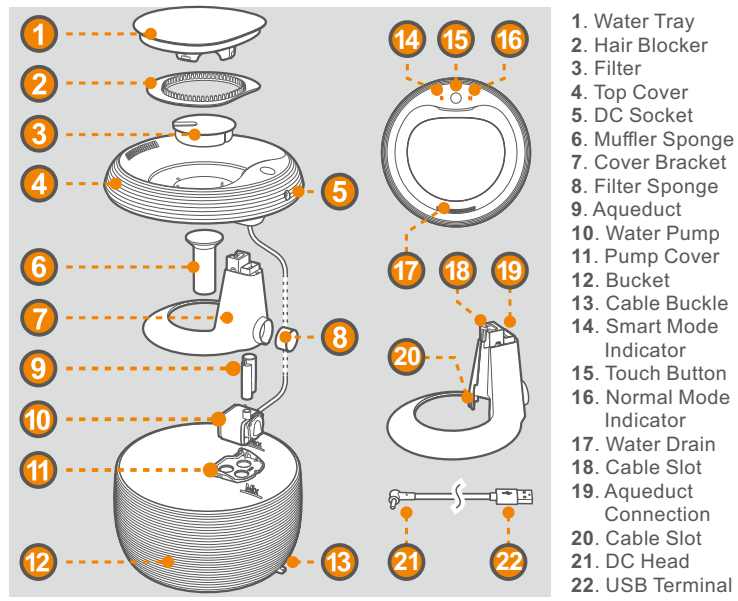

Learn about Your Fountain

Introduction of Main Features

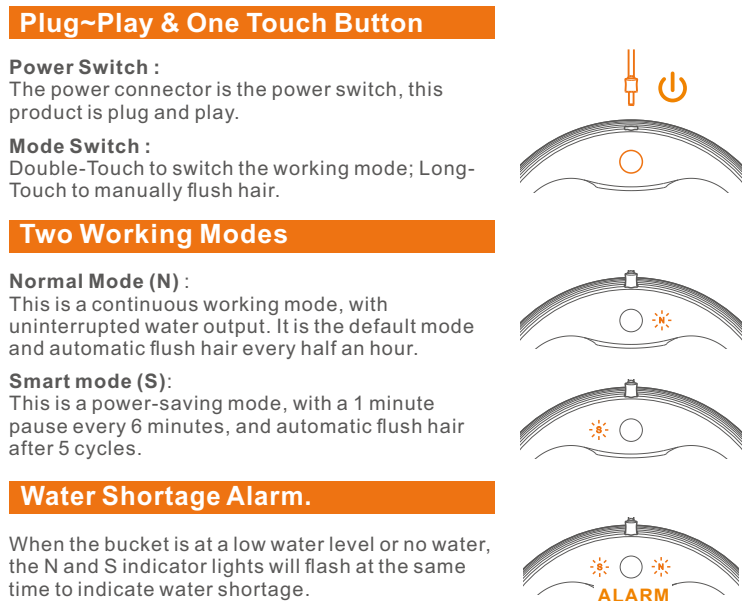

How to Use

Unpacking and Assembly

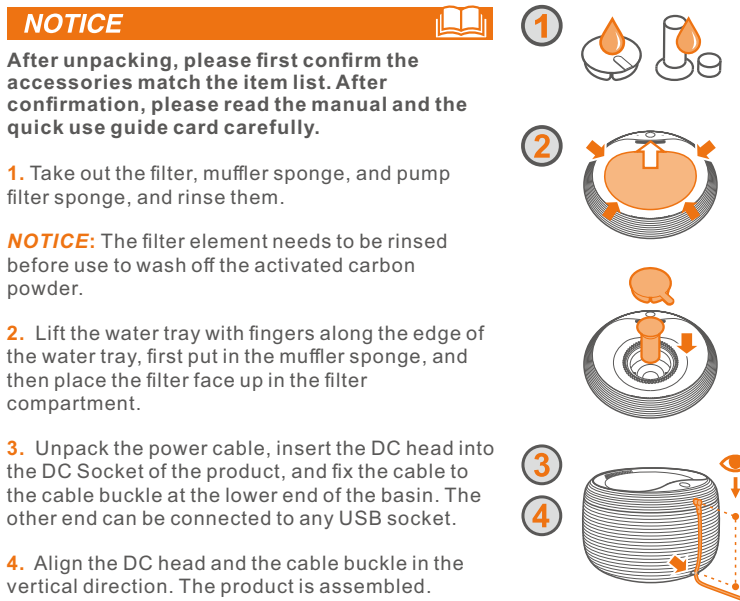

How to Use

First Use & Water Collecting

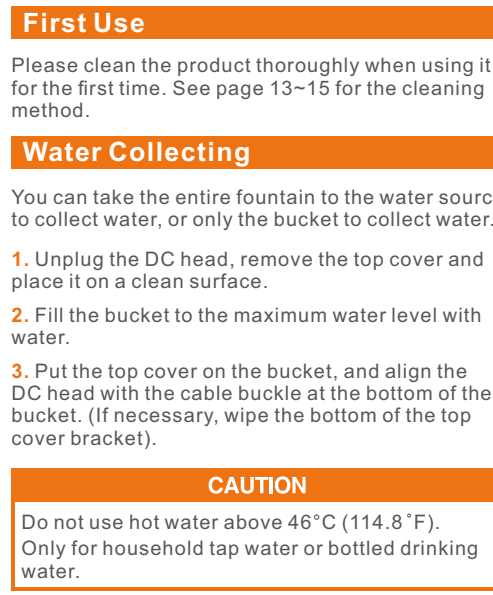

How to Use

Operations

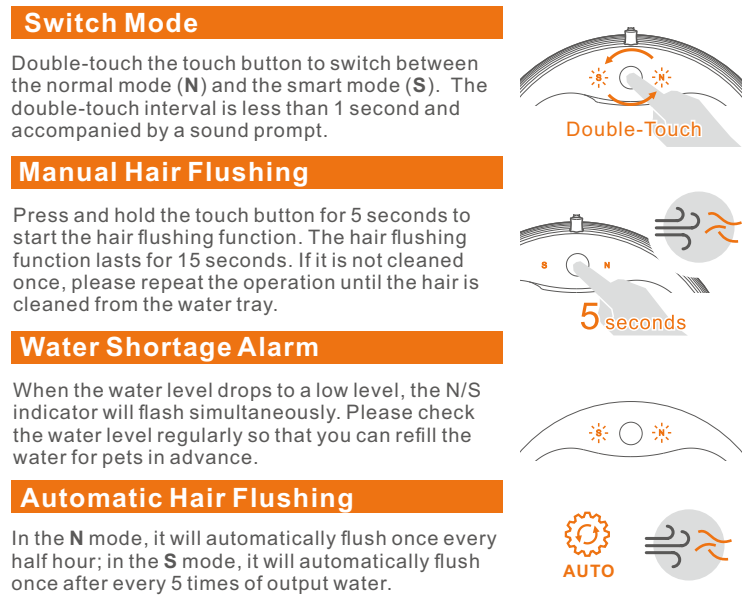

How to Clean

Disassemble Parts for Full Cleaning

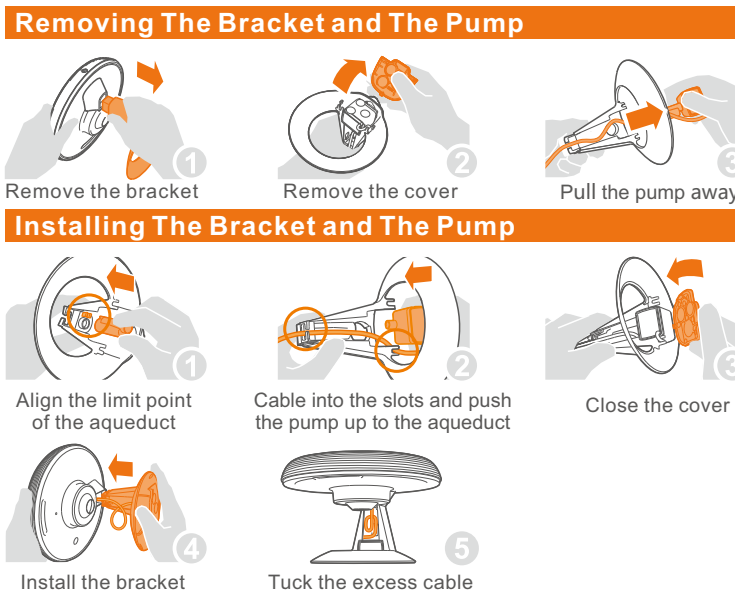

Precautions

More things you need to pay attention to.



Terms of Use & Limitation of Liability

Terms of Use & Limitation of Liability



Certification Statements

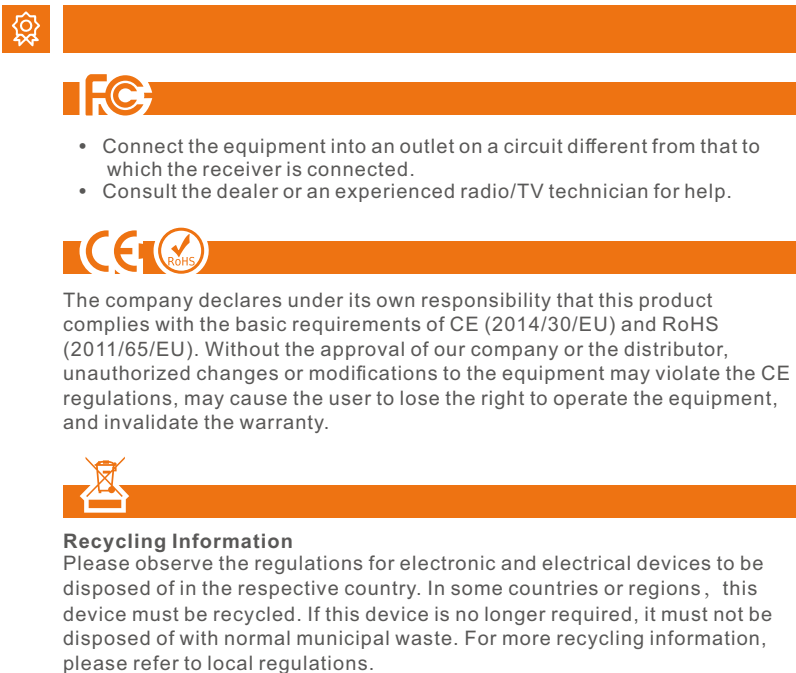

How to Use

Operations

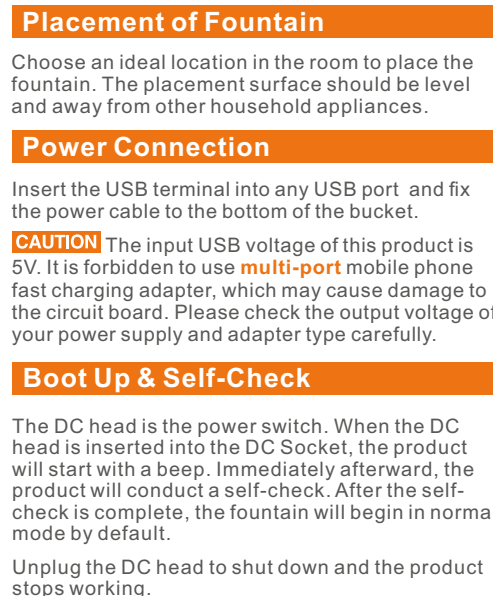

How to Clean

Cleaning and Maintenance

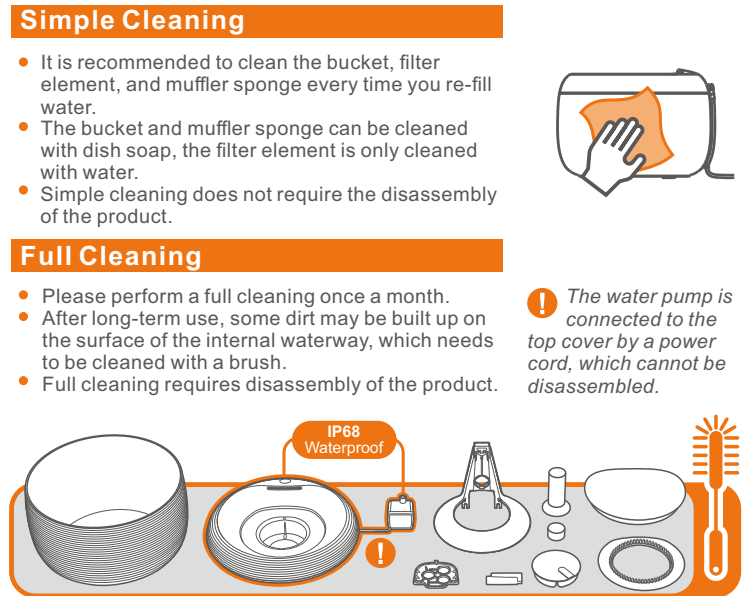

How to Clean

Maintenance of The Pump

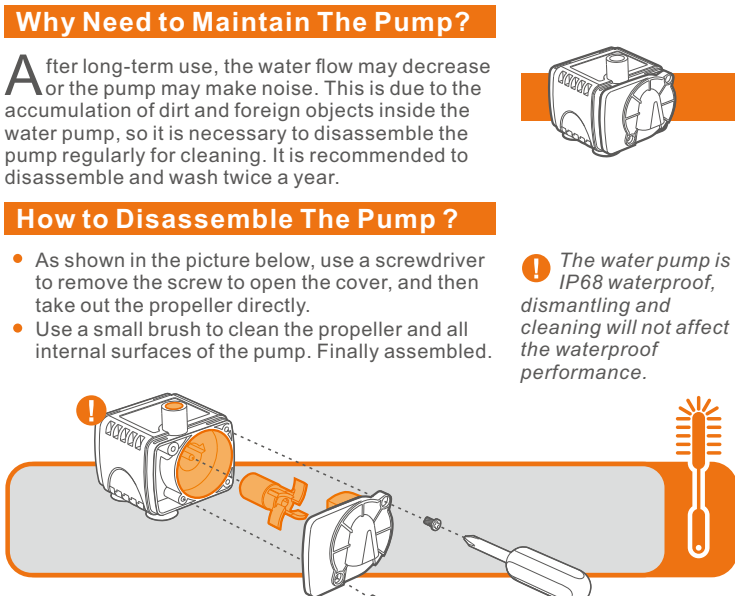

FAQ

FAQ

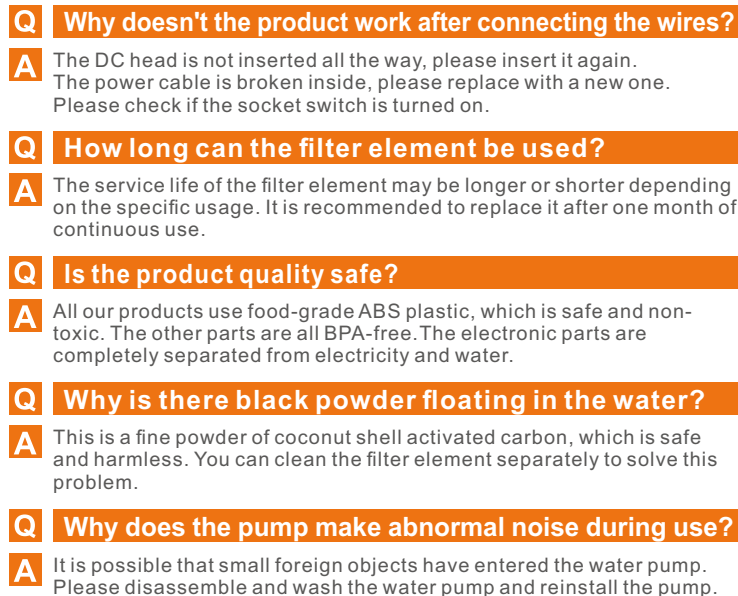

Certification Statements

Specifications

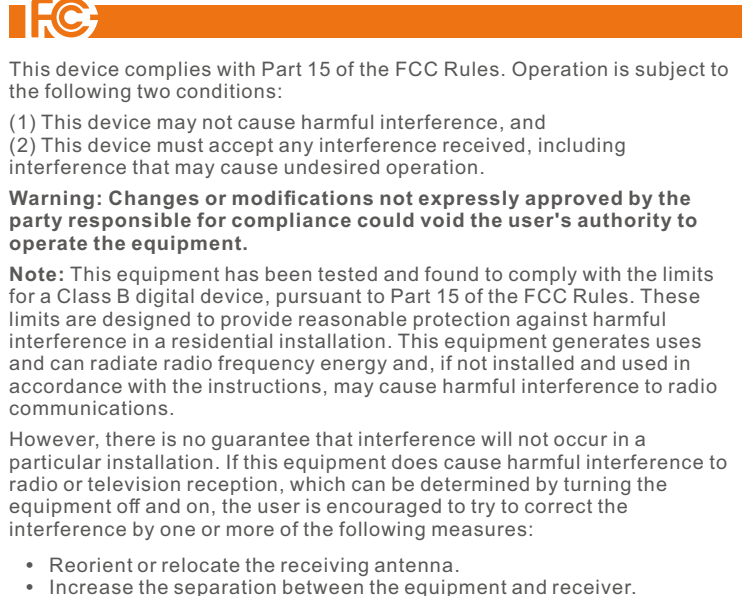

Certification Statements & Specifications

