

# W3英文说明书文件

尺寸:100X100mm

材质:80g书纸

工艺:四色印刷

备注:两折正反面

100mm

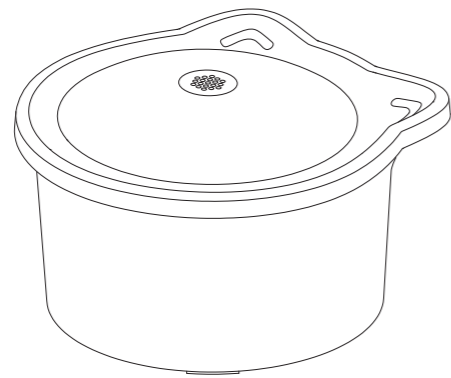

## User Manual

Pet Water Fountain

100mm

### Product Glance

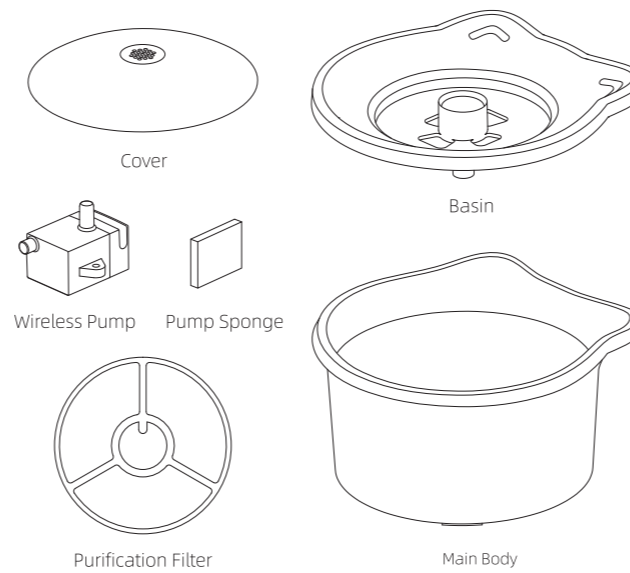

### Assemble Your Fountain

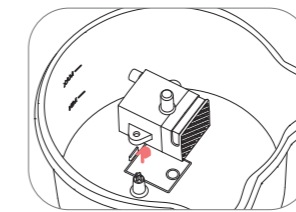

① Place the pump in designed location as the figure.

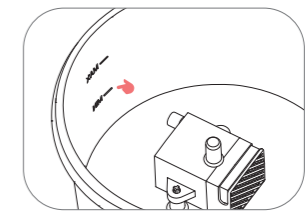

② Add water as needed. Water level should be always above the "MIN" water line indicated on the main body.

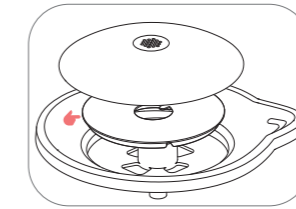

③ Place the filter in the basin and install the top cover.

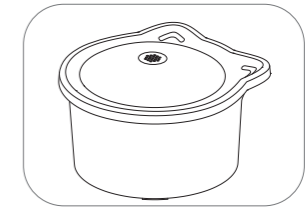

④ Make sure your hands and plugs are dry before plug in the fountain.

### Fountain Specifications

Item No.	W3
Dimension	182X181X114mm
Material	ABS
Net Weight	475g
Capacity	1.1L
Power Supply	5V 1A USB Cable

### Pump Cleaning

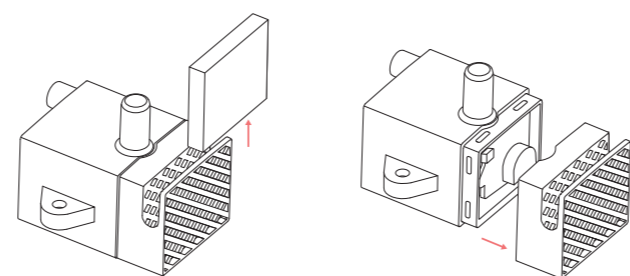

① Take out the pump sponge.

② Squeeze on either side of the intake plate and pull off.

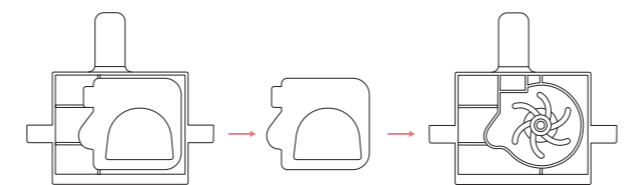

③ Remove the stator by placing your finger nail under the small lip.

④ Lift the impeller and clean it.

### Important Safety Instruction

1. When the device is not in use, the power should be turned off.
2. The power should be turned off while cleaning the base. Ensure that it is fully dry before use.
3. Make sure the water level in the tank is between the "MIN" and "MAX" water line which is marked inside the main body.
4. When the water level is below the "MIN", the device will stop to work. Add water to restart the device.
5. Replace the Purification Filter every two to four weeks.
6. Excess impurities on the filter will reduce water quality and lower the water penetration speed. We recommend cleaning the filters each time you clean the device.
7. Rinse the filter thoroughly under cool water before placing into the filter area. Rinsing will remove a majority of the loose charcoal dust.