

## Remote Dog Trainer AT-215C

om

roups/AetertekFans

ertekFans

om/c/AetertekFans



AT-215C

# Index

System Components-----	1
Quick Start-----	2,3
Trouble Shooting-----	4,5
Training Tips-----	6
Safety Guide-----	7
Information on Terms of Use & Limitation of Liability-----	8
Warranty Card-----	9,10

# AT-215C System Components



- Transmitter

Antenna

Receiver

prongs

Test Kit

Collar

Charger

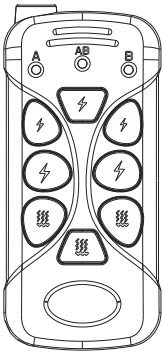

Transmitter

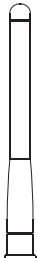

Antenna

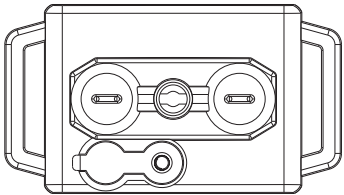

Receiver



prongs

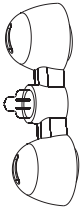

Test Kit

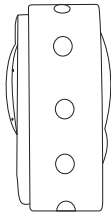

Collar



Charger

## Quick Start

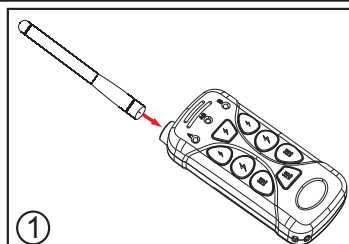

**Step 1:** Screw the antenna tightly onto the transmitter.

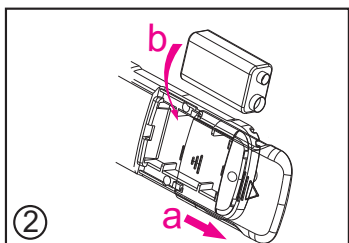

**Step 2:** Open the transmitter's battery cover, and install the 9V dry battery into the transmitter. Match the + and - on battery to the diagram inside.

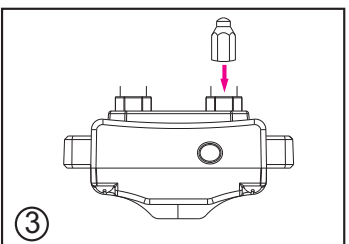

**Step 3:** Screw the metal prongs onto the receiver till the prongs are securely attached. Normally, they are assembled in the factory.

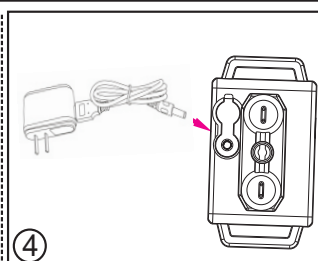

**Step 4:** Charge the receiver. The RED LED light of the receiver will be on while the receiver is charging. When the receiver is fully charged, the BLUE LED will be on. Once you unplug the charger, the RED LED light will stay solid on-waiting for sync. At the same time, the Blue LED light will go off.

**Tip 1:** It is recommend to charge the transmitter and receiver for up to 3 hours for the first 3 times.

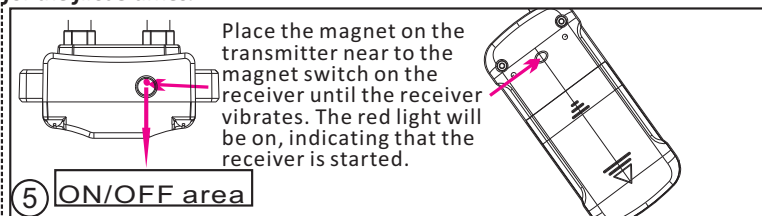

Place the magnet on the transmitter near to the magnet switch on the receiver until the receiver vibrates. The red light will be on, indicating that the receiver is started.

**Step 5:** Turn the receiver on/off. Bring the magnet on the transmitter near to the magnet switch on the receiver until the receiver vibrates. At that time, the red light will be on/off, indicating that the receiver is started/off. If you just finish charging, unplug the charger, and the receiver is on already.

**Tip 2:** To do a self-test, place the magnet on the transmitter near to the ON/OFF area on the receiver for 3 times, and the receiver will vibrate or shock with the blue light on, indicating the transmitter works normally.

## Quick Start

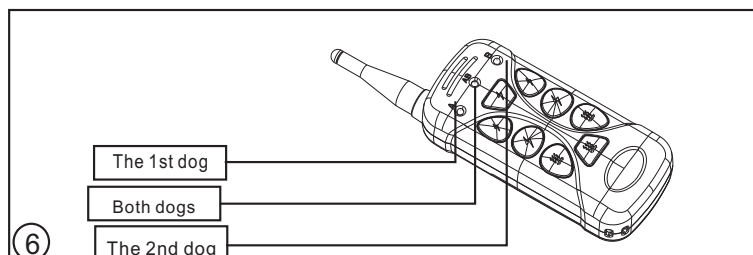

**Step 6:** Match the receiver and transmitter. Press the three buttons under dog A mode, the first receiver will be paired along with red light turns off and blue light starts flash; If you have another receiver, turn it on and press the three buttons under dog B mode, the second receiver will be paired; If you need to train 2 dogs simultaneously, press two buttons under dog AB mode, both receivers will be controlled.

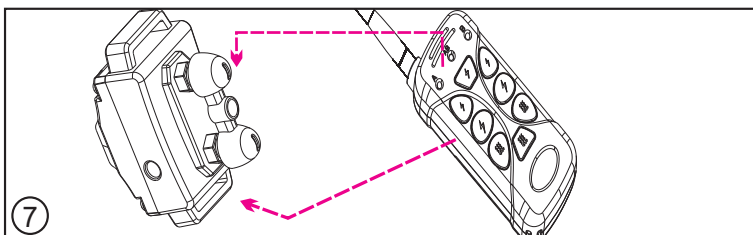

**Step 7:** Check the button functions (vibrate, shock and stronger shock). Press the Vibrate button, the receiver will vibrate. Cap the shock test kit on the metal prongs, and press the shock button. If the bulb lights up, the shock function is normal.

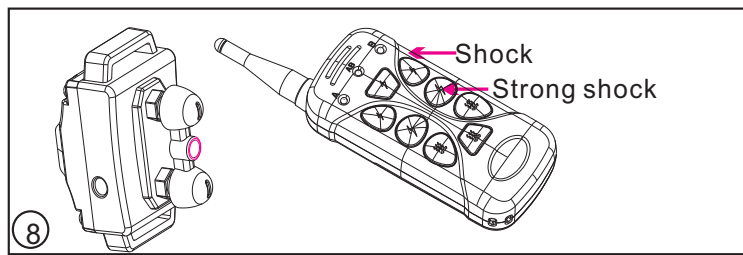

**Step 8:** Adjust shock intensity. Press the shock button will produce weaker shocking effect, while the strong shock button will produce stronger shocking effect.

**Tip 3:** The duration for pressing the vibrate or shock button will lead to difference on the length of the vibration or shock time.

**Step 9:** Start to train the dogs. Put the collar into the receiver and wear the receiver around dog's neck. Remember to leave one finger place between the collar and the neck, and then you can train the dogs.

**Tip 4:** After 3 minutes of inactivity, transmitter will go into sleep mode. You can wake it up by pressing any function keys (Vibrate or Shock button).

## Trouble Shooting

### **A : The Transmitter /Receiver runs out of batteries quickly.**

- 1 : Make sure the charger and Transmitter/Receiver are securely connected.
- 2 : Charge the Transmitter/Receiver for 3 hours or above.

### **B : The Transmitter doesn't work.**

- 1: Replace the 9v dry battery with a new one or recharge the Transmitter.
- 2: For 919C and 216C, you can check whether you can lock the transmitter. If yes, you can unlock it by pushing both buttons on the right side. Or you can push the reset button to restart your remote.

### **C : The Transmitter can't match the Receiver successfully.**

- 1 : Make sure the intensity level is not on ZERO.
- 2 : Check whether the antenna is installed correctly.
- 3 : Ensure the receiver is turned on and in sync waiting status.

### **D : The Receiver doesn't respond to the Transmitter.**

- 1 : Make sure the intensity level is not on ZERO.
- 2 : Make sure the Receiver has been synced with the Transmitter and the Transmitter is in the correct dog system. Never change the dog system after the system has been synced!
- 3 : Make sure the Receiver and Transmitter have enough power.

### **E : The training system has no effect on my dog.**

- 1 : Make sure the Receiver is working and the shocking prongs touch dog's skin closely.
- 2 : Try increasing the intensity level.

### **F : The Transmitter can't remotely control 1-2 or 1-3 Receivers.**

- 1 : Make sure you sync different Receivers separately.
- 2 : Only in the correct dog system, can you operate the corresponding receiver or dog.
- 3 : Whenever the Receiver/Transmitter is out of power and recharged, you need to sync them once again.

### **G : The training system is only available in short range.**

- 1 : Check whether the antenna is installed correctly.
- 2 : Make sure there is no strong signal interference from your surroundings. The Transmitter's control range could fluctuate subject to surroundings, obstacles, or even the weather.
- 3 : As for the AT-919, make sure the collar has been put through the antenna pole in the back side of the Receiver.



## Trouble Shooting

### **H: What is the function of the rubber cap outside the charging port?**

It prevents dust or water from coming into the charging port effectively. You need to plug the cap into the charging port tightly when charging is completed.

### **I : How to turn on/off the anti bark feature?**

For 218, press and hold on the Flashlight button, then quickly press down Beep button, and the anti bark feature will be turned off;

For 219, press and hold the microphone button for three seconds, and the anti bark feature will be turned on/off;

For 918C, press and hold on dog selection button on the side of Transmitter, and the anti bark feature will be turned on/off;

For 919C, quickly press the Flashlight button on the back side of the Transmitter, and the bark feature will be turned off;

### **J : The Receiver beeps, vibrates or shocks by itself constantly or occasionally.**

1 : Make sure the anti bark feature is turned off. For 219, the default status of the auto anti bark feature is on while that of the 218/918C/919C is off. After auto mode feature had been turned off, for 218 and 918C, the auto mode LED light will go off; for 219, auto mode icon MICROPHONE will disappear; for 919C, auto mode icon (SPEAKER) will be hollowed;

2 : Make sure the Receiver has enough power, because the Receiver will alarm when it runs out of power.

3 : Make sure any button of the Transmitter has not been touched.

4 : Sync the Receiver with the Transmitter once again.

### **K : When buying individual Receiver or Transmitter, why do I need to double-check the version?**

Aetertek updated all machine frequency from 433.92 MHz to 915 MHz, so every time you need to buy individual Receiver or Transmitter, you must know the frequency you actually need; otherwise they will not be compatible.

### **L : After you unplug charger, the red LED light in the Receiver stays in solid to wait for sync, however it can never be synced with Transmitter.**

Please turn off your Receiver and re-sync it.

### **M : My Receiver seems to work by itself without the operation of the Transmitter.**

Check whether the auto anti bark function is on. If Yes, turn it off.

### **N : The Auto anti bark feature is not working properly.**

1: Make sure the auto anti bark feature had been turned on, then you can test the function by scratching the shocking prongs on the surface of a desk, and the qualified Receiver will start to beep and vibrate.

2: Do an auto anti bark feature test on [www.aetertek.com](http://www.aetertek.com). (<http://www.aetertek.com/pages/Auto-anti-bark-feature-test.html>).



## Training Tips

This product is intended to support behavioral training and is not designed to be used without necessary interaction. Always praise your dog for good behavior. Verbal commands with positive reinforcement will contribute to success of your training and will achieve the fastest and most desirable results possible.



The recommended age for training is a minimum of 6 months, provided that dog has the attention span and capability to learn basic commands. And it should not be used on aggressive or elderly animals in poor health or animals otherwise unable to withstand the stimulus.

Use verbal commands first, and supplement with a corrective stimulus only as needed. Be consistent with your verbal commands, using the same words every time. Work with your pet on one behavior at a time to avoid confusion and frustration. Use as little stimulus as possible and only to reinforce verbal commands when necessary. Do not over correct your dog.

For example, use the beeps as warning by pressing Beep button. The dog will become conditioned to the beep preceding the corrective stimulus and will soon learn to recognize the beep as a warning along with your verbal command. Do not rely on this product solely to train your dog. Some dogs will not respond to this product. Aetertek cannot guarantee the effectiveness of this or any trainer on your dog. If your dog shows signs of growling, snarling, biting or aggression while using the collar, discontinue use immediately and contact a professional trainer for advice.



## Safety Guide



1. It is forbidden to open the receiver in case of breakage of the machine or harm the waterproof Feature; otherwise it will violate warranty rules.
  2. In order to guarantee submersible feature, the waterproof rubber charging lid should be plugged in tightly.
  3. Only use the supplied adaptor to charge the receiver, otherwise the receiver will probably be damaged.
  4. Users are NOT suggested to touch the mental prongs on the receiver, otherwise it will harm human body in case of shocking operation. To test shock correction, please use the supplied test kit.
  5. If there is water in the charging hole, please dry it before charge the receiver
  6. Any collar worn for extended periods can cause a condition similar to bedsores, know as Pressure Necrosis. To reduce the possibility, you must do the followings(**VERY IMPORTANT**):
    - a. Never leave the collar on dog for more than 12 hours per day;
    - b. Examine the dog's neck daily for any signs of a rash or sore;
    - c. Supervise your dog during the first 2 days of training;
    - d. Check the fit to prevent excessive pressure. you should be able to insert one finger between the collar strap and your dog's skin;
    - e. Wash the dog's neck area and the correction poles as often as needed to keep the area and poles clean.
- If signs of skin irritation are noticed, immediately discontinue use and apply antibiotic ointment to help and sooth the area.

## Information on Terms of Use & Limitation of Liability

### 1. Terms of Use

This product is offered to you conditioned upon your acceptance without modification of the terms, conditions, notices contained herein. Usage of this product implies acceptance of all such terms, conditions, and notices.



### 2. Proper Use

This product is designed for use with dogs where training is desired. The specific temperament of your dog may not work with this product. We recommend that you not use this product if your dog is less than 8 pounds or if your dog is aggressive. If you are unsure whether this is appropriate for your dog, please consult your veterinarian, certified trainer or contact our customer support.

### 3. No Unlawful or Prohibited Use

This product is designed for use with dogs only. This dog training device is not intended to harm, injure, or provoke. Using this product in a way that is not intended could result in violation of Federal, State or local laws.

### 4. Limitation of Liability

In no event shall Aetertek be liable for any direct, indirect, punitive, incidental, special or consequential damages, or any damages whatsoever arising out of or connected with the use or misuse of this product. Buyer assumes all risks and liability from the use of this product.

**5. As agreed by related parts, the seller is responsible for after-sale service, and Aetertek only provide technical support. So if you have any problems related to quality warranty, please contact the seller.**

### 6. Modification of Terms and Conditions

Aetertek reserves the right to change the terms, conditions, and notices under which this product is offered.

# Warranty Card

Thank you for purchasing our dog trainer, one of the best training systems available for training your dog. Aetertek warrants the product to be free from defects in material and workmanship, arising under normal use for a period of 6 months from the date of original purchase when brand new. Misuse, loss or improper handling is not covered. Aetertek will not pay for transport/insurance costs incurred in returning the product to our authorized Reseller, such as loss of time, inconvenience, loss of use of your product, loss of your product and any incidental or consequential damages. To be entitled for 6 months international limited warranty of our dog trainer, please fill in the warranty card and keep it safe together with your proof of purchase. Failure to provide documentation will void warranty. This warranty extends only to original purchaser and is non-transferable.

## Statements for Warranty:

1: Please fill in the following form carefully. Information and signature of authorized distributor/reseller you purchased from are also required.

For Aetertek to Fill in:	
Series No:	
Authorized distributor/reseller's signature:	
For original purchaser to Fill in:	
Name:	Date purchased:
Address:	Tel No:
Authorized distributor/reseller you purchased from:	
Item No:	
Model NO.(e.g. AT-216C)	

2. If defected machine has been proven out of warranty for following reasons, we will charge maintenance/repair fee:

A: Warranty time expires.

B: Damages caused by injudicious operation or some irresistible external forces (such as : flood, fires, earthquakes, lighting, typhoon, etc.).

C: Damages caused by not abiding by the clauses for operation, maintenance or storing the product in accordance with the user manual.

D: Repaired, re-assembled, or changed components or circuits by user.

E: Opened the collar receiver or torn up the series number sticker or altered the warranty card's clauses by user

F: Other misuse or improper handling.

To help us solve the problems, please tick the relevant box/boxes:

NO	Descriptions of Defects	Please Tick
1	Appearance damage, need to replace shell or other components	<input type="checkbox"/> Yes
2	Receiver cannot be turned on	<input type="checkbox"/> Yes
3	LED light does not turn on	<input type="checkbox"/> Yes
4	Shock correction is not working properly, intensity level is not strong enough	<input type="checkbox"/> Yes
5	Vibration correction is not working properly, intensity level is not strong enough	<input type="checkbox"/> Yes
6	Beep correction is not working properly, intensity level is not strong enough	<input type="checkbox"/> Yes
7	LCD display cannot be turned on, back light cannot be turned on	<input type="checkbox"/> Yes
8	Buttons on transmitter do not work properly	<input type="checkbox"/> Yes
9	Collar cannot be charged properly	<input type="checkbox"/> Yes
10	Receiver cannot communicate with transmitter, transmitter does not send out signal	<input type="checkbox"/> Yes

**If not listed above, please state here:**

As agreed by related parts, the seller is responsible for after-sale service, and Aetertek only provides technical support. So if you have any problems related to quality warranty, please contact the seller. We reserve the rights to alter or cancel the warranty procedure at any time without prior notice.

The device has been approved for use in EU countries and is therefore provided with the **CE mark**. All necessary documentation is available on the website: [www.electric-collars.com](http://www.electric-collars.com)  
Changes to technical parameters, properties and printing errors reserved.

**Service center and distribution**

Reedog, sro

Sedmidomky 459/8 101

00 Prague 10

Phone: +1 646 980 4569

Email: [info@electric-collars.eu](mailto:info@electric-collars.eu)