

# USER MANUAL

## Cheerble Ball

EN

### IN THE BOX

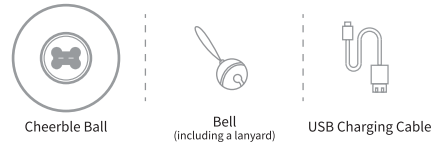

#### How to Install a bell(optional)

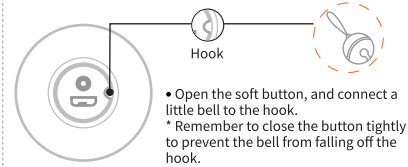

### QUICK START GUIDE

1. Turn on and select an interactive mode.

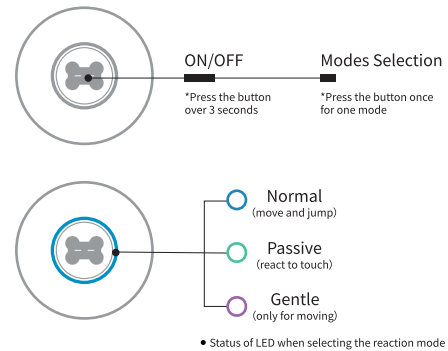

### QUICK START GUIDE

2. Two ways to activate your Cheerble Ball after selecting the interactive mode.

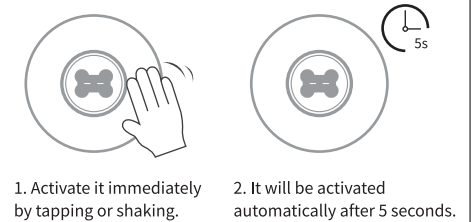

- ⚠ Before having fun with your cat, please check that your Cheerble Ball's surface is in good condition.
- ⚠ Supervision is required during the playtime to prevent your pet from swallowing.

### STATUS OF LED INDICATOR



**Tips** Cheerble Ball will play with your cat for 10 minutes, then it will rest for 30 minutes. However, during the rest time, it can be re-activated by your cat's touch and play with your cat for another 10 minutes.

### HOW TO CHARGE

1. Low battery

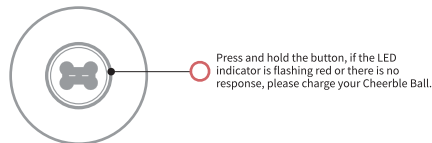

2. Opening the soft button to charge

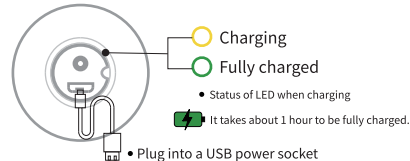

### SPECIFICATIONS



Model: C0419 / C0419-C

Weight: 40 g / 45 g

Dimensions:  $\phi 42$  mm /  $\phi 45$  mm

Battery: Li-Polymer 3.7v 135mAh

Operating Temperature: 0 ~ 40 °C / 32°F ~ 104°F

### Warranty

Cheerble offers one-year warranty for Cheerble Ball against any quality-related defects. Warranty starts from the date you receive your item. Warranty claims for product defects expire 90 days after opening a warranty claim.

#### Warranty are voided for/if:

- wrong item/component returned to us
- damage arising from improper use or maintenance (including, but not limited to: falls, extreme temperatures, operating devices improperly)
- damage arising from accident or external causes
- damage arising from abnormal wear and tear
- damage arising from unauthorized repair, modification or customization
- item used by other pets rather than the designated pets stated in product description (e.g. Cheerble Ball used by a dog)
- normal wear down of the outershell, battery of Cheerble Ball

#### Warranty are also voided for/if:

- lost or stolen items
- items that have expired their warranty period
- free products
- products that have been fully refunded
- any consumable items / parts supplied with the warranty item
- any accessories not being part or component of the warranty item
- proof of purchase is not provided by buyer
- items purchased from an unauthorized seller

More warranty details can be found at: [www.cheerble.com](http://www.cheerble.com)

The device has been approved for use in EU countries and is therefore provided with the **CE mark**. All necessary documentation is available on the website: [www.electric-collars.com](http://www.electric-collars.com)  
Changes to technical parameters, properties and printing errors reserved.

### **Service center and distribution**

Reedog, sro

Sedmidomky 459/8 101

00 Prague 10

Phone: +1 646 980 4569

Email: [info@electric-collars.eu](mailto:info@electric-collars.eu)