

Remote Training Collar

operating and training guide

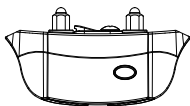

1 Dog Model Number

p-collar 640

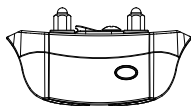

2 Dogs Model Number

p-collar 640B

PLEASE READ THIS ENTIRE GUIDE BEFORE OPERATING

0.3.0.02.640010-28-30

Important Safety Information

⚠ WARNING Not for use with aggressive dogs.

Do not use this Product if your dog is aggressive, or if your dog is prone to aggressive behavior. Aggressive dogs can cause severe injury and even death to their owner and others. If you are unsure whether this product is appropriate for your dog, please consult your veterinarian or certified trainer.

⚠ CAUTION Safety during on-leash training.

It is vitally important that you and your dog remain safe while learning during on-leash training. Your dog should be on a strong leash, long enough for him to attempt to chase an object, but short enough for him not to reach a road or other unsafe area. You must also be physically strong enough to restrain your dog when he tries to chase.

CAUTION Risk of skin damage.

Please read and follow the instructions in this manual. Proper fit of the collar is important. A collar worn for too long or made too tight on the pet's neck may cause skin damage ranging from redness to pressure ulcers.

- Avoid leaving the collar on the dog for more than 12 hours per day.
- When possible reposition the collar on the pet's neck every 1 to 2 hours.
- Check the fit to prevent excessive pressure; follow the instructions in this manual.
- Never connect a lead to the electronic collar; it will cause excessive pressure on the contacts.
- When using a separate collar for a lead, don't put pressure on the electronic collar.
- Wash the dog's neck area and the contacts of the collar weekly with a damp cloth.
- If a rash or sore is found, discontinue use of the collar until the skin has healed.
- If the condition persists beyond 48 hours, see your veterinarian.

These steps will help keep your pet safe and comfortable. Millions of pets are comfortable while they wear stainless steel contacts. Some pets are sensitive to contact pressure. You may find after some time that your pet is very tolerant of the collar. If so, you may relax some of these precautions.

Components



Remote

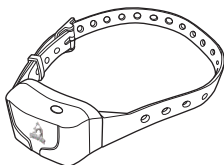

Receiver



Contact Points



Conductive Silicone

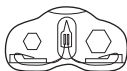

Test Lamp

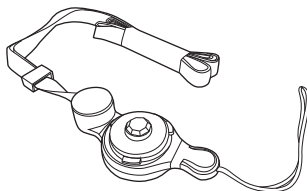

Neck Strap

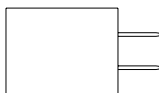

Power Adapter

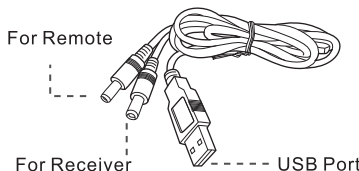

Other Items You May Need

- Scissors

Main Features



1000 Yards Remote Range



User Expandable to a Two-dog System



Tone, Vibration, and Shock Commands



16 Adjustable Progressive Intensity Levels for Shock



White Backlit LCD Indicating Intensity Level and Battery



2-hour Rapid Charging Lithium Polymer Battery



100% Waterproof Receiver



Innovative Blind Operation with Touch Distinguishing Mode Buttons

Overview

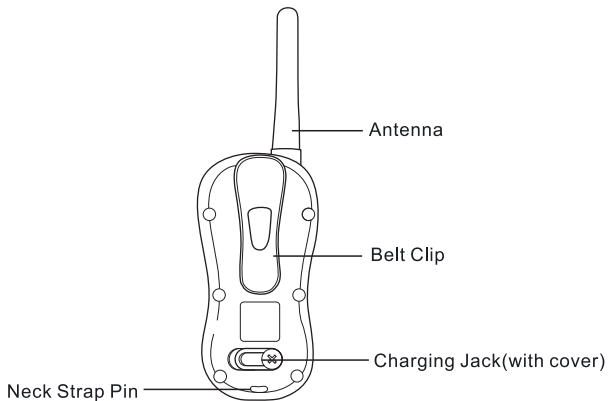
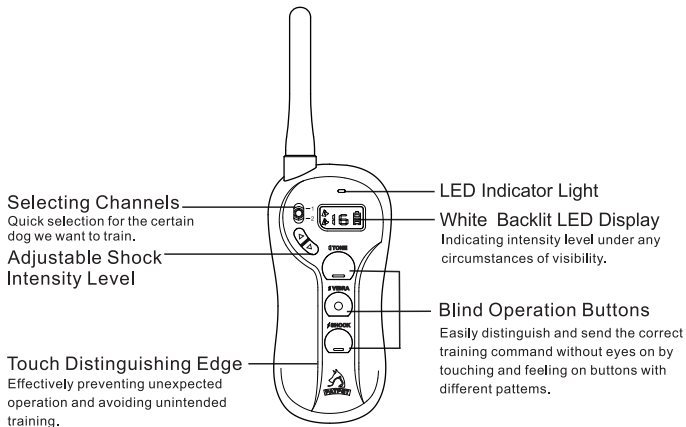

Remote

Overview

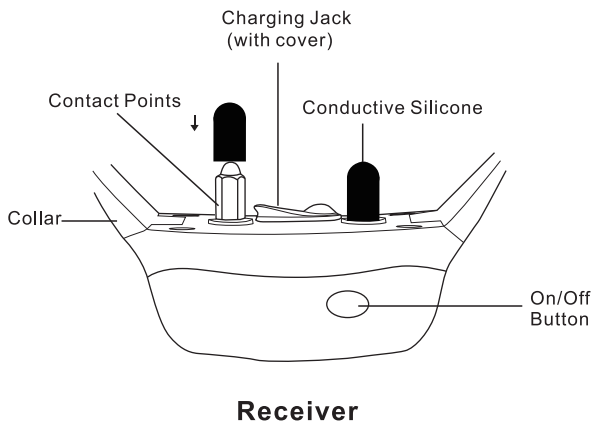

Setting Up the Product

Before you can use the Dog Training Collar, you must set up the product following the steps below:

1. Prepare the Remote: install the antenna and turn the Remote on.
2. Charge the Remote and the Receiver.
3. Prepare the Receiver: install contact points, conductive silicone, and turn the Receiver on.
4. Function test: Test function of buttons before putting it on the dog.
5. Use the Test Lamp to test shock function or use as a screw driver.
6. Pair the Remote and the Receiver, pair them when the product loses its code or pair a second collar.

Step 1 Charging the battery

The unit uses Lithium-Polymer batteries.

1. Charge the unit before using the unit for the first time.
2. Do not charge the batteries near any flammable substances.
3. Fully charge the batteries if the unit is to be stored without use for a period of 3 months or more.

The unit need to be charged under any of the below situations:

1. The indicator light on the collar is emitting a red color and flashes rapidly.
2. The 3 bar indicator on the Remote LCD shows just 1 bar.
3. The indicator light on the Remote or Receiver will not come on.
4. The indicator light on the Remote or Receiver comes on momentarily when any of the Mode Buttons are pressed.

Battery Charging Procedure.

NOTE: The unit has a partial charge when it leaves our facility, upon receipt of the collar, be sure to give it a 4-hour initial charge before the first use.

1. Lift the rubber covers protecting the Remote and Receiver Charging Jack.
2. Connect the charger connectors to the Remote and Receiver Charging Jack, as shown below.
3. Plug the charger into a standard wall outlet.

4. Connect the USB port to the Charging Adapter.
5. Charge the unit for 4 hours for the first charge. Recharges take only 2-3 hours.
6. When charging is completed, remove the charger connector, and replace their rubber covers .

Note: The Battery Indicator on the Remote will scroll and the indicator light will be steady red while charging; The Battery Indicator will become steady, and the LED Indicator Light will flash when fully charged. The indicator light on the Receiver will be steady red while charging and green when fully charged.

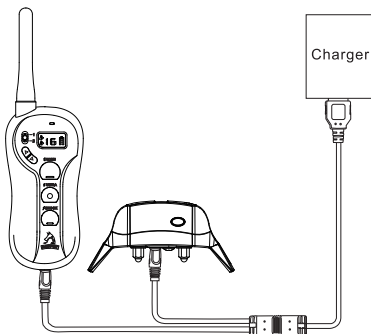

Step 2 Prepare the Remote

1. Install the antenna tightly to the corresponding position of the Remote tightly.
2. Press Tone/Vibra/Shock button on the Remote. The white backlight on the display stays on for approximately 5 seconds after a button press. After that if not button is pressed within 25 seconds, the white backlight will shut off first, the display will shut off and the Remote will go into battery conservation mode .
3. Pressing Tone/Vibra/Shock button will turn the display back on.



Step 3 Prepare the Receiver

3

Install the Contact Points & Conductive Silicone

1. Select the correct Contact Points and Conductive Silicone length for your dog's coat type:
 - For dogs with thicker coats, Use 2pcs longer Contact Points and Conductive Silicones.
 - For dogs with shorter coats, Use 2pcs shorter Contact Points and Conductive Silicones.
2. Insert the Contact Points into the ports of the collar, rotate clockwise to tighten them.
3. Install the Conductive Silicone onto the Contact Points to make the contact softer so it is better for the dog's skin.

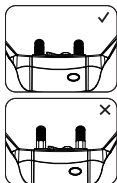
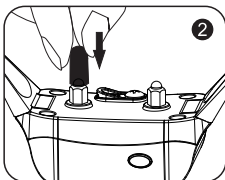
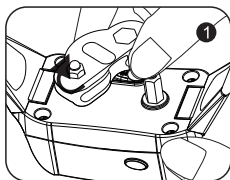

Turn on the Receiver

- Press the On/Off Button until the Green LED light comes on. In normal mode, the Green LED will flash every 4 seconds, indicating the Receiver is on and ready to receive a signal from the Remote.

Turn off the Receiver

1. Press and hold the On/Off Button until the Red LED flashes rapidly then shuts off. (This takes approximately three seconds.)
2. Release the On/Off Button.

Note: To extend the life of the batteries, turn the Receiver off when it is not in use.

Step 4 Function test

We recommend you experience firsthand how the different levels feel on yourself and always begin at the lowest level, and increase the levels up to your personal comfort levels.

1. Place one finger over both contact points of the training collar.
2. Hold your remote approximately 2 ft. from the training collar.
Press the vibration button continuously for 1 to 2 seconds. You should feel continuous vibration.
3. Starting at level 1 for shock, Press the shock button.
4. Increase the level until the sensation begins to feel uncomfortable.

NOTE: Continuous stimulation will transmit for no more the 10 continuous seconds. To reactivate, release and repress the button.

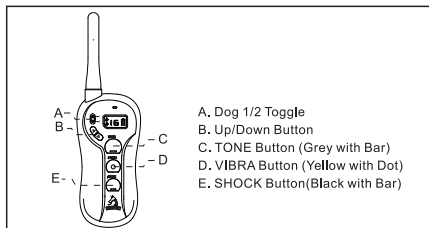

Tone Only Button (Grey with Bar):

Sends an audible tone to the collar. No stimulation is delivered.

Vibration Only Button (Yellow with Dot):

Sends 1 non-adjustable level of vibration stimulation to the collar.





Shock Only Button (Black with Bar):

Delivers shock through the Contact Points on the Receiver at the level shown on the Digital Display. When held down for 10 consecutive seconds, the Remote will “time-out”, and shock cannot be delivered for 5 seconds. You must release and press the button again after the 5 seconds time-out period, before additional shock can be delivered.

Dog 1/ 2 Toggle Switch

Located on the upper left face of the Remote is a toggle switch, allowing you to switch between Dog 1 and Dog 2.

Shock Up/ Down Button: To adjust shock Intensity Level from 1 to 16.

	Vibration: Sends 1 non-adjustable level of vibration stimulation to the collar.
	Tone: sends a tone with non-adjustable level to the Receiver .
	Shock: sends 1-16 adjustable levels of static stimulation to the Receiver .
	Press to increase the shock level.
	Press to decrease the shock level.

Note:

- The shock level can be adjusted from 1 to 16 levels; please adjust it properly as per your dog's reaction.
- It is not recommended to press and hold the Vibration / Shock Button too long to avoid physical or psychological hurt to the dog.

Step 5 How to Use the Test Lamp

Shock Function Test

1. Turn on the Receiver.
2. Hold the Test Lamp contacts against the Contact Points(or Conductive Silicone).
3. Press the Shock Button and the Test Lamp will be lighted. It will be brighter as the shock level increases.

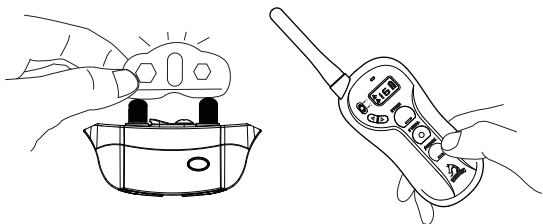

As a Screw Driver

Use the Test Lamp to tighten or loosen the Contact Points when preparing the Receiver.

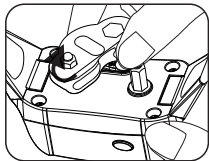

Step 6 Pair the Remote and the Receiver

If your Receiver does not beep when the TONE Button of the Remote is pushed, or if you feel the Receiver is not responding to the Remote , follow these steps to pair:

1. Take the Receiver off of your pet. Turn the Receiver off. Restart, press and hold the On/Off Button until the green, Red LED flashes alternately. Hold for 30 seconds, within which pairing should be completed.
2. Press and hold the TONE and VIBRA button on the Remote at the same time until the Green LED light on the Receiver flashes rapidly for 5 times, indicating pairing is completed.

Two Dog System

NOTE: If you wish to add another Receiver Collar to the training system, please buy the same model receiver.

Remote Transmitter

1. Switch Dog1 to Dog2 by short pressing the button -1/-2 .
2. Turn on the Receiver Collar for Dog 2, then repeat the pairing steps above.
3. If Dog 2 Receiver does not respond. Pairing may be needed.
Repeat steps in Pair the Remote and the Receiver above.

Dog Training

Selecting The Contact Points and The Conductive Silicone

For the best results select the correct Contact Points and Conductive Silicone base on your dog's coat.

- For dogs with thicker coats, Use 2pcs longer Contact Points and Conductive Silicones.
- For dogs with shorter coats, Use 2pcs shorter Contact Points and Conductive Silicones.

Fit the Training Collar

Important: The proper fit and placement of your training collar is important for effective operation. The contact points must have directly touched your dog's skin on the underside of his neck.

1. Start with the collar turned off and your dog standing comfortably, not sitting(A).
2. Put the training collar on your pet directly under your dog's chin. Center the contact points underneath your dog's neck, and touch the skin (B) .

NOTE: It's sometimes necessary to trim the hair around the contact points to make sure that contact is consistent. We've also included longer contact points.

CAUTION

Do not shave the pet's neck as this may increase the risk of skin irritation. The training collar should not be worn for more than 12 hours out of every 24-hour period. Leaving the training collar on too long could lead to skin irritation. Remove the collar when you're not training your dog.

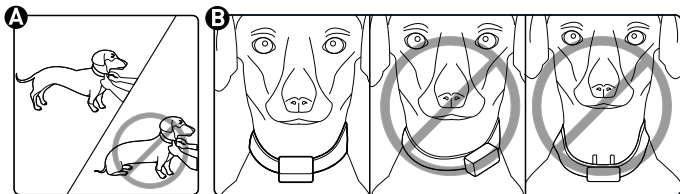

Find the Best Shock Level for Your Pet

The unit comes with Up and Down buttons to control the Shock Level, with Level 1 being the lowest level and Level 16 being the highest. The level of Shock best suited for your dog depends on your dog's temperament and threshold for Shock. Always start at the lowest level and work your way up. The appropriate level can be found when the dog responds to the Shock with a mild reaction, such as a flick of the ear, a lick of the lips, a tensing of the neck muscles etc. The Shock Level may vary depending on the training situation. When highly distracted, dogs will require a higher level of Shock.

General Tips

- Pets should be at least 6 months old before using the Training Collar.
- Be sure to let your pet associate the collar with happy things.
- Using a treat and a praise AS SOON AS the dog obeys the command, as positive training is better than negative training. Adding the treat helps reinforce the good behavior. The object of the collar is to NOT need to use it.
- It's NOT A TOY ! Only responsible family members should use the Training Collar.
- Correct one misbehavior or teach one obedience command at a time so that your pet is not confused .
- If your pet reacts to the collar by hiding or acting fearfully ,check the settings as they may be too high for your pet's needs.
- It is recommended to train one dog at a time in a distraction-free environment, both to increase efficiency and to avoid temptation or distraction from other dogs.

⚠ WARNING



Never use the Remote Training Collar to correct or eliminate any form of aggressive behavior. We recommend you to consult your local veterinarian or professional trainer to determine if your pet might be aggressive. See page 3 for more information.

Device Information

Product Specification

Battery Type	Rechargeable, lithium polymer battery
Battery Life(typical use)	Remote: 20 days Receiver: 10 days
Remote Waterproof Rating	IEC 60529 IPX5, rainproof
Receiver Waterproof Rating	IEC 60529 IPX7, fully waterproof
Operating temperature range	From 0-40°C(from 32-104°F)
Wireless Power	100mW
Wireless Range	1000 Yards (3000 feet)

The LCD & LED indicator

	Indicates Shock levels ranging from 1-16, and appears in the middle part.
	Indicates the active dog receiver and appear in the left part.
	Indicates battery's power level. Note: The battery indicator will flash every second to indicate low battery.

Remote LED Indicator Light – Function and Response

Button	Button Function	Remote Indicator Light Response
STONE (Grey with Bar)	Delivers audible tone to collar	Red LED on for length of button press
VIBRA (Yellow with Dot)	Delivers vibration to collar (vibration will time-out for 5 seconds if pressed continuously for 10 seconds and will reset after time-out period)	Red LED on for length of button press
SHOCK (Black with Bar)	Delivers shock to collar base on current level shown on Digital Display (shock will time-out for 5 seconds if pressed continuously for 10 seconds and will reset after timeout period)	Red LED on for length of button press
STONE and VIBRA Buttons held simultaneously	Transmits Pairing command to Receiver	Red LED on for length of button press

Receiver Indicator Light – Function and Response

Receiver Function	Green LED Response
Power on	Flashes once
Normal operation - Good battery	1 flash every 5 seconds
Training tone	On length of TONE button press
In pairing position	Flashes once every second within 25 seconds
Pairing Complete	Flashes rapidly for five times
Charging Complete	On length of the charger connected

Receiver Function	Red LED Response
Power off	On for 3 seconds
Normal operation - Low battery	Flashes rapidly
Vibration/Shock	On length of VIBRA/SHOCK button press
Charging	On length of charging within 2-3 hours

To maximize the distance

The unit has a 1000 Yards range. The range may vary with the way the Remote is held. Hold the Remote away from your body to receive the greatest range. For maximum signal strength, keep the device properly charged.



Maximum range



Typical range



Minimum range

NOTE: Avoid touching the antenna or the range may decrease substantially.

Frequently Asked Questions

Is the Vibration/Shock safe for my pet?	While the Vibration/Shock is unpleasant, it is harmless to your pet. Electronic training devices require interaction and training from the owner to achieve desired results.
How old does my pet have to be before using the Remote Training Collar?	Your pet should be able to recognize basic obedience commands such as "Sit" or "Stay". Pets should be at least 6 months old before using the Training Collar.
Once my pet is trained and has been obeying my commands, will he have to continue to wear the Receiver?	Probably not. You may need to reinforce training with the Receiver from time to time.
Is the Receiver waterproof?	Yes.
Will I get exactly 1000 Yards of range with the Remote Training Collar?	The range of the Remote Training will vary according to terrain, weather, vegetation, as well as transmission from other radio devices. See "To maximize the distance" for tips on maximizing your range.
How long can I continuously deliver Vibration/Shock to my pet?	The maximum amount of time you can press the Vibration/Shock Button and deliver Vibration/Shock to your pet continuously is 10 seconds. After this, there's a time-out and Vibration/Shock cannot be delivered for 5 seconds. After the 5 second time-out period, Button can be pressed and Vibration/Shock can be delivered again.

Troubleshooting

<p>My pet does not respond when I press a button.</p>	<ul style="list-style-type: none"> • Make sure the Receiver has been turned on. • If your range has reduced from the first time you used the Remote Training Collar, the battery(s) may be low in either the Remote or Receiver . • Terrain, weather, vegetation, transmission from other radio devices and many other factors can impact the amount of range you have with the unit. • Test the Receiver. Refer to “How to use the Test Lamp” for details. • Increase the Shock Level. Refer to “Find the Best Shock Level for Your Pet”. • Make sure the Receiver Contact Points are placed snugly against your pet’s skin. Refer to “Collar Fitting” for more information.
<p>The Receiver will not turn on.</p>	<ul style="list-style-type: none"> • Make sure the Receiver has been charged. For the initial charge, be sure to charge it for 4 hours. Subsequent charges only take 2-3 hours.
<p>The Receiver is not responding to the Remote .</p>	<ul style="list-style-type: none"> • Verify the Receiver is on. • If the Indicator Light does not come on when any button is pressed on the Remote, ensure that the batteries are fully charged. • If the first two solutions did not resolve your problem, Refer to “Pair the Remote and the Receiver ”.

Warranty and repair information

1-Year Warranty

The original purchaser for this unit is provided with 1-YEAR WARRANTY. The warranty begins from the date of purchase. For the first year, coverage is for both Parts and Labor on warranty repair services, but the return postage is for the buyer's account .

Accessories such as chargers, splitter cables, antennas, straps, and batteries are covered for the first year only. When the warranty expires, customers will need parts and repairs at their own expense.

To Qualify for the Warranty

All products must provide a proof of purchase in order to initiate repair work under warranty. We strongly recommend keeping the original receipt. If the proof of purchase is not available , we will estimate the age of the unit by the S/N number. The estimation may differ from the actual purchase date, but it will be the only method that we judge your order time .

Won't Qualify for 1-Year Warranty

We DO NOT offer warranty for products that have been bought secondhand or as a resold product.

Issues of replacement and refunds, if units are kept less than 30 days from an authorized dealer must be addressed to the dealer directly. If more than 30 days, please send the units to us for after-sale.

Manual damage or loss is not covered by the warranty .

Any water damage on the Water Resistant Transmitters and the Water Resistant Receivers of our product series will not be covered. All replacement costs for either the transmitter or receiver will be the owner's responsibility.

The warranty is void if the unit has been altered or an unauthorized person who attempts to repair work has damaged the unit .

Replacement of batteries is not recommended during the warranty period. If the customer chooses to replace the batteries, any damage to the unit during the change-out by the owner will make the warranty void. We reserve the right to retain and discard any parts or accessories that have been damaged upon repairing.

Procedure for Repair Work

If the unit is malfunctioning, please refer to the "Troubleshooting Guide" in the Operating and Training Guide before sending it back for Service. The cost of shipping products under warranty is the customer's responsibility. We are not responsible for units damaged or lost in transition. We are not responsible for the loss during training while the unit is under repairing. We do not provide renting units or any form of compensation during repairing. A copy of the sales receipt showing the purchase date may be required before warranty work is initiated. Please include a brief outline of the problem and include your name, address, city/state/zip code, daytime phone number, evening phone number, and email address.

Compliance

FCC - USA

This device complies with part 15 of the FCC Rules. Operation is subject to the following two conditions:

- (1) This device may not cause harmful interference.
- (2) This device must accept any interference received, including interference that may cause undesired operation.

CAUTION: Modification or changes to this equipment not expressly approved by Patpet Technology Co., Ltd may void the user's authority to operate the equipment.

NOTE: This equipment has been tested and found to comply with the limits for a Class B digital device, pursuant to part 15 of the FCC Rules. These limits are designed to provide reasonable protection against harmful interference in a residential installation. This equipment generates, uses, and can radiate radio frequency energy and, if not installed and used in accordance with the instructions, may cause harmful interference to radio communications. However, there is no guarantee that interference will not occur in a specific installation. If interference does occur to radio or television reception, which can be determined by turning the equipment off and on, the user is encouraged to try to correct the interference by one or more of the following measures:

- Reorient or relocate the receiving antenna.
- Increase the separation between the equipment and the receiver.
- Connect the equipment to an outlet on a circuit different from that to which the receiver is connected.
- Consult customer care, the dealer, or an experienced radio/TV technician for help.

Reference Size for Different Dogs

Size	Neck (in)	Chest Measurement (in)	Back Length (in)	Type
Mini	7.8-8.6	9.8-11.8	7.5	Chihuahua, Yorkshire Terrier
Small	7.8-9.5	11.4-14.2	9	Chihuahua, Yorkshire Terrier, Poodle, Pomeranian
Medium	9-11	13.7-16.5	11	Maltese Dog, Shih Tzu
Large	10.6-12.2	16.2-18.5	12.2	Miniature Schnauzer, Pekingese
Large	11.8-13.4	18.1-20.8	13.8	Schnauzer, English Cocker Spaniel
Large	13-14.5	20.5-23.2	15.7	Beagle
Huge	17-18.9	30-33	23.6	Husky
	18.5-20.5	34.6-38.2	25.6	Labrador Retriever
	21.6-24.4	36.2-39.3	27.5	Golden Retriever, Old English Sheepdog

Reference Weight for Dogs

Large Dog (Body height above 24 inch, Weight above 88 lbs)

Medium Dog (Height 16-24 inch, Weight 24.2-66 lbs)

Small Dog (Height 10-16 inch, Weight 8.8-22 lbs)

Mini Dog (Height under 10 inch, Weight under 8.8 lbs)



Shenzhen Patpet Technology Co.,Ltd

 <https://patpet.com/>

 Become a dealer: inquiry@patpet.com

 After-service: support@patpet.com

 [@PatpetDogCollar](#)

 Youtube Video Guide



MADE IN CHINA

The device has been approved for use in EU countries and is therefore provided with the **CE mark**. All necessary documentation is available on the website: www.electric-collars.com
Changes to technical parameters, properties and printing errors reserved.

Service center and distribution

Reedog, sro

Sedmidomky 459/8 101

00 Prague 10

Phone: +1 646 980 4569

Email: info@electric-collars.eu