

PETSAFE

RECHARGEABLE BARK COLLAR

PBC19-16001

EN

FR

NL

ES

IT

DE

Hereinafter Radio Systems Corporation, Radio Systems PetSafe Europe Ltd., Radio Systems Australia Pty Ltd. and any other affiliate or Brand of Radio Systems Corporation may be referred to collectively as “We” or “Us”.

Important Safety Information

Explanation of Attention Words and Symbols used in this guide



This is the safety alert symbol. It is used to alert you to potential personal injury hazards. Obey all safety messages that follow this symbol to avoid possible injury or death.

⚠ WARNING

WARNING indicates a hazardous situation which, if not avoided, could result in death or serious injury.

⚠ CAUTION

CAUTION, used with the safety alert symbol, indicates a hazardous situation which, if not avoided, could result in minor or moderate injury.

CAUTION

CAUTION, used without the safety alert symbol, indicates a hazardous situation which, if not avoided, could result in harm to your pet.

NOTICE

NOTICE is used to address practices not related to personal injury.

⚠ WARNING

- **Not for use with aggressive dogs.** Do not use this Product if your dog is aggressive, or if your dog is prone to aggressive behaviour. Aggressive dogs can cause severe injury and even death to their owner and others. If you are unsure whether this product is appropriate for your dog, please consult your veterinarian or a certified trainer.
- This device contains Lithium-Ion (Li-Ion) batteries; never incinerate, puncture, deform, short-circuit, or charge with an inappropriate charger. Fire, explosion, property damage, or bodily harm may occur if this warning is not followed.

⚠ CAUTION

- The Bark Collar is not a toy. Keep it away from the reach of children. Use it only for its bark stopping purpose.

CAUTION

Risk of skin damage. Please read and follow the instructions in this manual. Proper fit of the collar is important. A collar worn for too long or made too tight on the pet's neck may cause skin damage. Ranging from redness to pressure ulcers; this condition is commonly known as bed sores.

- Avoid leaving the collar on the dog for more than 12 hours per day.
- When possible reposition the collar on the pet's neck every 1 to 2 hours.
- Check the fit to prevent excessive pressure; follow the instructions in this manual.
- Never connect a lead to the electronic collar; it will cause excessive pressure on the contacts.
- When using a separate collar for a lead, do not put pressure on the electronic collar.
- Wash the dog's neck area and the contacts of the collar weekly with a damp cloth.
- Examine the contact area daily for signs of a rash or a sore.
- If a rash or sore is found, discontinue use of the collar until the skin has healed.
- If the condition persists beyond 48 hours, see your veterinarian.
- For additional information on bed sores and pressure necrosis, please visit our website.

These steps will help keep your pet comfortable and secure. Millions of pets are comfortable while they wear stainless steel contacts. Some pets are sensitive to contact pressure. You may find after some time that your pet is very tolerant of the collar. If so, you may relax some of these precautions. It is important to continue daily checks of the contact area. If redness or sores are found, discontinue use until the skin has fully healed.

The PetSafe® Rechargeable Bark Collar must be used only on healthy dogs. We recommend that you take your dog to a veterinarian before using the collar if he is not in good health.

EN

FR

NL

ES

IT

DE

EN

FR

NL

ES

IT

DE

Thank you for choosing the PetSafe® Brand. You and your pet deserve a companionship that includes memorable moments and a shared understanding. Our products provide you with the tools and technologies to successfully train your pet. **If you have any questions about our products or training your pet, please visit our website at www.petsafe.com or contact our Customer Care Centre. For a listing of Customer Care Centre telephone numbers, visit our website at www.petsafe.com.**

To get the most protection out of your warranty, please register your product within 30 days at www.petsafe.com. By registering and keeping your receipt, you will enjoy the product's full warranty and should you ever need to call the Customer Care Centre, we will be able to help you faster. Most importantly, we will never give or sell your valuable information to anyone. Complete warranty information is available online at www.petsafe.com.

TABLE OF CONTENTS

Components	5
Features	5
How the System Works	5
Fitting the Bark Control Collar	6
Charging the Bark Control Collar	6
Temperament Learning	7
Testing the Bark Control Collar	8
What to Expect During Use	8
Frequently Asked Questions	9
Battery Disposal	9
Important Recycling Advice	9
Compliance	10
Terms of Use and Limitation of Liability	11
Warranty	12

Components

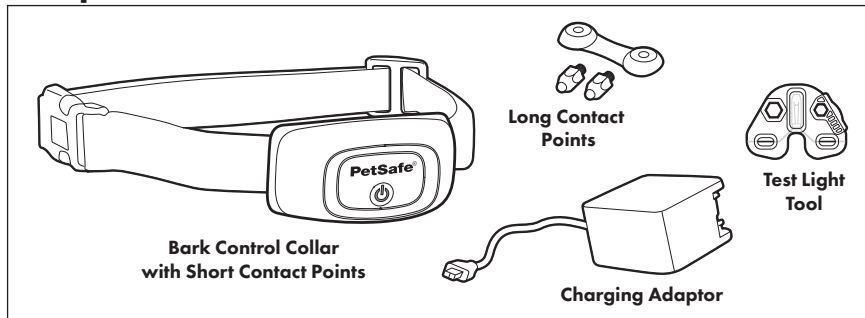

Features

- 15 levels of Static Stimulation
- Waterproof and rechargeable collar
- LED battery indicator

How the System Works

The PetSafe® Rechargeable Bark Collar uses several features designed to shorten the training phase and promote good behaviour.

The bark control collar has a unique sensor that provides the most reliable bark detection available. It also uses temperament learning to decrease and in most cases eliminate nuisance barking.

The system has 15 levels of static stimulation. It begins with low-level stimulations. If excessive barking continues the stimulation intensity will increase with each successive bark until the barking stops. Once the dog has learned to reduce the barking, the initial warning stimulations are reduced. As a built-in safety feature, if your dog barks 15 times or more within a 1 minute 20 second period, the bark control collar will automatically shut off for 3 minutes.

Lite Rechargeable Bark Collar

PetSafe® Lite Bark Collars are designed specifically for dogs with a sensitive or timid personality. The stimulation levels are very gentle even when increasing to higher levels. Lite bark collars can be used with dogs of all sizes, but they are particularly well suited for small to medium-sized dogs.

EN

FR

NL

ES

IT

DE

Fitting the Bark Control Collar

Important: The proper fit and placement of your bark control collar is important for effective operation. The contact points must have direct contact with your dog's skin on the underside of his neck.

1. Make sure that the collar is turned off.
2. Start with your dog standing comfortably **(A)**.
3. Place the collar on your pet so that the PetSafe® logo is right side up and the collar is directly under your dog's chin. Centre the contact points underneath your dog's neck, touching the skin **(B)**. **NOTE:** It is sometimes necessary to trim the hair around the contact points to make sure that contact is consistent.
4. Check the tightness of the collar by inserting one finger between the end of a contact point and your dog's neck **(C)**. The fit should be snug but not constricting.
5. Allow your dog to wear the collar for several minutes then recheck the fit. Check the fit again as your dog becomes more comfortable with the collar.

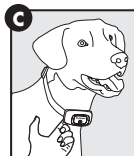
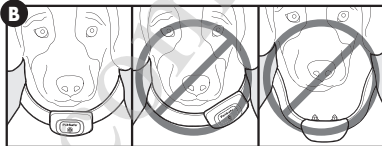
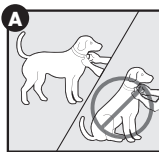

CAUTION

Do not shave the pet's neck as this may increase the risk of skin irritation. The collar should not be worn for more than 12 hours out of every 24-hour period. Leaving the collar on too long could lead to skin irritation.

Charging the Bark Control Collar

Excessive charging can shorten battery life. Only charge when you see the low battery light.

1. Lift the rubber cover protecting the charging port and connect the charger.
2. Plug the charger into a standard wall outlet. The green LED will appear.
3. Recharges take no more than 5 hours. Although your bark control collar should be partially charged, you will want to fully charge it before using it for the first time. The green LED is will turn off after charging is complete.
4. When the bark control collar is charged, replace the rubber cover.

To Turn the Bark Control Collar On

Press and hold the power button (D) until you hear a low to high beep and the green LED appears, and then release. The green LED will flash once every 5 seconds.

To Turn the Bark Control Collar Off

Press and hold the power button until the bark control collar beeps high to low, and then release. The red LED will be illuminated during the button press and will turn off when the bark control collar turns off.

Quick Tip: When you are not using the collar, you will want to turn it off. This will increase the battery life.

LED Function and Response

The two colour LED indicates the battery level. When the battery is low, the red LED will blink 3 times every 5 seconds. When it is fully discharged, no LED will flash. When the collar is charged, the green LED will flash once every 5 seconds.

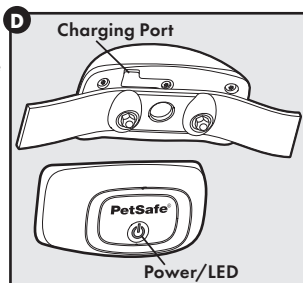

Temperament Learning

Temperament Learning tracks the number of stimulations needed to substantially reduce, and in most cases, eliminate the number of nuisance barks. The collar starts at the lowest static stimulation level and increases the intensity with each successive bark until the barking stops. This stimulation level becomes the starting level the next time the dog barks. Once your dog has learned to reduce this barking, the initial warning stimulations are automatically reduced.

NOTE: As a built-in safety feature, if your dog barks 15 times or more within an 80 second period, the bark control collar will automatically shut off for 3 minutes.

Reset the Stimulation Level

1. Power the collar on. Wait 5-10 seconds or until the first green LED flash.
2. Press and hold the on/off button.
3. Continue holding through the red LED and power off tone.
4. The green LED will flash 5 times to confirm the correction level has been reset to level 1.
5. Release the on/off button. The bark collar will now be powered off.

Testing the Bark Control Collar

1. Plug the bark control collar into the charger.
 2. While the charger is attached press and hold the on/off button.
 3. Continue to hold the on/off button while unplugging the bark control collar from the charger. A blue LED will appear and the red and green LED lights will turn off.
 4. Release the on/off button. There is a 2 second delay and the following will begin:
The bark control collar will emit an audible tone (beep) for each level of stimulation.
Then it will sound the normal power off tone and turn itself off.
 5. The test can be stopped at any time by pressing the on/off button.
-

What to Expect During Use

Important: Do not leave your dog alone the first few times he receives a stimulation.

Place the bark control collar properly on your dog and wait nearby until he barks. Most dogs will understand very quickly that the collar is disrupting their urge to bark and will relax and stop barking. Because the static stimulation may be surprising or startling at first, some dogs may bark more at the initial stimulation.

On rare occasions, a dog may begin barking at the stimulation. If this happens, reassure your dog with calm, soothing voice. As your dog relaxes, he will understand that if he becomes quiet, he will not receive any more static stimulations. The small minority of dogs that have this reaction will only have it the first time they wear the bark control collar.

You should notice a reduction in your dog's barking within the first couple of days that he wears the bark control collar. At this point, it is important to remember the learning process is still not complete. Dogs will "test" this new learning experience and will increase their attempts to bark. This usually occurs during the second week a dog wears the bark control collar. If this does occur, remain consistent and do not alter your use of the bark control collar. You must place the bark control collar on your dog in every situation when you expect him to be quiet. If your dog is not wearing the bark control collar, he may resume barking and his learning would suffer a setback.

FREQUENTLY ASKED QUESTIONS

How old does a dog have to be before using the bark control collar?	<ul style="list-style-type: none"> Your dog should be at least 6 months old before using the bark control collar. The collar may be too large for dogs under 3.6 kg.
Will the bark control collar work for my dog?	<ul style="list-style-type: none"> The bark control collar is safe and effective for most breeds and sizes of dogs, though it may be too large for dogs under 3.6 kg to wear comfortably.
Can I attach a lead to the bark control collar?	<ul style="list-style-type: none"> No. This can result in pulling the Contact Points too tightly against your dog's neck. Attach a lead to a separate, non-metallic collar or a harness, making sure the extra collar does not put pressure on the Contact Points.

Warranty

Three Year Non-Transferable Limited Warranty

This Product has the benefit of a limited manufacturer's warranty. Complete details of the warranty applicable to this Product and its terms can be found at petsafe.com and/or are available by contacting your local Customer Care Centre.

- Radio Systems PetSafe Europe Ltd, 2nd Floor, Elgee Building, Market Square, Dundalk, Co. Louth, A91 YR9X Ireland
- Radio Systems Corporation, 10427 PetSafe Way, Knoxville, TN 37932 USA

Australia/New Zealand – In compliance with the Australian Consumer Law, Warranties Against Defects, effective January 1, 2012, warranty details of this Product are as follows: Radio Systems Australia Pty Ltd. (hereinafter referred to as "Radio Systems") warrants to the original retail purchaser, and not any other purchaser or subsequent owner, that its Product, when subject to normal and proper residential use, will be free from defects in material or workmanship for a period of three (3) years from the purchase date. An "original retail consumer purchaser" is a person or entity who originally purchases the Product, or a gift recipient of a new Product that is unopened and in its original packaging. When serviced by Radio Systems Customer Service, Radio Systems covers labour and parts for the first three years of ownership; after the first three years, a service or upgrade charge will apply relative to replacement of the Product with new or refurbished items at Radio Systems' sole discretion.

The limited warranty is non-transferable and shall automatically terminate if the original retail consumer purchaser resells the Radio Systems Product or transfers the property on which the Radio Systems Product is installed. This Limited Warranty excludes accidental damage due to dog chews; lightning damage; or neglect, alteration, and misuse. Consumers who purchase products outside of Australia, New Zealand, or from an unauthorised dealer will need to return the Product to the original place of purchase for any warranty issues.

Please note that Radio Systems does not provide refunds, replacements, or upgrades for change of mind, or for any other reason outside of these Warranty terms.

Claims Procedure: Any claim made under this Warranty should be made directly to Radio Systems Australia Pty Ltd. Customer Care Centre at:

Radio Systems Australia Pty Ltd.
PO Box 7266, Gold Coast Mail Centre QLD 9726, Australia
Australia Residents: 1800 786 608
New Zealand Residents: 0800 543 054
Email: aus-info@petsafe.net

To file a claim, a proof of purchase must be provided. Without a proof of purchase, Radio Systems will not repair or replace faulty components. Radio Systems requests the Consumer to contact the Radio Systems Customer Care Centre to obtain a Warranty Return number, prior to sending the Product. Failure to do so may delay in the repair or replacement of the Product.

If the Product is deemed to be faulty within 30 days from date of original purchase, Radio Systems will organise for a replacement to be sent in advance of returning the faulty Product. A Post Bag will be included with the replacement Product for the return of the faulty Product. The Product must be returned within 7 days of receiving the replacement. If the Product is deemed to be faulty after 30 days from the date of original purchase, the consumer will be required to return the Product to Radio Systems at the consumer's own expense. Radio Systems will test and replace the faulty unit or its components and return to the consumer free of charge, provided the Product is within its said warranty period. This warranty is in addition to other rights and remedies available to you under the law. Radio Systems goods come with guarantees that cannot be excluded under the Australia Consumer Law. You are entitled to a replacement or refund for a major failure and for compensation for any other reasonably foreseeable loss or damage. You are also entitled to have the goods repaired or replaced if the goods fail to be of acceptable quality and the failure does not amount to a major failure.

Should you have any queries or require any further information, please contact our Customer Care Centre on 1800 786 608 (Australia) or 0800 543 054 (New Zealand).

Compliance

Modification or changes to this equipment not expressly approved by Radio Systems Corporation may void the user's authority to operate the equipment.



Radio Systems Corporation declares under its own responsibility, that these products are in compliance with the essential requirements under article 3 of the RED (2014/53/EU) and the RoHS Directive (2011/65/EU). Unauthorised changes or modifications to the equipment that are not approved by Radio Systems Corporation may violate EU RED regulations, could void the user's authority to operate the equipment, and will void the warranty.

Hereby, Radio Systems Corporation, declares that these products are in compliance with the essential requirements and other relevant provisions. The Declaration of Conformity can be found at: www.petsafe.com/customer-care/eu_docs.php

IC

This device complies with Industry Canada licence-exempt RSS standard(s). Operation is subject to the following two conditions: (1) this device may not cause interference, and (2) this device must accept any interference, including interference that may cause undesired operation of the device.

ACMA

This device complies with the applicable EMC requirements specified by the ACMA (Australian Communications and Media Authority).



Important Recycling Advice

Please respect the Waste Electrical and Electronic Equipment regulations in your country. This equipment must be recycled. At the end of the product life, do not place it in the normal municipal waste system. Please check the regulations in your area or return it to where it was purchased so that it can be placed in our recycling system. If these options are not possible, please contact the Customer Care Centre for further information.

EN

FR

NL

ES

IT

DE

Terms of Use and Limitation of Liability

1. **Terms of Use**

The use of this product is subject to your acceptance without modification of the terms, conditions and notices contained with this product. Use of this product implies acceptance of all such terms, conditions, and notices. If you do not wish to accept these terms, conditions, and notices, please return the Product, unused, in its original packaging and at your own cost and risk to the relevant Customer Care location together with proof of purchase for a full refund.

2. **Proper Use**

Proper Use includes, without limitation, reviewing the entire Product Manual and any specific safety information statements. The specific temperament or size/weight of your pet may not be suitable for this product. If you are unsure whether this Product is appropriate for your pet, please consult your veterinarian or certified trainer prior to use. For products used with pets where training is desired, Radio Systems Corporation recommends that these training products are not used if your pet is aggressive and accepts no liability for determining suitability in individual cases.

3. **No Unlawful or Prohibited Use**

This product is designed for use with pets only. This product is not intended to harm, injure or provoke. Using this product in a way that is not intended could result in violation of Federal, State or local laws.

4. **Limitation of Liability**

In no event shall Radio Systems Corporation or any of its associated companies be liable for (i) any direct, indirect, punitive, incidental, special or consequential damage and/or (ii) any loss or damages whatsoever arising out of or connected with the use or misuse of this product. The Purchaser assumes all risks and liability from the use of this product to the fullest extent permissible by law.

5. **Modification of Terms and Conditions**

Radio Systems Corporation reserves the right to change the terms, conditions and notices governing this product from time to time. If such changes have been notified to you prior to your use of this product, they shall be binding on you as if incorporated herein.

Ci-après, « Nous » peut renvoyer collectivement à Radio Systems Corporation, Radio Systems PetSafe Europe Ltd., Radio Systems Australia Pty Ltd., ainsi qu'à toute autre filiale ou marque de Radio Systems Corporation.

Consignes de sécurité importantes

Description des termes et symboles utilisés dans ce manuel

 Ce symbole est une alerte de sécurité. Sa présence vous avertit d'un risque de blessure. Respectez tous les messages de sécurité qui suivent ce symbole afin d'éviter tout risque de blessure ou de mort.

⚠ AVERTISSEMENT **AVERTISSEMENT** indique une situation dangereuse qui, si elle n'est pas évitée, risque d'entraîner la mort ou des blessures graves.

⚠ ATTENTION **ATTENTION**, utilisé avec le symbole d'alerte de sécurité, indique une situation dangereuse qui, si elle n'est pas évitée, peut provoquer une blessure légère ou modérée.

ATTENTION **ATTENTION**, utilisé sans le symbole d'alerte de sécurité, indique une situation dangereuse qui, si elle n'est pas évitée, peut blesser votre animal.

AVIS **AVIS** indique les pratiques d'utilisation sûres qui ne risquent pas d'entraîner de blessures physiques.

⚠ AVERTISSEMENT

- **N'utilisez pas ce produit si votre chien est agressif ou a tendance à l'être.** Les chiens agressifs peuvent causer de graves blessures, voire la mort de leur maître ou d'autres personnes. Si vous n'êtes pas sûr(e) que ce produit convient à votre chien, veuillez consulter votre vétérinaire ou un dresseur professionnel.
- Ce dispositif contient des piles au lithium-ion (Li-Ion) ; ne jamais les incinérer, percer, déformer, court-circuiter ni les charger avec un chargeur inadapté. Le nonrespect de cet avertissement peut provoquer un incendie, une explosion, des dégâts matériels ou des blessures corporelles.

⚠ ATTENTION

- Le collier anti-aboiements n'est pas un jouet. Gardez-le hors de portée des enfants. Utilisez-le uniquement pour sa fonction anti-aboiements.

The device has been approved for use in EU countries and is therefore provided with the **CE mark**. All necessary documentation is available on the website: www.electric-collars.com
Changes to technical parameters, properties and printing errors reserved.

Service center and distribution

Reedog, sro
Sedmidomky 459/8 101
00 Prague 10
Phone: +1 646 980 4569
Email: info@electric-collars.eu