

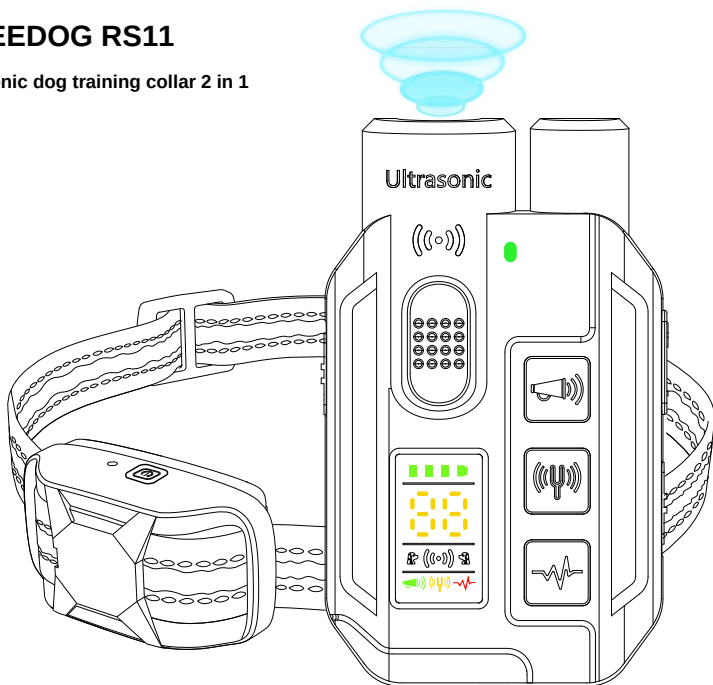

## REEDOG RS11

Ultrasonic dog training collar 2 in 1



# USER MANUAL

MODEL: RS11

# I. Important Safety Information:

## WARNING

Not for use with aggressive dogs. Do not use this product if your dog is aggressive or prone to aggressive behavior. Aggressive dogs can cause severe injury and even death to their owner and others. If you are unsure whether this product is appropriate for your dog, please consult your veterinarian or a certified trainer.

- ◆ **Ultrasonic Sound Warning:** The Remote Transmitter must not be used within 12 inches of human ears when operating in Ultrasonic Mode.
- ◆ For use with dogs over 6 months of age and over 8 lbs.
- ◆ **DO NOT** use when the dog or the collar is wet.
- ◆ **DO NOT** press and hold shock or vibrate for more than 10 seconds to avoid physical or psychological damage to your dog.
- ◆ Your dog **SHOULD NOT WHINE OR PANIC** when receiving stimulation. If this happens, the stimulation level is too high and you need to go back to the previous level and repeat the process.
- ◆ **DO NOT** charge the device near any flammable substances.
- ◆ For dog use **ONLY**. Not for use on children.
- ◆ This is not a toy, and should only be operated by a responsible adult.

## CAUTION

Before your first training, please carefully read and follow the instructions in this manual. The cautions below will help keep your dog safe and comfortable. Millions of dogs are comfortable wearing collars, while some are sensitive to the pressure from the contacts.

- ◆ It is vitally important that you and your dog remain safe while learning during on-leash training. Your dog should be on a strong leash (do not attach the leash to the receiver). The leash should be long enough for your dog to attempt to chase an object but short enough to prevent reaching roads or other hazards. You must also be physically strong enough to restrain your dog when he tries to chase.
- ◆ Risk of skin damage. Proper Receiver fitment is important. A Receiver worn for too long or made too tight on the dog's neck may cause skin damage. Ranging from redness to pressure ulcers; this condition is commonly known as bed sores.
- ◆ **DO NOT** leave the Receiver on the dog for more than 12 hours per day.
- ◆ When possible re-position the Receiver on the dog's neck every 1 to 2 hours.
- ◆ Check the fit to prevent excessive pressure; follow the instructions in this manual.
- ◆ Never connect an extra leash to the Receiver; it will cause excessive pressure on the contacts.
- ◆ Clean the dog's neck area and the Metal Prongs of the Receiver weekly with a damp cloth.
- ◆ Examine the contact area daily for signs of a rash or a sore.
- ◆ If a rash or sore is found, discontinue the use of the Receiver until the skin has healed. If the condition persists beyond 48 hours, see your veterinarian.
- ◆ Receiver Collar meets IP67 waterproof rating, it can be submerged in water up to 1 meter for up to 30 minutes. If submerged and wet, please do not use it.

## II. Package Content

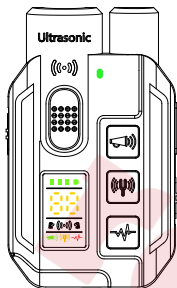

Remote Transmitter



Receiver



User Manual

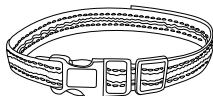

Collar Strap



Metal Prongs



Conductive Silicone Caps



Test Bulb

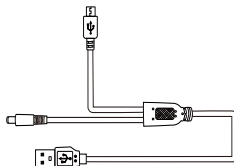

Charging Cable



Wrist Strap

### III. Product Overview

#### Remote Transmitter

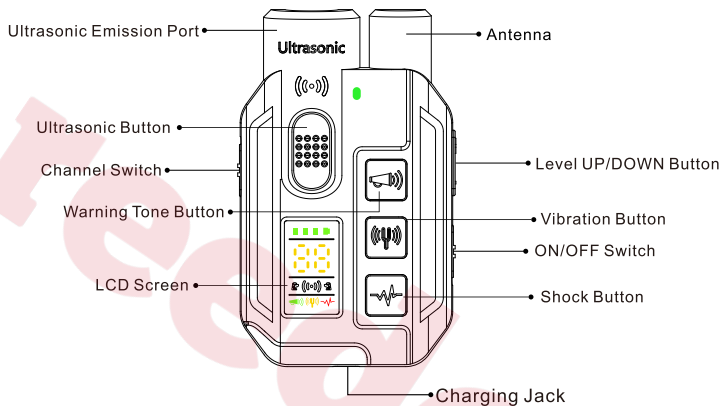

#### LCD Screen

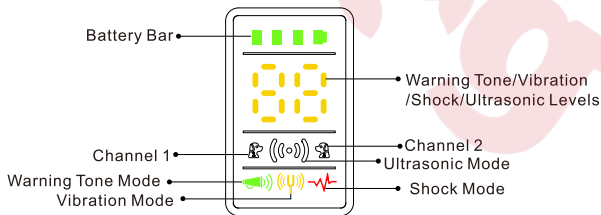

**Note:** The Remote Transmitter will go into sleep mode if no operation in one minute.

# Receiver

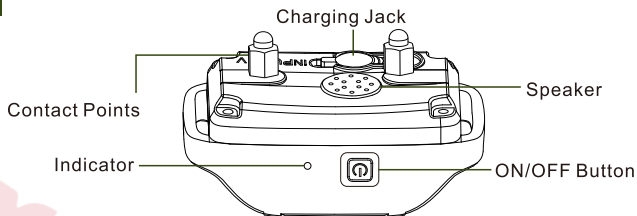

## IV. Quick Start Guide

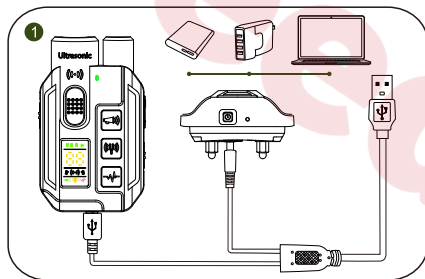

Charge the Receiver and the Remote Transmitter for 2-3 hours with the Charging Cable from the package box.

**Note: The charger, power bank and other charging devices shown in the above picture are not included in the box.**

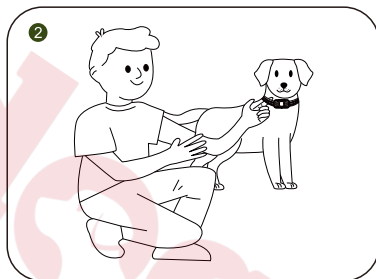

Make your dog sit down and fit the Receiver to your dog by leaving one finger space between the collar and your dog's neck. Center the contact points underneath your dog's neck, touching the skin.

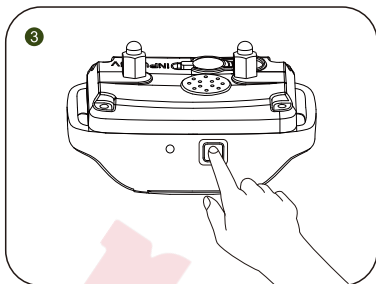

Turn on the Receiver by pressing and holding the Power Button for 2 seconds with a beeping tone and vibration to indicate that the Receiver is turned on. The green Indicator light now continues to blink regularly.

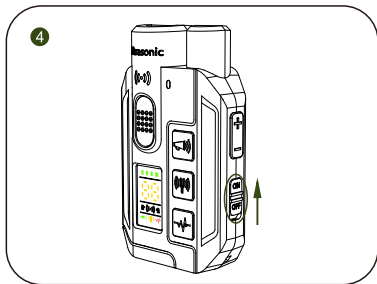

To turn on the Remote Transmitter, slide the Switch to 'ON', and the LCD Screen will light up.



**Ultrasonic Sound Warning:** The Remote Transmitter must not be used within 12 inches of human ears when operating in Ultrasonic Mode.

To adjust the Ultrasonic level, press the Button first, then press the UP/DOWN Button to raise /lower to the desired level.

**Note:** (1) It is suggested to start with Level 1 (Low). If the dog doesn't respond, try Level 2 (Medium) or Level 3 (Strong). The LCD Screen will show the corresponding level number.

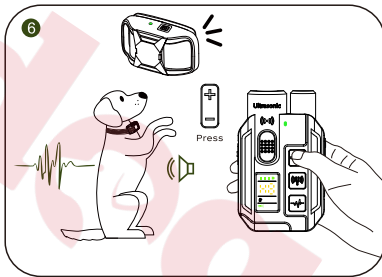

The maximum ultrasonic emission distance is 50 feet. Please use within this range; otherwise, it may not function properly.



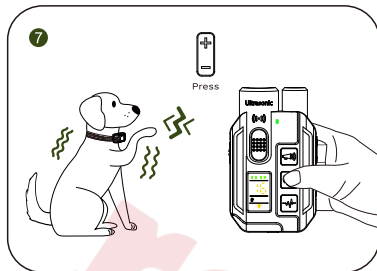

**Warning Tone Command:** Press the Warning Tone Button, and the green indicator light on the Remote Transmitter rapidly lights up. The Receiver will deliver a warning tone, and the green LED indicator light on the Receiver comes up simultaneously.

To adjust the Warning tone level, press the Button first, then press the UP/DOWN Button to raise /lower to the desired level.

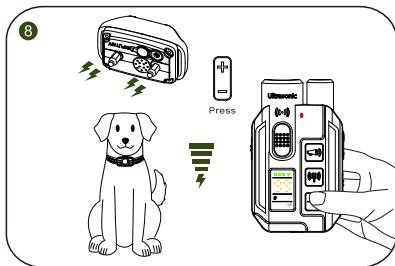

**Vibration Command:** Press the Vibration Button, and the green indicator light on the Remote Transmitter rapidly lights up. The Receiver will deliver vibration, and the green LED indicator light on the Receiver comes up simultaneously. To adjust the Vibration level, press the  Button first, then press the UP/DOWN Button  to raise /lower to the desired level.



**Shock Command:** Press the Shock Button, and the red indicator Light on the Remote Transmitter rapidly lights up. The Receiver will deliver a shock, and the green LED Indicator light on the Receiver comes up simultaneously. To adjust the Shock level, press the  Button first, then press the UP/DOWN Button  to raise/lower to the desired level.

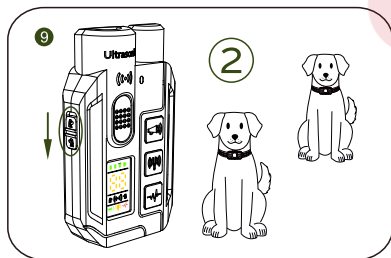

To change the channel, slide the Channel Switch located on the left side of the Remote Transmitter. This product can train up to 2 dogs.

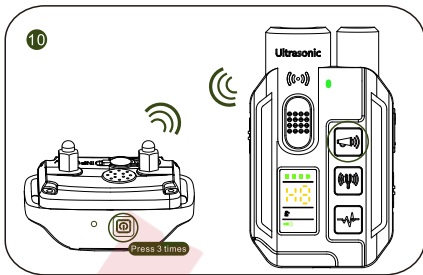

### Steps to pair the Remote Transmitter to the Receiver:

1. Press and hold the Power Button on the Receiver for 2 seconds to turn it on. Turn on the Remote Transmitter by slide the Switch to 'ON' on the Remote Transmitter;
2. Press the Power Button on the Receiver 3 times to enter the Pairing Mode. You will hear a beeping tone and the Indicator becomes solid green. You will now have 10 seconds to finish the pairing;
- Press the Warning Tone Button, Vibration Button, or Shock Button on the Remote Transmitter and Receiver will respond correspondingly indicating that the pairing process is completed. Please refer to "VI. Paring Up" on page 15 for more detail

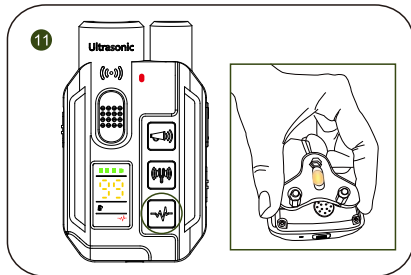

### Test the Receiver with the Test Bulb:

1. Turn the Receiver on.
2. Hold the Test Bulb to the Metal Prongs on the Receiver. Make sure the metal wire in the Test Bulb has direct contact with both of the top of the Metal Prongs.
3. Press the Shock Button on the Remote Transmitter.
4. The Red Test Light will flash if the Receiver works normally. At higher shock levels, the Test Bulb will flash brighter.

**Note:** While you test the Receiver with your fingers, please put your two fingers on the top of the Metal Prongs separately to form a closed loop circle. Please always start from the lowest Shock level to avoid accident hurt.

## How the System Works

The Remote Training Collar is easy to use with an advanced LCD display that tells you the exact stimulation level you are using.

The Remote Training Collar assists you in controlling your dog without a leash. By simply pressing a button, your Remote Transmitter sends a signal to your dog's Receiver or emits an ultrasonic sound that effectively captures your dog's attention. The dog receives a safe but noticeable stimulation.

He'll quickly learn the association between his behavior and your correction, and soon you'll have a better-behaved dog. The Remote Training Collar has been proven safe, comfortable, and effective for both small and large dog breeds.

If using the Remote Training Collar consistently and correctly, any basic obedience commands can be taught and will help correct any misbehavior that your dog exhibits.

## V. Setting Up

### 1. Charge the Product

Charge both the Receiver and Remote Transmitter with the Charging Cable in the package box until their Indicator becomes solid green which will take around 2-3 hours.

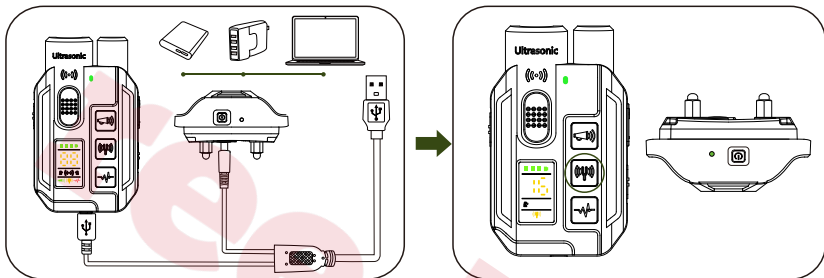

#### Note:

- (1) The charger, power bank and other charging devices shown in the above picture are not included in the box.
- (2) Use the charging cable in the package when charging. Other charging cables may not be suitable for this Dog Training Collar, which may cause electric damage.
- (3) The Dog Training Collar ONLY supports a 5V-rated power source. If charged with an improper charger:  
Receiver Collar—deliver a rapid warning tone and stop charging automatically.  
Remote Transmitter—stop charging automatically with the Indicator rapidly blinking in red.

### 2. Turn On/Off the Product

Turn on the Remote Transmitter by sliding the Switch to 'ON', and the LCD Screen will light up.

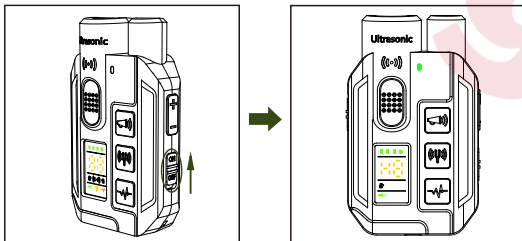

Turn off the Remote Transmitter by sliding the Switch to ' OFF ', and the LCD Screen will shut down.

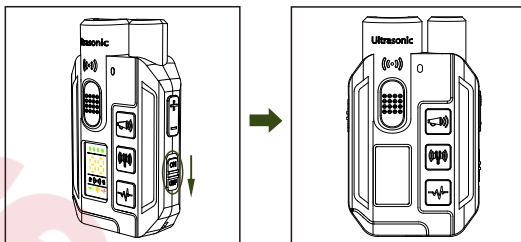

Turn on the Receiver by pressing and holding the Power Button for 2 seconds with a short beeping and vibration to indicate that the Receiver turns on, as the green LED Indicator light blinks regularly.

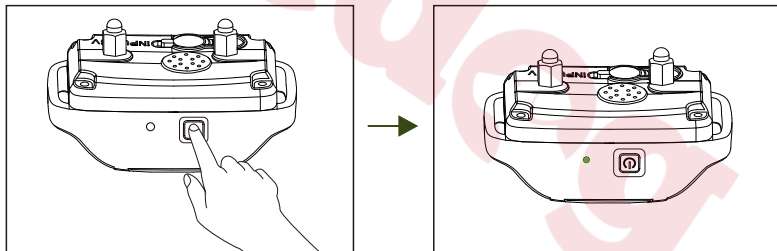

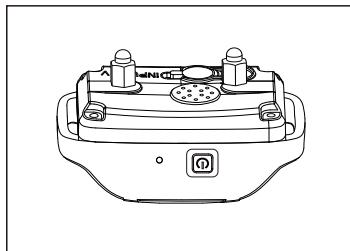
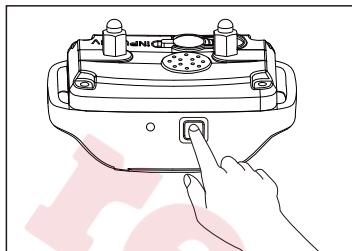

Turn off the Receiver by pressing and holding the Power Button for 2 seconds with a long beeping to indicate that the Receiver turns off, as the green LED Indicator light stops blinking.



## VI. Training Modes

### 1. Ultrasonic Mode

Press the Ultrasonic Button and the Ultrasonic Emission Port will emit an Ultrasonic Sound. It will cut off automatically if you press and hold the Ultrasonic Button for 10 seconds. There is a total of 3 levels of Ultrasonic. To adjust the Ultrasonic level, press the  Button first, then press the UP/DOWN Button  to raise/lower to the desired level.

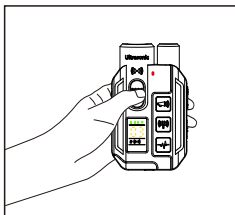

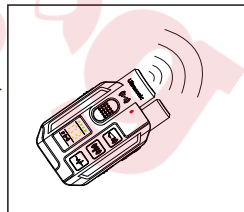

Press



## 2.Warning Tone Mode

Press the Warning Tone Button and the Receiver Collar will deliver a warning tone. It will cut off automatically if you press and hold the Warning Tone Button for 10 seconds. There is a total of 8 levels of Warning Tone for training.

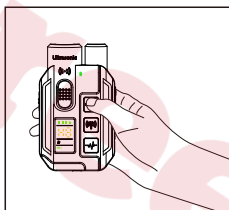

To adjust the Warning tone level, press the  Button first, then press the UP/DOWN Button  to raise/lower to the desired level.

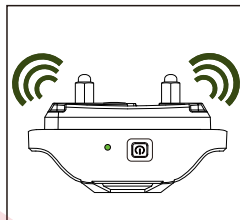

Press



## 3.Vibration Mode

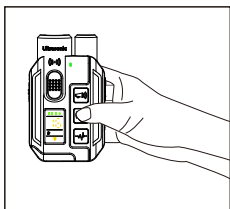

Press the Vibration Button and the Receiver will deliver a vibration. It will cut off automatically if you press and hold the Vibration Button for 10 seconds. There is a total of 16 levels of Vibration. To adjust the Vibration level, press the  Button first, then press the UP/DOWN Button  to raise/lower to the desired level.

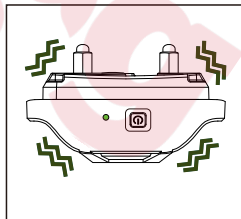

Press



## 4. Shock Mode

Press the Shock Button and the Receiver will deliver a static shock. It will cut off automatically if you press and hold the Shock Button for 10 seconds. There is a total of 99 levels of Shock. To adjust the Shock level, press the  Button first, then press the UP/DOWN Button  to raise/lower to the desired level.

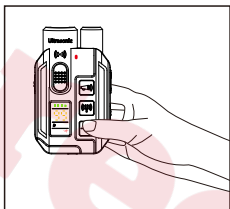

Press

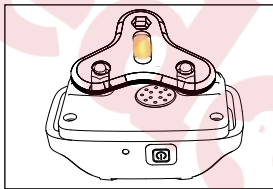
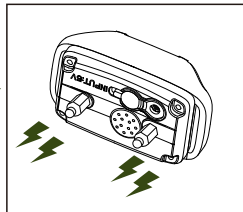

When testing the Shock function for the first time, place the Test Bulb on the Contact Points. The Test Bulb lights up to indicate that the Shock function is working, and it will become brighter at higher shock levels.

## 5. Switching Channels

Use the Channel Switch on the left side of the Remote Transmitter to select the Receiver you wish to control if you have paired two Receivers.

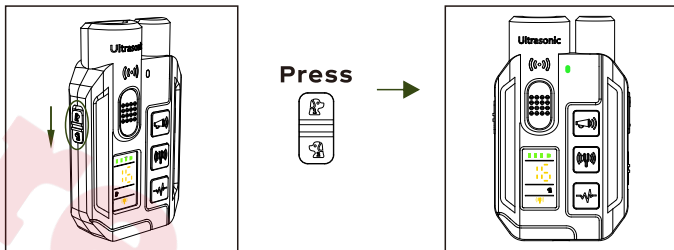

**Note:** The Remote Transmitter will go into the sleep mode if no operation in one minute saving battery power.

## VII. Fitting the Receiver

### IMPORTANT:

The proper fit and placement of your Receiver are important for effective training. The Metal Prongs with Conductive Silicone Caps must have direct contact with your dog's skin on the underside of his neck. To ensure a proper fit, please follow these steps:

1. Make sure that the Receiver is turned off.
2. Let your dog stand on four feet or lay down fully (A).
3. Place the Receiver on your dog's neck close to the ears. Center the Metal Prongs underneath your dog's neck, touching the skin (B).

**Note: It is sometimes necessary to trim the hair around the Metal Prongs to make sure that contact is consistent.**

4. The Receiver should fit snugly, yet loose enough to allow one finger to fit between the strap and your dog's neck (C).
5. Allow your dog to wear the Receiver for several minutes then recheck the fit. Check the fit again as your dog becomes more comfortable with the Receiver.

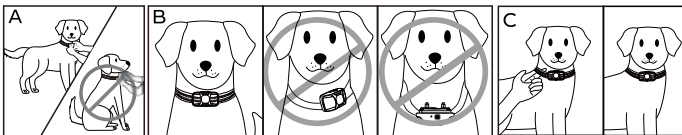

6. To attach the collar to the Receiver, please follow the following steps as instructed to thread the strap.

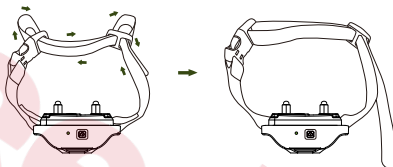

## CAUTION:

- **DO NOT** leave the Receiver on your dog's neck for continuous 12 hours.
- **Never** attach a leash to the collar.
- **Never** fit the Receiver too tight to your dog's neck.
- **DO NOT** shave the dog's neck as this may increase the risk of skin irritation.
- **Check the fit regularly** to make your dog more comfortable with the Receiver.

## VIII. Pairing Up

In case the Receiver is not responding to the Remote Transmitter, follow these steps to pair them up:

1. Press and hold the Power Button on the Receiver for 2 seconds to turn it on. Turn on the Remote Transmitter by sliding the Switch to ' ON ', and the LCD Screen will light up.

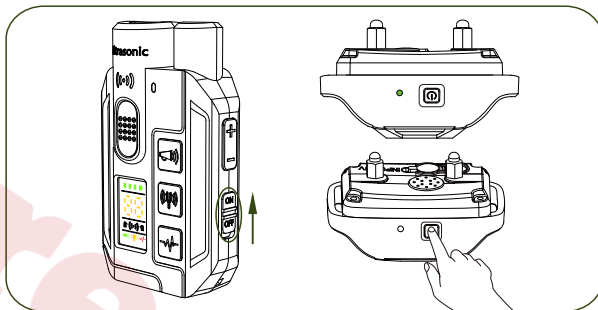

2. Press the Power Button on the Receiver 3 times to enter the Pairing Mode. You will hear a Beeping tone and the Indicator light becomes solid green. You will now have 10 seconds to finish the pairing.

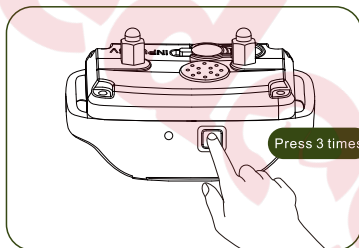

3. Press the Warning Tone Button, Vibration Button, or Shock Button on the Remote Transmitter, and the Receiver will beep 3 times and respond respectively after you press any of the above buttons indicating that the pairing process is completed.

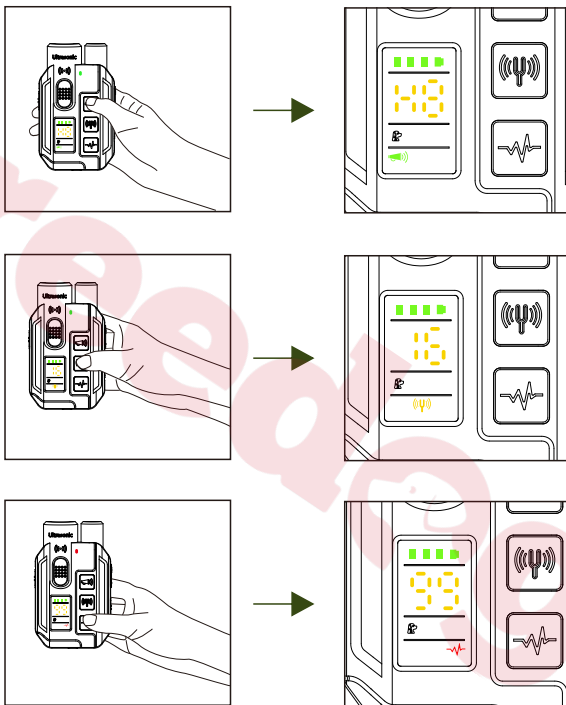





### Tips:



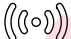

The Receiver is paired up to the Remote Transmitter in Channel 1 by factory default setting. If you buy a new Receiver, you can follow the above instructions to pair it up to Channel 2. The system can pair up to 2 Receivers in 2 different channels. If you can not pair your device successfully, it may be due to signal interference. Please try pairing again in a different location or contact our service center.

## IX. LCD Display & Indicator Definitions

### Remote Transmitter:

	Warning Tone Mode
	Vibration Mode
	Shock Mode
	Ultrasonic Mode
	Level for Warning Tone/Vibration/Shock/Ultrasonic
	Remote Transmitter Battery

### Remote Transmitter Indicator Light:

Charging	The Green Indicator light blinks regularly
Fully Charged	Green Indicator light becomes solid
Press 	The Green Indicator light comes up
Press 	The Green Indicator light comes up
Press 	The Red Indicator light comes up
Press 	The Red Indicator light comes up

## Receiver Indicator Light :

	Slowly blinking indicates the Receiver is on
	Fast blinking indicates the Receiver is on charge
	Faster blinking indicates the Receiver battery is low

## X. Training Tip

### How to find the best stimulation for your dog?

**Important:** Always start at the lowest level and work your way up. The Remote Training Collar has 3 levels of Ultrasonic, 8 types of Warning Tones, 16 levels of Vibration, and 99 levels of Shock. For Ultrasonic and Warning Tones, there are only frequency differences. For Vibration and Shock, level 1 is the lowest; the highest level for Vibration is level 16, and level 99 for Shock. This allows you to choose the Stimulation Level that is best for your dog. Once you have placed the Receiver on your dog, it is time to find the Stimulation Level that is best for him. This is called the Recognition Level.

When using the four modes of training, follow the principle of starting from gentle to strong. Begin with the Warning Tone and Vibration mode, and only use the Ultrasonic mode if necessary. The high-frequency Ultrasonic sound waves provide a strong stimulation to the dog's sense of hearing without causing harm, making it more effective than the Warning Tone and Vibration mode. The Shock mode should be used only as a last resort. Additionally, combining these methods with positive reinforcement, such as rewards and praise, can enhance the training effectiveness. A slight change in your dog's behavior, such as looking around in curiosity, scratching at his collar, or flicking his ears, indicates the Recognition Level that is best for your dog.

### Follow the steps below to find your dog's Recognition Level:

1. Starting at Level 1, press the Warning Tone/Vibration/Shock Button continuously for 1 to 2 seconds.

Note: When the Warning Tone/Vibration/Shock Button is held down for 10 consecutive seconds, the Remote Transmitter will "time out", and you must release and press the button again before additional stimulation can be delivered.

2. If your dog shows no reaction, repeat the Stimulation Level several times before moving up to the next level.
  3. **YOUR DOG SHOULD NOT WHINE OR PANIC WHEN RECEIVING STIMULATION. IF THIS HAPPENS, THE STIMULATION LEVEL IS TOO HIGH AND YOU NEED TO GO BACK TO THE PREVIOUS LEVEL AND REPEAT THE PROCESS.**
  4. Move up through the Stimulation Levels until your dog reliably responds to the stimulation.
  5. If your dog continues to show no response at the highest level of Vibration or Static Shock, check the fit of the Receiver. If your dog has long or thick hair, contact our Customer Care Center to obtain a longer set of Contact Points. Then go back to #1 and repeat the process. If this still does not yield any results, your dog's hair will need to be trimmed around the Contact Points.
- If after completing all of these steps, your dog still does not indicate he is feeling the stimulation, please contact our customer service.

### **How to capture your dog's attention by Ultrasonic Sound?**

Press the Ultrasonic mode to emit an ultrasonic sound that can effectively capture your dog's attention. This will make it easier for them to understand and respond to your training commands. While your dog engages in unwanted behaviors such as barking, jumping, stealing food, or chewing inappropriately, quickly press the Ultrasonic Button. At the same time, give a verbal command like "NO", "QUIET", "SIT", "STAY", or "OFF" to help train your dog to stop the undesired behavior.

**Note:** This feature is specifically designed for dogs. It may not be audible to all humans. Avoid placing it near human ears.

### **How to Maximize the Ultrasonic Transmission Distance?**

1. Choose a clear, open area without shade. Avoid dense woods, buildings, strong winds, and moisture. Limit use in high temperatures and humidity to ensure better transmission.
2. Aim the Ultrasonic Emission Port directly at the dog, keeping it aligned in a straight line.
3. Regularly clean the Ultrasonic Emission Port on the dog training collar to prevent dust and moisture, ensuring optimal ultrasonic sound output.

### **How to Maximize the Wireless Remote Distance?**

Terrain, weather, vegetation, transmission from other radio devices, and other factors will affect the maximum range.

Hold the Remote Transmitter in a horizontal position away from your body to achieve optimum range. For maximum signal strength, keep the device properly charged.



Maximum range



Typical range



Minimum range

\*Avoid touching the antenna or the range may decrease substantially.

## XI. Frequently Asked Questions

### **Q: Is the Stimulation safe for my dog?**

A: While the Stimulation is unpleasant, it is harmless to your dog. Electronic training devices require interaction and training from the owner to achieve desired results.

### **Q: How old does my dog have to be before using the Dog Training Collar Mode?**

A: Your dog should be able to recognize basic obedience commands such as "Sit" or "Stay". Dogs should be at least 6 months old before using the Trainer.

### **Q: Once my dog is trained and has been obeying my commands, will he have to continue to wear the Receiver?**

A: Probably not. You may need to reinforce training with the Receiver from time to time.

### **Q: Is the Receiver waterproof?**

A: Yes. The Receiver meets the IP67 waterproof rating, but make sure to keep the area dry when charging.

**Note: The Remote Transmitter is not waterproof.**

### **Q: Does the Ultrasonic Mode work effectively for all dogs?**

A: The product emits Ultrasonic Sound, may not be effective for old dogs or dogs with hearing problems. Different breeds of dogs react differently to the Ultrasonic Sound. Please use it as a training aid together with verbal commands and be patient during the training process.

### **Q: Will I get a maximum range with the Remote Training Collar?**

A: The range of the Dog Training Collar will vary according to terrain, weather, vegetation, as well as transmission from other radio devices. See "How to Maximize the Wireless Remote Distance?" on page 19 for tips on maximizing your range.

### **Q: How long can I continuously deliver stimulation to my dog?**

A: The maximum amount of time you can press the Warning Tone/Vibration/Shock/Ultrasonic button and deliver stimulation to your dog continuously is 10 seconds. After this, the Remote Transmitter will time out, and these stimulation buttons must be released and pressed again.

### **Q: How do I know if I can use this product for my dog?**

A: The product is designed for healthy dogs over 6 months old. Most importantly, this product cannot be used on unhealthy or aggressive dogs, and if you are unsure whether this product is appropriate for your pet, please consult your veterinarian or a certified trainer.

### **Q: Can I charge this product with any type of charger?**

A: No, you are suggested to charge this product with a charger of 5V output voltage, because a charger with an output voltage over 5V may cause damage to the product. The product will stop charging automatically if the input voltage becomes too high and delivers a warning tone.

## **XII. Trouble Shooting**

### **1. My dog does not respond when I press a button.**

- Make sure the Receiver has been turned on.
- If your range has reduced from the first time you used the Remote Training Collar, the battery(-ies) may be low in either the Remote Transmitter or Receiver.
- Many factors can impact the amount of range. For a list of these factors, see "How to Maximize the Wireless Remote Distance?" on page 19.
- Test the Receiver with the Test Bulb.

**NOTE: If the Test Bulb does not flash, recharge the Receiver and re-test. If the Test Bulb Tool still does not flash, please contact our customer service.**

- Increase the Stimulation Level. Refer to "How to find the best stimulation for your dog" on page 19 for more information.
- Make sure the Receiver's Metal Prongs are placed snugly against your dog's skin. Refer to "Fitting the Receiver" on page 13 for more information.

## **2.The Receiver will not turn on.**

- Make sure the Receiver has been charged. For the initial charge, be sure to charge it for 4 hours. Subsequent charges only take 2-3 hours.

## **3.The Receiver is not responding to the Remote Transmitter.**

- Verify the Receiver is on.
- If the indicator is blinking rapidly, fully charge the Receiver.
- If the first two solutions did not resolve your problems, please check the “Pairing Up” on page 15 to re-pair the Receiver to the Remote Transmitter.

## **XIII. FCC Statement**

### **USA**

This device complies with part 15 of the FCC Rules. Operation is subject to the following two conditions: (1) This device may not cause harmful interference, and (2) this device must accept any interference received, including interference that may cause undesired operation.

### **NOTE:**

This equipment has been tested and found to comply with the limits for a Class B digital device, pursuant to part 15 of the FCC Rules. These limits are designed to provide reasonable protection against harmful interference in a residential installation. This equipment generates, uses, and can radiate radio frequency energy and, if not installed and used in accordance with the instructions, may cause harmful interference to radio communications.

However, there is no guarantee that interference will not occur in a specific installation. If interference does occur to radio or television reception, which can be determined by turning the equipment off and on, the user is encouraged to try to correct the interference by one or more of the following measures:

- Reorient or relocate the receiving antenna.
- Increase the separation between the equipment and the receiver.
- Connect the equipment to an outlet on a circuit different from that to which the receiver is connected.
- Consult customer care, the dealer, or an experienced radio/TV technician for help.

The device has been approved for use in EU countries and is therefore provided with the **CE mark**. All necessary documentation is available on the website: [www.electric-collars.com](http://www.electric-collars.com)  
Changes to technical parameters, properties, and printing errors are reserved.

**Service center and distribution**

Reedog s.r.o.

Sedmidomky 459/8

Praha 10 - Michle, 101 00

Phone: +1 646 980 4569

Email: [info@reedog.eu](mailto:info@reedog.eu)

