

reeduc

600iQ

Owner's Manual

Please read this manual thoroughly
before operating the 600iQ training e-collar.

IMPORTANT SAFETY AND PRODUCT INFORMATION

WARNING

Read all safety and product information below before using Dogtra products. Failure to follow these safety instructions could result in injury to you, your dog, and/or damage to Dogtra products or other property.

PRODUCT SAFETY

Training Methods

Dogtra products can be used with a variety of training methods. However, each dog may respond differently to training methods and Dogtra products. Observe your dog closely when determining the correct training method to use with Dogtra products.

Aggressive Dogs

Do not use Dogtra products on aggressive dogs. Such dogs may react adversely and cause injury to people or other dogs. When dealing with an aggressive dog, seek the help of a dog training professional or veterinarian.

Children and the disabled

Dogtra products are not toys. Adult supervision and extreme caution are required when Dogtra products are used by or near children.

PRODUCT DAMAGE

Electrical Product

Dogtra products include electrical components and batteries. Do not use or store the product near heat or flammable substances. Such use or storage may damage the product or cause fire, explosion, personal injury, or property damage.

Medical Device Interference

Dogtra products contain electrical and magnetic components that emit low levels of electromagnetic radiation and radio frequencies. These electromagnetic waves or radio frequencies may interfere with pacemakers, defibrillators, or other medical devices. Consult your physician or medical device manufacturer before using any medical device with Dogtra products. If you think Dogtra products may interfere with your pacemaker, defibrillator, or other medical device, stop using Dogtra products.

Inadvertent Activation

The digital microprocessor offers thousands of unique codes to eliminate frequency match-up with other Dogtra e-collars. The Constant button will automatically shut down after being held down for 12 seconds or more as a safety feature.

Charging

Only charge Dogtra products with Dogtra Branded batteries and device chargers. Do not charge the product by any other means or at temperatures below 0°C (32°F) or above 45°C (113°F).

Unauthorized use

Dogtra products should only be used in a humane manner to train and educate dogs. Dogtra products are not intended for use in any other way and are not intended for use on other animals or humans.

Battery removal and disposal

Dogtra products include batteries. Be careful when removing or installing the battery as your fingers may be caught. Dispose of batteries according to local regulations. Do not disassemble, crush, heat or modify the battery. Fire, injury or property damage may result.

CONTENTS

AT A GLANCE	39
MAIN FEATURES	40
OVERVIEW	41
UNDERSTANDING YOUR TRAINING SYSTEM	
1. TURNING THE 600iQ ON/OFF	43
2. TRANSMITTER BUTTON FUNCTION	44
3. EXPANDABLE 2-DOG SYSTEM	45
4. HOW TO ADD AN ADDITIONAL RECEIVER DEVICE	46
5. SWITCH IT UP! SWAPPABLE CASE COVERS ..	47
6. HOW TO INSERT THE STRAP	48
7. RECEIVER FITTING	49
8. FINDING THE RIGHT STIMULATION	50
9. NON-STIMULATION CONTACTS	51
10. MAXIMIZING THE DISTANCE	52
11. LED INDICATOR	53
12. BATTERY CHARGE	54
13. ATTACHING THE BELT CLIP	57
14. USING THE TEST LIGHT	58
GENERAL TRAINING TIPS	60
MAINTENANCE	62
TROUBLESHOOTING GUIDE	63
DOGTRA PRODUCT WARRANTY	65

AT A GLANCE

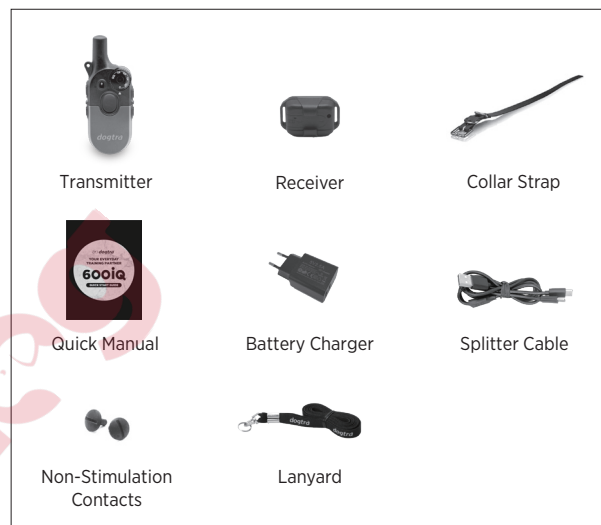

Optional Accessories

Auto Charger

The input of the auto charger for 600iQ is 12V ~ 24V and the output is 5V 2500mA.

To purchase accessories, visit www.dogtra-europe.com or call customer service at +33 (0) 130-62-65-65.

MAIN FEATURES

- Maximum Range 600 metres
- IPX9K waterproof certified transmitter and receiver
- Medium output receiver
- 100 stimulation levels/front-facing Rheostat Dial
- Two stimulation types: Nick & Constant stimulation
- Audible Tone
- LED Locate Light
- XPP (Extreme Performance Pager) Vibration
- Enhanced contact points
- Standard 15mm Male Contact Points
- Ultra-compact receiver
- For dogs as small as 5 kg
- 2-hour rapid charge lithium polymer batteries
- USB C-TYPE Charging
- Expandable to a 2-dog system

OVERVIEW



UNDERSTANDING YOUR TRAINING SYSTEM

1. TURNING THE 600iQ ON/OFF

The transmitter does not have an on/off button and it will only activate when paired receiver is turned on.

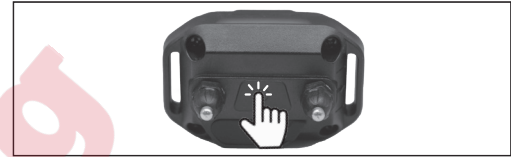

The receiver's collar power button is located between the contact points. Press and hold the power button for 2 seconds to turn it on or off. The LED indicator will display a solid green light accompanied by a tone when the unit powers on, and a red light with a tone when it powers off.

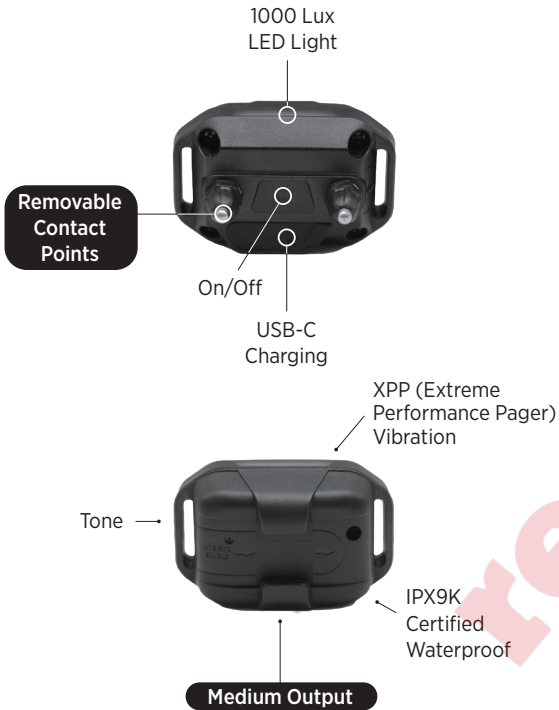

600iQ
Receiver

2. TRANSMITTER BUTTON FUNCTION

The 600iQ multi-dog unit has five buttons (one on the face of the transmitter and two on the left side and two on the right side).



1) Nick

When the Nick button is pressed, the receiver emits a single rapid pulse of static stimulation.

2) Tone

The tone button emits a beeping sound when held, lasting up to 12 seconds maximum.

3) Constant

Constant button emits a continuous stream of stimulation when held, lasting up to 12 seconds maximum.

4) Light

There are two light modes:

- Continuous Beacon Mode:

By tapping the Locate Light button once. Will emit ongoing continuous blinking, every 4 seconds.

To disable the continuous blinking, tap the Locate Light button again.

- Manual Light Mode:

To manually enable the beacon light, press and hold the Locate Light button which emits for up to 12 seconds maximum.

5) Vibration

The pager button emits non-stimulating vibration when held, lasting up to 12 seconds maximum.

3. EXPANDABLE 2-DOG SYSTEM

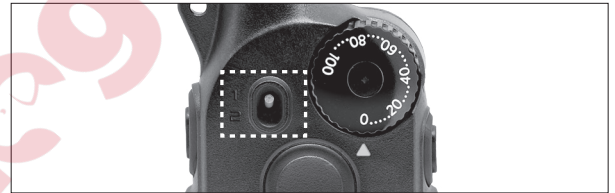

If you purchase an additional receiver, you can use the front toggle switch to select the dog you want to stimulate.

4. HOW TO ADD AN ADDITIONAL RECEIVER DEVICE



1. Set the dial to 0 and place the toggle switch in either position “1” or position “2”. Note: If a collar is already paired, select an unused position to avoid overriding the existing one.



2. To begin pairing, the receiver must be turned off. Initiate the pairing mode by pressing and holding the power button for 5 seconds until the LED starts blinking and then release.



3. While the green LED on the receiver is rapidly blinking, simultaneously press both side buttons on the transmitter (Nick and Constant). Once coding is complete, the LED indicator on the receiver will blink every 4 seconds.

Repeat the pairing process if the pager vibration test is unsuccessful, or if the pairing between the devices has timed out or failed.

5. SWITCH IT UP! SWAPPABLE CASE COVERS

Additional Case Covers are sold separately.

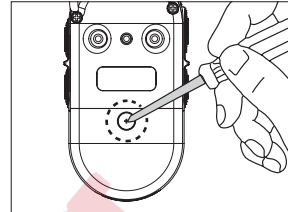

1. Use the phillips #1 screwdriver to loosen the screw. You will need this screw to tighten the case later. Do not loose it

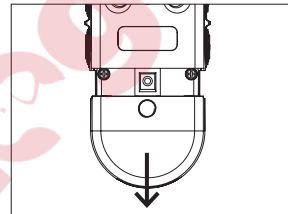

2. Remove the Case Cover by pulling it down.

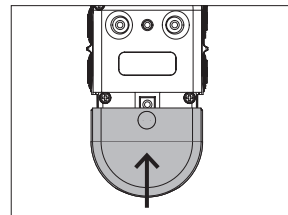

3. Fit the new cover tightly onto the device.

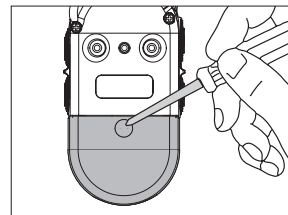

4. Use a phillips #1 screwdriver, and use the screw that you previously removed to tighten the case onto the body.

6. HOW TO INSERT THE STRAP

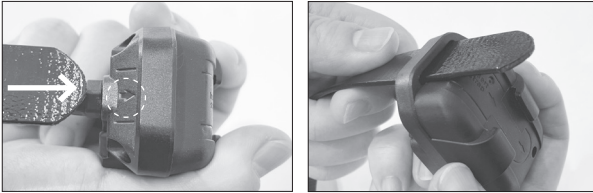

1. Insert the strap by looking at the direction of the arrow on the receiver.



2. Make sure to connect the middle groove of the receiver.

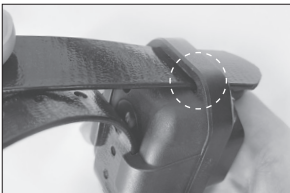

3. Attach the receiver to the strap by threading the strap through the opposite hole.

7. RECEIVER FITTING

Proper Fit

The receiver should be fitted so that the medical grade stainless steel contact points press firmly against the dog's skin. You should be able to fit two fingers underneath the collar strap. The best location is on either side of the dog's windpipe.

Improper Fit

A loose fit can allow the receiver to move around on the dog's neck. When this happens, the contact points may rub against the skin and cause irritation. If the receiver is too loose, the contact will not be consistent and cause the corrections to be inconsistent. Dogtra uses medical grade stainless steel contact points and anti-microbial plastic to protect the dog's skin.

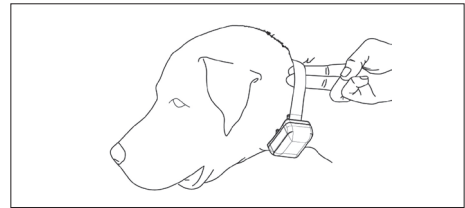

Attention!

Leaving the receiver in the same location on the dog's neck for an extended period of time can cause skin irritation due to the sensitivity from the contact points. If the dog is to wear the receiver for long periods, occasionally reposition the receiver every few hours so that the contact points are moved to a different location on the dog's neck and remove the receiver after 8 hours of usage. Make sure you check for skin irritation each time you use the unit.

8. FINDING THE RIGHT STIMULATION



The 600iQ has a Rheostat Dial on the front of the transmitter (0 is the lowest level and 100 is the highest level). Remember that you will need to adjust the level setting (up or down) depending on your dog's temperament and sensitivity. Always start at the lowest level and work your way up. The appropriate level can be found when the dog responds to the stimulation with a mild reaction. Also, as the dog's attitude changes, especially during times of increased excitement or distraction, you may need to adjust the stimulation level.

NOTE : The stimulation intensity can be adjusted even when the stimulation is in use.

9. NON-STIMULATION CONTACTS



1. Please loosen the contact points and remove them.



2. Place non-stimulation contacts in each place



3. Press non-stimulation contacts to secure the non-stimulation contacts

reedog

10. MAXIMIZING THE DISTANCE

The 600iQ has a maximum range of 600 metres. Depending on the way you use your transmitter, the transmitter range may vary. To get the greatest range, hold the transmitter away from your body and avoid touching the antenna. Keep your unit properly charged for maximum signal strength.

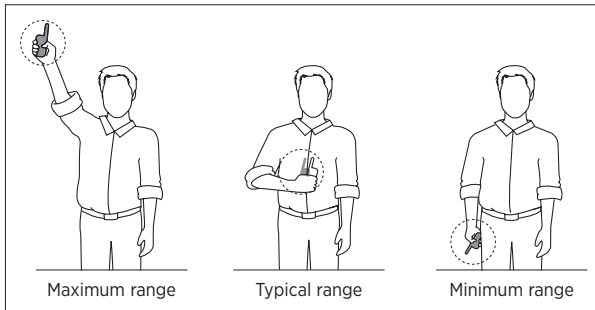

11. LED INDICATOR

The LED indicator flashes every 4 seconds when the receiver is on and ready for use. The LED indicator will blink on both the transmitter and the receiver when the transmitter buttons are pressed.



The LED indicator color indicates the battery life level.

Green = Full charge

Amber = Medium charge

Red = Needs charge

If the unit is used while the LED indicator is red, it may shut down automatically.

Receiver Indicator Light

When the Constant button on the transmitter is pressed, the receiver indicator light will glow steadily (either green, amber, or red based on the remaining battery life), as long as you hold the button down, for up to 12 seconds. When the Nick button is pressed, the light comes on for a fraction of a second.

12. BATTERY CHARGE

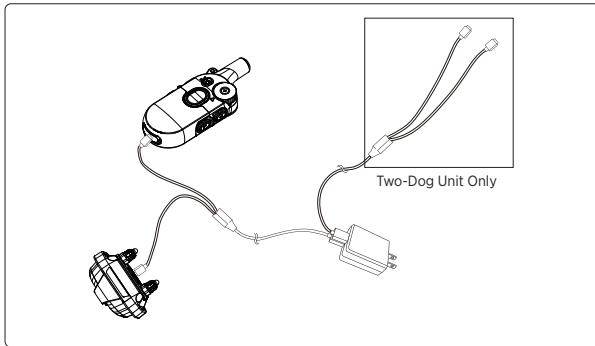

Dogtra 600iQ uses a lithium polymer battery. If the light is red, the device does not turn on, or the system does not stay on when you press the button, recharge the device.

NOTE 1: Use only Dogtra approved batteries, chargers and accessories with the Dogtra e-collar. This will prevent any damage that may occur if you try to use a different charger.

Note 2: The device will be partially charged when leaving the Dogtra facility. When you receive the system, be sure to give it an initial charge of 2 hours before using it for the first time in an area away from flammable materials.

Note 3: When the charger is not in use, unplug it from the power source. If the device will be stored unused for more than 3 months, fully charge the battery.

Follow the steps below to charge your system:

1. Open the rubber plugs on the battery charging receptacles and plug in the charging cable.
2. Plug the charger into a 220-volt wall outlet. If charging in the vehicle, use a USB A to C or USB C to C cable to charge, depending on the type of port available. All indicator lights should glow red when properly connected, and the unit will automatically shut off during the charging process. Once the unit is fully charged and unplugged from the charging cable, you will need to turn the unit on again before use.
3. The lithium polymer battery is fully charged within 2 hours. The lights will stay red during the charging process and turn green once the unit is fully charged.
4. After charging, cover the battery charging receptacles with the rubber plugs.

Recharging is required in the following cases:

- The LED on the transmitter or receiver is red.
- The LED on the transmitter or receiver does not light.
- A low-battery sound occurs when the transmitter or receiver is powered off.

Charger Info

Manufacturer: E-SUN

Manufacturing country: CHINA

Model name: MKC-0502500VT

INPUT: 100-240V-50/60Hz 0.4A

OUTPUT: 5V 2500mA

	<p>The GS mark, which is regulated by German law and recognized worldwide, is a seal of approval for "Geprüfte Sicherheit" (Tested Safety) and means that the product is in compliance with the German product Safety Law.</p>
	<p>The Conformité Européenne (CE) Mark is the European Union's (EU) mandatory conformity marking for regulating the goods sold within the European Economic Area (EEA).</p>
	<p>A Class II or double insulated electrical appliance is one which has been designed in such a way that it does not require a safety connection to electrical earth (ground).</p>
	<p>For indoor use only</p>
	<p>Do not dispose of your product with your household waste. It has to be disposed of in compliance with your local WEEE (Waste Electrical and Electronic Equipment) Regulations.</p>
	<p>A power supply with this marking is in compliance with the global energy efficiency regulations, including the upcoming US Department of Energy's (DoE) Level VI efficiency standard.</p>

13. ATTACHING THE BELT CLIP

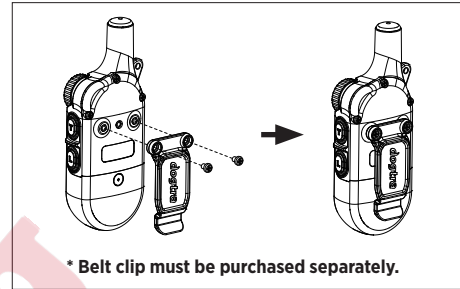

To attach a belt clip, follow the instructions below.

1. Align the belt clip with the groove on the back of the transmitter.
2. Use a screwdriver to firmly tighten the screws of the belt clip.

Caution

Firmly tighten both screws of the belt clip. Be careful not to overtighten.

14. USING THE TEST LIGHT



1. Turn on the receiver by pressing and holding the on/off button in the center of the contact terminal. The receiver's light will briefly turn on and then blink once every 4 seconds to indicate that the receiver is ready to use (if the light is red, the receiver needs to be charged).
2. Turn on the transmitter by pressing and holding the on/off button on the right side of the transmitter. The LED blinks every 4 seconds and the remaining battery life is displayed on the LCD screen. (If the battery icon on the LCD transmitter screen shows only 1 bar, it needs to be charged.)
3. Place the test light onto the contact points as shown. (Test Light is sold separately, available on dogtra.com)
4. Press the Nick button on the transmitter and observe the test light. It should only be on for a moment. (The higher the intensity, the brighter the test light.)

5. Observe the test light while pressing the Constant button on the transmitter. The button should light up as long as you hold it down. However, as a safety feature, if you press the Constant button for more than 12 seconds, the receiver will automatically stop stimulation.
6. Turn the rheostat dial on the transmitter clockwise and then counterclockwise. The test light shines brighter at higher stimulation levels and dimmer at lower stimulation levels.

Note: The test light may not be visible if the stimulation level is set below level ten.

GENERAL TRAINING TIPS

Your dog must know some basic obedience commands before beginning training with the 600iQ. A dog learns by first being shown a command, followed by lots of repetition over an extended period. As the dog becomes proficient at these commands, the trainer can introduce distractions and different locations to strengthen them.

Obedience Training on the Leash

Your dog must fully understand the obedience commands (sit, stay, here, heel, and kennel) before using the e-collar for reinforcement of these commands. A leash attached to a standard collar is used to "teach" the dog the basic obedience commands (sit, stay, here, heel, and kennel). A tug on the leash/collar is used to reinforce the command. When the dog complies with the command, use positive reinforcement/praise. Once the dog understands these commands, the e-collar can be used to reinforce them.

Beginning E-Collar Training

When you feel your dog understands the obedience commands on the leash we can now start with the e-collar training. With the dog on the leash and wearing the e-collar, continue with your obedience drills. Apply light stimulation (Nick or Constant) when a command is given; the stimulation can be removed as the dog complies. Through repetition, the dog learns to perform the command.

The final step is the avoidance phase in which the dog learns that he can avoid the stimulation altogether by performing your commands. When these training

procedures are complete, the e-collar is used as a reminder when the dog does not comply with your commands at home or in the field. Keep your initial training sessions short and positive as dogs have a short attention span.

How Much Stimulation to Use

Always start with low levels of stimulation and work your way up depending on the disposition of your dog and the given situation. By using the correct amount of stimulation to get your point across, you will have a more controllable environment and a dog that is under less stress. Animals (and humans) perform better in a less stressful environment.

For more training information, please consult with a professional dog trainer

MAINTENANCE

Basic Maintenance

Make sure the rubber charging cap is securely in place when the system is in use. After each training session, carefully inspect the unit for any missing parts or damage to the casing. Damaged or broken casing may affect the waterproof guarantee on the unit. After confirming that there is no damage to the casing, rinse the receiver and clean out any dirt or debris.

Storage Maintenance

The unit should be fully charged before storing for extended periods. While in storage, the unit should be given a full charge once a month and before the first use. Store the units in at room temperature. Do not keep the units exposed to extreme climates.

Troubleshooting

If the unit is malfunctioning, please refer to the "Troubleshooting Guide" before sending it to Dogtra for service. If you have any questions or concerns, you may email them to info@dogtra-europe.com, or call customer service at +33-130-62-65-65.

TROUBLESHOOTING GUIDE

1. My dog is not reacting to the system.

- Make sure the receiver and transmitter are on.
- Make sure the collar strap is tight enough so both contact points are touching the dog's skin.
- The contact points may be too short for your dog's thick or long coat. You might need to trim down the hair on the dog's neck, so both contact points are touching the skin.
- The intensity level may be too low for your dog. Keep increasing the stimulation until the dog responds usually by neck movement, head shaking, looking over his shoulder, etc. (response may be very subtle so pay attention.)

2. The LED indicator light comes on, but I do not feel any stimulation.

- The battery may be low, so check the LED light for battery life.

3. The transmitter has no range or stimulation is less when the dog is farther away.

- The antenna(s) may be damaged. To order parts, please contact customer service at +33-130-62-65-65 or go to www.dogtra-europe.com.
- The range indicated on the unit's box is for flat terrain. Heavy brush, trees, hills, or moisture will affect the range of your unit. For best range, hold the transmitter vertically above your head, and/or try moving to higher ground.
- Any electrical conductors will affect the range, such as cars, chain-link dog runs, metal structures, and radio towers. For best results, operate away from these objects.

4. My units are not holding a charge.

- The batteries might not be charged properly, or the charger, splitter, and the charging port may not be functioning properly. You can send in your charging units to have us inspect them.
- The charging pin may be damaged. Inside the charging port, there is a metal pin that should be standing straight up and stiff. If the pin is wobbling, broken, or missing, you will need to send the unit in to the Repair Department. The charging port must be clean prior to charging; clean the dirt out with a cotton swab and some rubbing alcohol. If the dog is in saltwater, be sure to rinse the receiver and charging port with clean water.
- If the above does not resolve your issues, contact Dogtra customer service at info@dogtra-europe.com or +33-130-62-65-65.

5. My dog has skin irritation.

- This may be due to an improper fit or from wearing the unit too long. If your dog exhibits signs of skin irritation, consult with a veterinarian. Once the dog's skin returns to a normal condition, continue to use the receiver and check your dog's neck each time you use the unit.

DOGTRA PRODUCT WARRANTY

LIMITED WARRANTY

For Dogtra Products Purchased from Dogtra Authorized Dealers

Two-Year Limited Warranty

Dogtra-Europe provides the original purchaser with a 2-YEAR LIMITED WARRANTY for the products sold by Dogtra-Europe and its authorized distributors/retailers. The warranty begins from the date of the original purchase. The replaceable batteries of YS100, iQ No Bark Collar, iQ CLiQ and BALL TRAINER are not covered by Warranty.

* The cost of shipping products under warranty back to Dogtra-Europe is the customer's responsibility. Dogtra-Europe will provide/pay (via regular ground service) the shipping cost back to the customer. Any expedited shipping service will be at the customer's expense. If a repair is not covered by warranty, the cost of Parts, Accessories, Labor fees, and Shipping fees incurred are the customer's responsibility. Labor fees will be variable depending on the extent of the work required.

To Qualify for the Dogtra Warranty

A proof of purchase is required to initiate repair work under warranty. We strongly recommend keeping the original receipt.

Not Covered Under Warranty

Dogtra-Europe DOES NOT cover the cost of repairs and replacements due to misuse by the owner or dog, improper maintenance, and/or lost units. Any water damage on the Water Resistant Transmitters of the Dogtra 175NCP, 180NCP, 200NCP, 400NCP, 410NCP, iQ PLUS, iQ CLiQ and BALL TRAINER and the Water Resistant Receivers of the RRS, RRD, RR Deluxe and BALL TRAINER, will not be covered. All replacement costs for either the transmitter or receiver will be

WARRANTY AND REPAIR INFORMATION

66 67 the owner's responsibility. The warranty does not cover failure resulting from damage, abuse or loss of parts. The warranty is void if the unit has been altered or an unauthorized person has damaged the unit while attempting repair work. Battery replacement by the customer during the warranty period is not recommended. If the customer chooses to replace the batteries, any damage to the unit during the change-out by the owner will void the warranty. The removal of serial numbers from any Dogtra products will void the warranty. Dogtra reserves the right to retain and discard any parts or accessories that have been found damaged upon replacement and repair.

Out of Warranty Repair Work

For repair work that is no longer covered by warranty, the cost of repair will include parts, labor and shipping. The owner will be informed about the repair costs before the product is repaired. Write a note briefly explaining the problem. Include your name, address, city/zip code, phone number and email address. Procedure for Repair Work If the unit is malfunctioning, please refer to the “Troubleshooting Guide” in the Owner’s Manual and contact customer service by phone at +33 (0)1 30 62 65 65 or by email at info@dogtra-europe.com, for technical support, before sending it to Dogtra-Europe for Service. The cost of shipping products under warranty back to Dogtra-Europe is the customer’s responsibility. Dogtra-Europe is not responsible for units damaged or lost in transition to Dogtra. Dogtra-Europe is not responsible for loss of training time or inconvenience while the unit is in for repair work. Dogtra- Europe does not provide loaner units or any form of compensation during the repair period. A copy of the sales receipt showing the purchase date is required before warranty work is initiated. Please include a brief explanation outlining the problem and include your name, address, city/state/zip code, daytime phone number, evening phone number, and email address. If the repair costs are not covered under warranty, we will call you for payment information and authorization. For any questions concerning your Dogtra products, call us at +33 (0)1 30 62 65 65, or email us at sav@dogtra-europe.com.

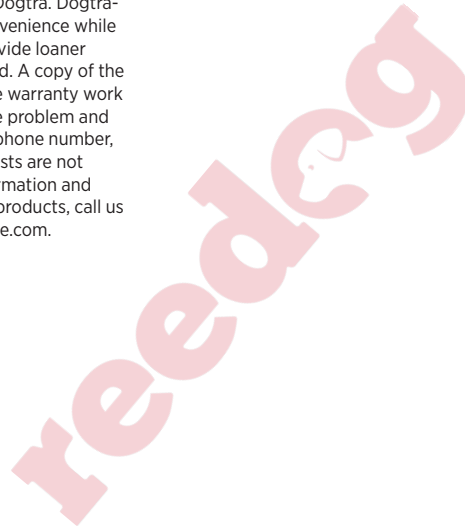

**Send repair units to
Dogtra-Europe
12-14, Rue Augustin Fresnel
78310 Coignières, FRANCE**

The diagrams and representations in the manual may differ slightly from the actual product depending on the model type.

EU DECLARATION OF CONFORMITY

1.Product model: TD50UT

2.Name and address of the manufacturer or his authorized representative:

DOGTRA EUROPE

12-14 Rue Augustin Fresnel, 78310 Coignières, FRANCE

3.This declaration of conformity is issued under the sole responsibility of the manufacturer.

4.Object of the declaration:

Equipment : DOG TRAINING DEVICE

Brand name : DOGTRA

Model/type : TD50UT

Family Model : 200iQ 1-DOG UNIT, 200iQ 2-DOG UNIT, 600iQ 1-DOG UNIT, 600iQ 2-DOG UNIT, 800iQ 1-DOG UNIT, 800iQ 2-DOG UNIT, 200iQ SPECIAL EDITION, 200iQ SE, TOM DAVIS EDITION 200iQ, TD200iQ

Frequency Band(s) : 27.195 MHz

Output Power : 17dBm(±1dBm)

5.The object of the declaration described above is in conformity with the relevant Union harmonization legislation:

Radio Equipment Directive (RED) 2014/53/EU

Electromagnetic Compatibility Directive (EMC) 2014/30/EU

Low Voltage Directive (LVD) 2014/35/EU

6.References to the relevant harmonized standards used or references to the other technical specifications in relation to which conformity is declared:

RED	ETSI EN 300 220-1 V3.1.1 ETSI EN 300 220-2 V3.1.1
EMC	ETSI EN 301 489-1 V2.2.3 (2019-11) ETSI EN 301 489-3 V2.3.2 (2023-01) EN IEC 61000-3-2:2019/A1:2021 EN 61000-3-3:2013/A1:2019
EMF exposure	EN 50663:2017
LVD	IEC 62368-1:2018

Signed for and on behalf of DOGTRA EUROPE

Authorized Signatory :



Name/Position : H.K. YANG / CEO Coignières, 28 August, 2025

12-14, Rue Augustin Fresnel, 78310 Coignières, France

T. + 33 (0) 1 30 62 65 65 E. info@dogtra-europe.com W. www.dogtra-europe.com

EU DECLARATION OF CONFORMITY

1.Product model: TD22UR

2.Name and address of the manufacturer or his authorized representative:

DOGTRA EUROPE

12-14 Rue Augustin Fresnel, 78310 Coignières, FRANCE

3.This declaration of conformity is issued under the sole responsibility of the manufacturer.

4.Object of the declaration:

Equipment : DOG TRAINING DEVICE

Brand name : DOGTRA

Model/type : TD22UR

Family Model : 200iQ 1-DOG UNIT, 200iQ 2-DOG UNIT, 600iQ 1-DOG UNIT, 600iQ 2-DOG UNIT, 800iQ 1-DOG UNIT, 800iQ 2-DOG UNIT, 200iQ SPECIAL EDITION, 200iQ SE, TOM DAVIS EDITION 200iQ, TD200iQ, 200iQ ADDITIONAL RECEIVER, 600iQ ADDITIONAL RECEIVER, 800iQ ADDITIONAL RECEIVER, TD200iQ ADDITIONAL RECEIVER

Frequency Band(s) : 27.195 MHz

Output Power : N/A (Receive only)

5.The object of the declaration described above is in conformity with the relevant Union harmonization legislation:

Radio Equipment Directive (RED) 2014/53/EU

Electromagnetic Compatibility Directive (EMC) 2014/30/EU

Low Voltage Directive (LVD) 2014/35/EU

6.References to the relevant harmonized standards used or references to the other technical specifications in relation to which conformity is declared:

RED	EN 300 220-1 V3.1.1 EN 300 220-2 V3.1.1
EMC	ETSI EN 301 489-1 V2.2.3 (2019-11) ETSI EN 301 489-3 V2.3.2 (2023-01)
LVD	IEC 62368-1:2018

Signed for and on behalf of DOGTRA EUROPE

Authorized Signatory :



Name/Position : H.K. YANG / CEO Coignières, 28 August, 2025

12-14, Rue Augustin Fresnel, 78310 Coignières, France

T. + 33 (0) 1 30 62 65 65 E. info@dogtra-europe.com W. www.dogtra-europe.com

EN How to separate the batteries from the units before disposal

1. Remove the collar strap from the receiver.
2. Open the unit case by loosening the screws on its back or front.
3. If necessary, remove the PCB to access the battery.
4. Disconnect or cut the wires linked to the battery and carefully remove the battery.
5. Discard units and batteries separately and according to your local regulations.

⚠ **Warning:** Do not disassemble, crush, heat or otherwise alter any batteries!

DE Angaben zur sicheren Entnahme der Akkumulatoren vor Entsorgung des Gerätes

1. Ziehen Sie das Halsband vom Empfänger ab.
2. Öffnen Sie das Gehäuse, indem Sie die Schrauben auf dessen Vorder-/Rückseite lösen.
3. Entnehmen Sie falls nötig die Platine, um an den Akku zu kommen.
4. Ziehen/durchtrennen Sie die mit dem Akku verbundenen Drähte und entnehmen Sie diesen.
5. Entsorgen Sie Geräte und Akkus getrennt und gemäß der für Sie gültigen Gesetzgebung.

⚠ **Warnhinweis:** Akkus nicht zerlegen, zerdrücken oder erhitzen!

FR Comment retirer les accumulateurs en toute sécurité avant la mise au rebut d'un appareil

1. Retirer la sangle du récepteur.
2. Ouvrez le boîtier en retirant les vis se trouvant sur le côté avant/arrière.
3. Si nécessaire, retirez la carte électronique pour atteindre l'accu.
4. Déconnectez ou coupez les fils reliés à l'accu et enlevez l'accu.
5. Jeter appareils et accus séparément et conformément à votre réglementation locale.

⚠ **Attention:** Ne pas démonter, écraser, chauffer ou altérer d'une quelconque façon les accus!

ES Como quitar las baterías en toda seguridad antes de desechar el aparato

1. Quitar la correa del receptor.
2. Abrir el mando/el receptor quitando los tornillos encontrándose en la frente/ detrás de la carcasa.
3. Si necesario, quitar la placa electrónica para poder quitar la batería.
4. Desenchufar o cortar los hilos vinculados a la batería y quitarla.
5. Deshacerse del aparato y de las baterías separadamente y según la legislación local.

⚠ **Atención:** No desmontar, aplastar, calentar o alterar de cualquier manera las baterías.

IT Come separare le batterie dalle unità prima dello smaltimento

1. Rimuovere la cinghia dal collare ricevitore.
2. Aprire la cassa del ricevitore o del trasmettitore allentando le viti sul retro o sul davanti degli stessi.
3. Se necessario, rimuovere il circuito stampato per accedere alla batteria.
4. Scollegare o tagliare i fili collegati alla batteria e rimuovere con attenzione la batteria.
5. Smaltire le unità e le batterie separatamente e secondo le normative locali.

⚠ **Avvertenza:** non smontare, schiacciare, riscaldare o alterare in alcun modo le batterie!

EN INFORMATION ABOUT BATTERIES CONTAINED IN EQUIPMENT**DE INFORMATIONEN ÜBER DIE IM GERÄT ENTHALTENEN BATTERIEN****FR INFORMATIONS SUR LES BATTERIES CONTENUES DANS L'APPAREIL****ES INFORMACIONES SOBRE LAS BATERIAS CONTENIDAS EN EL APARATO****IT INFORMAZIONI SULLE BATTERIE CONTENUTE NELLE APPARECCHIATURE**

Unit	Model	Battery Type	Chemical System
Receiver	iQ MINI, YS300, E-FENCE 3500	3.7V 200mAh	Lithium-Polymer
Receiver	ARC800(2), ARC800 CAMO	3.7V 280mAh	Lithium-Polymer
Receiver	610(2)C, 640(2)C, YS VIBE, iQ PLUS(DUO)	3.7V 330mAh	Lithium-Polymer
Receiver	YS600	3.7V 440mAh	Lithium-Polymer
Transmitter	iQ PLUS(DUO), iQ MINI, 610(2)C, 640(2)C	3.7V 500mAh	Lithium-Polymer
Receiver	PATHFINDER MINI	3.7V 1300mAh	Lithium-Polymer
Receiver	PATHFINDER	3.7V 2400mAh	Lithium-Polymer
Transmitter	PATHFINDER, PATHFINDER MINI	3.7V 2400mAh	Lithium-Polymer
Receiver	ARC1200(2)S	7.4V 400mAh	Lithium-Polymer
Receiver	3500(2)NCP, RB1000(2), StB-Hawk, 2600(2)T&B, 4500(2,3,4)EDGE	7.4V 500mAh	Lithium-Polymer
Transmitter	ARC800(2), ARC800 CAMO, ARC1200(2)S	7.4V 600mAh	Lithium-Polymer
Transmitter	2600(2)T&B, 4500(2,3,4)EDGE	7.4V 800mAh	Lithium-Polymer
Transmitter Receiver	3500(2)NCP, RB1000(2) BALL TRAINER PRO	7.4V 1000mAh	Lithium-Polymer
Receiver	600(2)M, 400NCP	3.6V 1.26wh	Nickel-MH
Transmitter	600(2)M, 400NCP	4.8V 400mAh	Nickel-MH
Receiver	RR DELUXE	7.2V 750mAh	Nickel-MH
Transmitter	RR DELUXE	7.2V 400mAh	Nickel-MH

EN



This symbol on the product or on its packaging indicates that this product must not be disposed of with your household waste. It is your responsibility to dispose of your waste equipment by handing it over to an authorized collection point for the recycling of waste electrical and electronic equipment. In most EU Member States, consumers may also return waste equipment to the retailer when buying a new one (1 for 1 basis). Large retailers (with sales area dedicated to selling electronic equipment over 400m²) should also allow consumers to return small WEEE (products having no external side bigger than 25cm) without a new product purchase obligation (1 for 0 basis). For more information about where you can drop off your waste equipment for recycling, please contact your local authorities.

ES



Este símbolo en el producto o en su envase indica que no debe eliminarse junto con los demás residuos domésticos. El usuario se deberá responsabilizar de reciclar el equipo usado transportándolo a un punto de recogida autorizado para el reciclaje de residuos de aparatos eléctricos y electrónicos. En la mayoría de los Estados miembros de la UE, los consumidores pueden devolver los residuos al minorista a cambio de adquirir uno nuevo (1 por 1). Los grandes minoristas (con áreas dedicadas a la venta de equipos electrónicos cuya superficie supere 400 m²) deben permitir a los clientes devolver pequeños residuos (productos que no tengan ningún lado exterior más largo de 25 cm) sin obligación de adquirir un producto nuevo (1 por 0). Para obtener más información sobre los puntos de recogida de residuos eléctricos y electrónicos para su reciclaje, póngase en contacto con su ayuntamiento.

IT



Questo simbolo presente sul prodotto o sulla sua confezione indica che il prodotto non può essere smaltito insieme ai rifiuti domestici. L'utente è responsabile di smaltire le apparecchiature dismesse consegnandole al punto di raccolta autorizzato per il riciclaggio dei rifiuti elettrici ed elettronici. Nella maggior parte degli Stati membri dell'UE, i consumatori possono anche restituire le apparecchiature dismesse al rivenditore in cambio dell'acquisto di un nuovo prodotto (1 per 1). I rivenditori più grandi, con area dedicata alla vendita delle apparecchiature elettroniche superiore a 400 m², devono inoltre permettere ai consumatori di restituire prodotti RAEE di piccole dimensioni (con lato esterno non superiore a 25 cm) senza costringere l'utente ad acquistare un nuovo prodotto (1 per 0). Per ulteriori informazioni su dove depositare le apparecchiature destinate al riciclaggio, contattare gli enti della propria città.

The device has been approved for use in EU countries and is therefore provided with the **CE mark**. All necessary documentation is available on the website: www.electric-collars.com
Changes to technical parameters, properties and printing errors reserved.

Service center and distribution

Reedog, sro
Sedmidomky 459/8 101
00 Prague 10
Phone: +1 646 980 4569
Email: info@electric-collars.eu

reedog