

Quick Start Guide

Note: Please visit tractive.com/quick-start to read the online version of the Quick Start Guide.



1

Charge your Tractive GPS tracker

Attach the tracker on the magnetic battery side to the charger provided. The LED on the tracker will turn red while the battery is charging.

Once the battery is fully charged, the red light will disappear. Pull slightly to remove the tracker from the charging cable. Before first-time use, please charge the tracker at least 2 hours. The tracker is automatically turned on after charging.

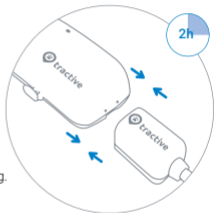

Note: Do not use a fast charger to charge the device, as this could damage the battery.



2

Turn on the Tractive GPS tracker

The power button on the side is used to turn the tracker on and off and to check its LED status.



ON/OFF: Press button for 3 seconds.

LED Status: Press button for 1 second.
The LED will **blink twice**.*

- * ●● Network connected - GPS available
- No network - GPS available
- Network connected - no GPS
- No network - no GPS

3

Download the Tractive GPS app

Download the Tractive GPS app from the Apple App Store or the Google Play Store. You can also visit my.tractive.com to track your pet.



4

Activate your Tractive GPS tracker

Follow the instructions in the Tractive GPS app or at my.tractive.com to activate your tracker. The 8-character Tracker ID can be found on the back of your tracker.

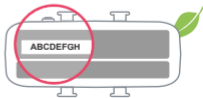

5

Attach your Tractive GPS tracker to your pet's collar

- a) Remove your pet's collar and continue according to the collar width.
- b1) **Collar width: 1.5 cm or less -**
Remove the rubber clip, put the collar through the two rectangular holes on the sides of the rubber clip and fasten the rubber clip on the tracker again.
- b2) **Collar width: 1.6 cm or more -**
Open the rubber clip on one side of the tracker, place the collar in between the rubber clip and the tracker and close the rubber clip again.
- c) Put the collar back on your pet and you are ready to go!

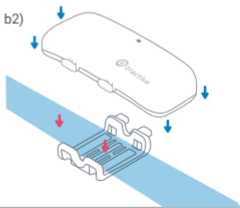
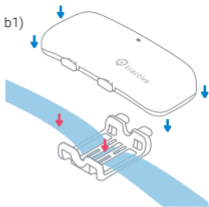

Happy Tracking!

?

Need more information?

Visit [tractive.com/help](https://www.tractive.com/help)

