

# Smart Dog Bark Control Collar

Read and fully understand this manual before use

## Important Safety Information



Variable Tone



Vibration



Variable Tone +  
Vibration



Variable Tone+  
Vibration+Shock



NOT for  
aggressive dogs!



For dogs over 6  
months and weight  
more than 11 pounds



Keep out reach of Children!  
For DOG use only!

## Product Information



Bark Collar



User Manual

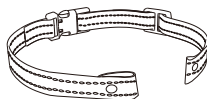

Strap



Metal Prongs



Prong Covers

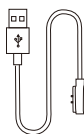

Magnetic Charging Cable

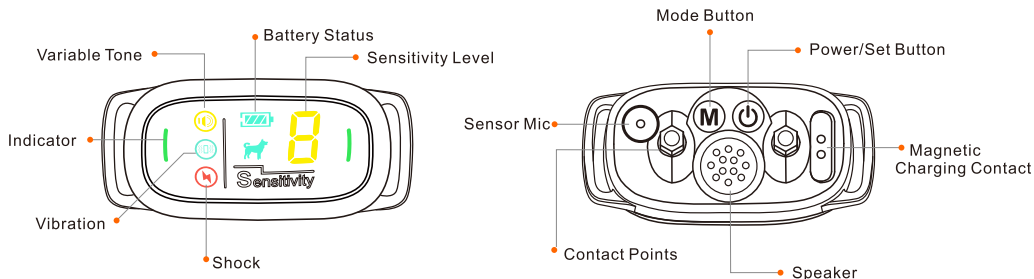

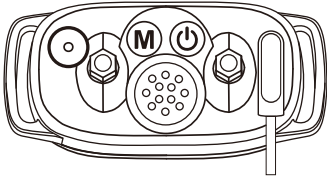

## 1 Test The Product

### 1A. Charge the Bark Control Collar before use



You can charge the product via PC, Power Bank or Charger with output voltage of 5V for 2-3 hours.

#### Description of Charging

-  When Product is on charge, battery bar blinks from left to right and 2 indicators blink fast.
-  When product is fully charged, battery bar stop blinking and 2 indicators becomes solid.
-  A warning tone will be delivered if product is on charge with a improper charger.

#### Notes:

- 1.Improper charger means one with output voltage over 5V, which can usually be seen on the surface of it.
- 2.Use the magnetic charging cable in package, other magnetic charging cable may not be suitable for the product and may cause electric damage.

### 1B. Power on the Bark Control Collar

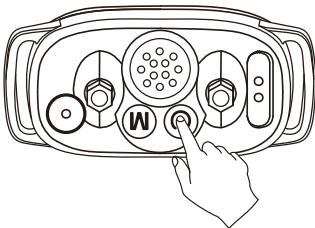

Press and hold the Power Button for 2 seconds to power it on



- Display will turn on and 2 indicators starts to blink slowly

### 1C. Set the Bark Control Collar to Test Mode, the display will show digit 0. After that, imitate a dog bark towards the sensor Mic located at the back of the product.

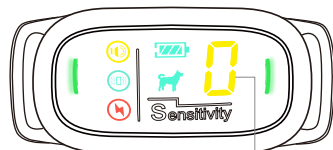
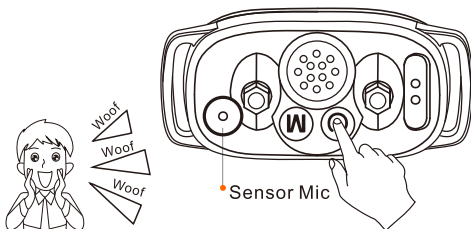

- Press the power button to get to the Test Mode, make sure the digit shows 0 before test

## 1D. The Bark Control Collar responds at Test Mode:



When the product is set on Test Mode, it will deliver tone, vibration and static shock after you imitate dog bark towards the sensor Mic whichever function icons are on.

Note: The hexagon hole on the Test Bulb Tool can be used to fasten or unfasten the Probes to the Contact Points.

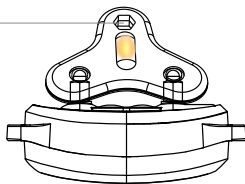

Hold the Test Bulb Tool on the contact points when test the shock function.

If the product responds as described above, you've succeeded at setting up the Bark Control Collar properly.

## 2 Put the Product on Your Dog

Note: have a look if you have a small dog!

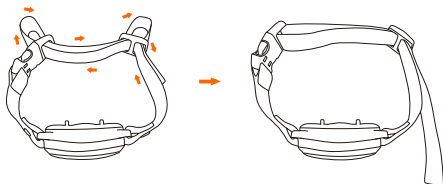

Please ensure to fit the product snugly, yet loose enough to allow one finger to fit between the strap and your dog's neck.

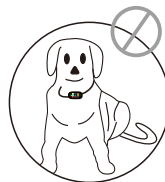

If the product responds as described above, you've succeeded at setting up the Bark Control Collar properly.

## 3 Mode Setting

The following instruction will guide through the process of switching modes.

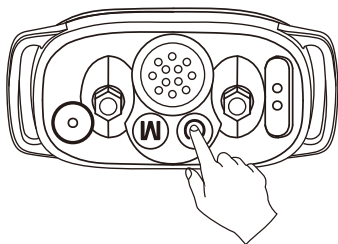



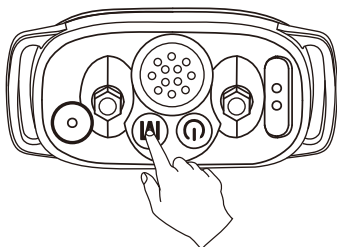

- 1 Power on the product by pressing and holding the Power Button for 2 seconds



- 2 Press the Mode Button to switch modes, mode icons will be changed according in display

- 3 4 Modes:

 <p><b>Variable Warning Tone Mode</b> 6 variable warning tone of different frequency in 6 steps</p>	 <p><b>Vibration Mode</b> 3 level vibration in 3 steps</p>
 <p><b>Variable Warning Tone+ Vibration Mode</b> 6 variable warning tone+3 levels of vibration working collaboratively in 6 steps</p>	 <p><b>Variable Warning Tone+ Vibration Mode+Shock Mode</b> 6 variable warning tone+High level vibration+ 6 level Shock working collaboratively in 6 steps</p>

## 4 Indicator & Display

### Mode Icons



Warning Tone



Vibration



Shock

### Battery Icon



Battery bar indicates battery levels

### Protection Mode



Product is in 30 seconds of protection period

### Test Mode



When the product is set on Test Mode, the digit shows 0 and will shows 5 after test completed or if test is not conducted within 5 seconds.

### Sensitivity Level



Adjustable sensitivity level from 1-5, with level 5 is the most sensitive and level 1 the least

### Indicators



Blinking Fast: product is on charge



Blinking Slowly: product is in standby



Blinking Alternately: battery is low



Become Solid: product is fully charged

## 5 How It Works



Variable Warning Tone



Vibration



Shock

1

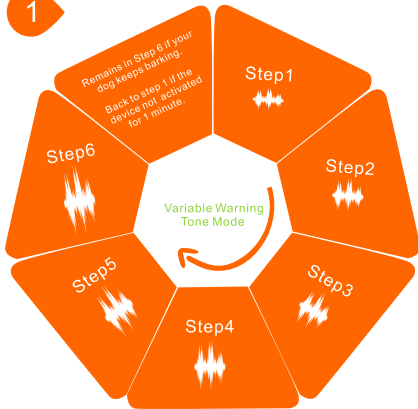

2

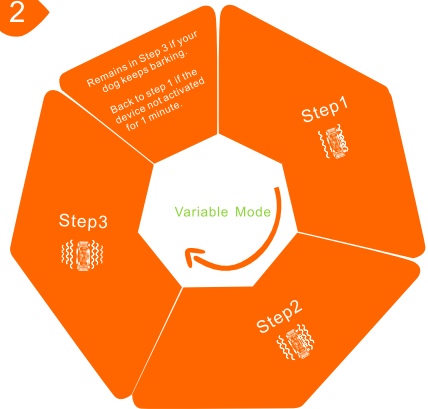

3

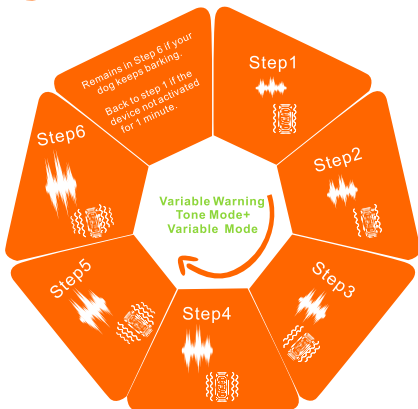

4



### NOTES:

The product will go to next step if your dog keeps barking within 1 minute. Will automatically back to Step 1 if the product is not activated within 1 minute.

## 6 Frequently Asked Questions Answers

### Q: Why doesn't the product work when the dog barks?

A: Please first ensure to fit the product snugly, yet loose enough to allow one finger to fit between the strap and your pet's neck. Some dogs has weak barking, in this case you will need to level up the sensitivity level. Thick coat on the neck area may also have small chance to decrease the sensing from the barking, trim the coat near the area where you place the product.

### Q: Why is the product triggered sometimes in a noisy environment though the dog isn't barking?

A: Though we have optimized the barking detection to the best, some environment noises may have similar frequency to barking, which may have small chance to activate the product. Please lower the sensitivity level.

### Q: Can I use the product when there are other dogs playing around?

A: Dogs will bark when playing and get excited, for the comfort and safety of your pet, we don't suggest using this product in such environment.

### Q: How do I know if I can use this product for my pet?

A: The product is designed for healthy dogs over 6 months old, weighing no less than 8 pounds.

Most importantly, this product cannot be used on unhealthy or aggressive dogs, and if you are unsure whether this product is appropriate for your pet, please consult your veterinarian or a certified trainer.

### Q: Can this product stop my dog's howl?

A: No, this Bark Control Collar is designed to detect the barking only. It cannot detect or stop the howling.

### Q: Can I charge this product with any type of charger?

A: No, you are suggested to charge this product with charger of 5V output voltage, because charger with output voltage of 9V or 12V may cause damage to the product. The product will stop charging automatically if input voltage becomes too high and the power indicator turns red.

### Q: Will my dog stop barking completely?

A: The Bark Control Collar effectively and humanely stops all barking when it is worn. It should only be worn during periods of unwanted barking.

### Q: Is the Bark Control Collar safe and humane?

A: Yes. The Bark Control Collar is designed to get your dog's attention, not to punish him. However, the initial Static Shock correction may startle your dog.

Model: S1    Version: 1.0  
Made in P.R.C

The device has been approved for use in EU countries and is therefore provided with the **CE mark**. All necessary documentation is available on the website: [www.electric-collars.com](http://www.electric-collars.com)  
Changes to technical parameters, properties and printing errors reserved.

**Service center and distribution**

Reedog, sro

Sedmidomky 459/8 101

00 Prague 10

Phone: +1 646 980 4569

Email: [info@electric-collars.eu](mailto:info@electric-collars.eu)