

Smart Bark Control Device

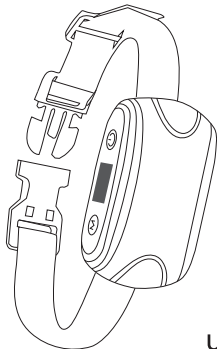

B300
User's Manual

QUICK REFERENCE GUIDE

1. Install the battery and contact points

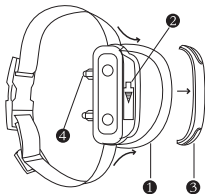

- ① Release the dog collar.
- ② Remove the battery cover, put in the battery and then install the battery cover.
- ③ Install the panel.
- ④ Screw on the contact points and silicone caps.

2. Attach the product

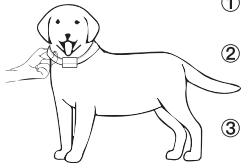

- ① Put the product at the vocal cords place of the dog.
- ② Adjust the tension of the collar properly (to the extent that one finger can be inserted).
- ③ Ensure that the collar just touches the dog skin.

3.The product has been pre-set to the automatic mode ,so that it can work normally upon power-on after being attached to the dog properly.

4.Adjust the sensitivity level and fixed function level

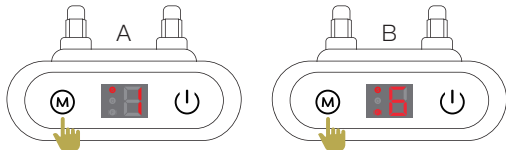

A.The product has been pre-set to the sensitivity level “S” by default before delivery. To adjust the sensitivity level, you may press the **M** button once. It is easier to activate the sensitivity level “S” than “G”.

B.The product has been set to the automatic mode by default . If a certain function level is ideal for your dog, you may activate the fixed mode.To this end, press and hold the **M** button until the desired function level is done. Afterwards, the current fixed function level will be displayed on the screen.

PRODUCT INTRODUCTION

1. Sensitivity level "S"
2. Sensitivity level "G"
3. "F" symbol on: fixed mode is activated
4. "F" symbol off: automatic mode is activated
5. Function level indication
6. P: protection mode
7. L: low battery indication
8. Mode button
9. Power button

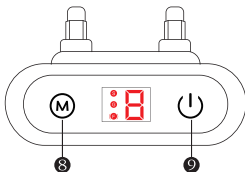
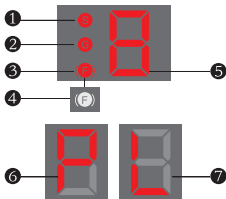

PACKING LIST

- 1.Bark control device
- 2.Collar
- 3.One-pair-of contact points
- 4.One-pair-of silicone caps
5. Static stimulation test light
- 6.User's Manual

OPERATION

1.Power-on and power-off

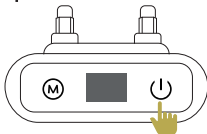

- Power-on: Press and hold the power button.
- Power-off: Press and hold the power button.
- Stand-by: The device enters the stand-by mode and the screen is off if no operation carried out within 60 s.

2.Functions

- **Selection of sensitivity level: press the mode button (M) on the to select the desired sensitivity level**

S mode: (by default) triggered easily

G mode: triggered difficultly

(The selection of sensitivity level depends on the operating conditions of the product on your dog. Please set the sensitivity level to “G” in case of frequent false triggering, or to “S” in case of difficult triggering.)

- **Change from fixed mode to automatic mode**

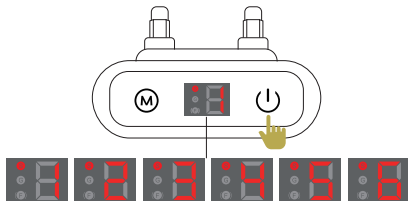

Press the power button (⏻) twice in succession to display number "1" on the screen (the product has been pre-set to automatic mode by default, where the function levels will be cycled from levels 1 to 6 automatically and no letter will be displayed on the screen.)

● Change from automatic mode to fixed mode

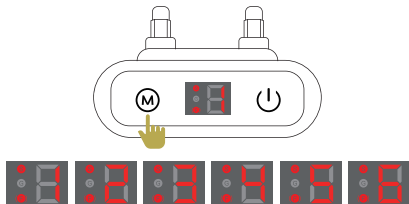

Press and hold the mode button (M) to adjust the function levels from levels 1 to 6, and release the button when the desired fixed function level is done. At that time, the corresponding number LED will be on.

3.Symbol display

1. There are 6 function levels . During the operation, the corresponding function level number flashes on the screen. For example, in static stimulation STEP6, the number “6” flashes on the screen, and the corresponding function symbol “F” is on (it is off in automatic mode) until the dog stops barking.
2. “L” indicates a low battery, which needs to be replaced.
3. “P” means protection mode. Within the range set by the program, triggering for 6 consecutive times will activate the protection mode, where the product will stop working to protect your dog against injury.
4. When “F” symbol is on, the fixed mode is activated (when “F” is off, the automatic mode is activated).

Note:

1. Please replace the battery in time in cases of:
 - A. Poor static stimulation effect.
 - B. The display blinks when the product works at function levels 4, 5 or 6 in fixed mode.

Product assembly and testing

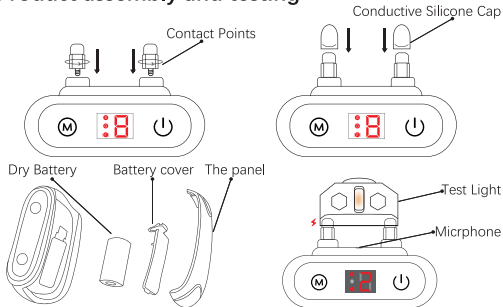

● After installation of new battery, please test if the product works as follows:

Step 1: Press and hold the power button (to turn on the product).

Step 2: Blow air towards the sensor on the back of the product or make a sound similar to bowwow to trigger the product.

Static stimulation test: Activate function level 2 or above

(no static stimulation is generated at function level 1). After the product is triggered, set the static stimulation test light to the contact points. If the test light in yellow, it indicates that static stimulation is generated. (Please try several times since the product will not respond in case of incorrect simulation of actual barking scenario)

ATTACHING METHOD

Correct attaching of the collar is essential for effective operation. To ensure proper attaching, follow the steps below:

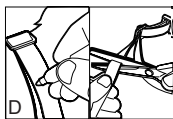
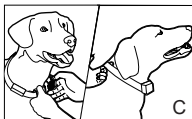
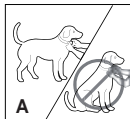



- ① Check that the collar is powered off.
- ② Keep your dog in a comfortable standing position (A).
- ③ Place the collar around the dog's neck with the control ring centered and the collar operating side "on/off" switch facing up (B).
- ④ Check the tightness of the bark control collar by inserting a finger between the collar and the back of the dog neck; the proper position should be comfortable rather than tight. (C)
- ⑤ Allow your dog to wear the collar for a while, and then check the tightness again to make your dog more comfortable. Prolonged or too tight attaching of the collar on a pet may hurt cause the skin due to unnecessary stress, which is often mistaken for a burn.
- ⑥ Trim the collar as follows: (D)
 - A. Mark the desired length of the collar with a pen.
 - B. Remove the collar from the dog, cut off the excess part, and seal the collar with flame along the worn edge.

C.Put the collar back on your dog.

(Tips: Read this manual carefully before use and keep it properly)

- This product applies to dogs with weight of 5KG-50KG and with neck circumference of less than 62CM, rather than dogs at the age of less than 6 months or weighing less than 5KG.
- Do NOT let your dog wear the collar for more than 12 hours a day.
- Do NOT let children play with the product.
Please keep the product out of the reach of children.
- Please check whether the product is positioned properly on the neck of the dog at an interval of about 2 hours, and adjust its attaching position if necessary.
- Please do not attach the leash to the collar of the product directly.
- In stand by mode, press and hold the M button to turn on the display to check the battery level.
- The product has been pre-set to automatic mode and function level 1 (without static stimulation) .
- When the product is not in use, please remove the dry battery.
- The battery which is flat in the product may be removed for continuous operation in remote controls and other similar products.

FAQ

Q:Why does the bark control device not work when the dog is barking?

A:There are many possible reasons why the product does not work when the dog is barking. Users can make simple judgment and analysis based on the following conditions.

1. Please make sure the product is powered and attached correctly. The product should be attached below the throat of the dog.
2. Not all dog barks will trigger the product, because the dog often barks when, for example, giving a greeting to the master. We distinguish these cases through technical means, so that the product is mainly triggered in case of bad or persistent barking.

Q:Is the static stimulation function safe for my pet?

A:The static stimulation function complies with ECMA specification. The electronic training device requires user interaction and training to achieve the desired effect.

Q:Once my pet has been trained and no longer barks disorderly, does it still need to wear the receiver?

A:No. But you can also turn off the device and reinforce the training by continued attaching of the product to your pet.

Q:How to check the battery level?

A:In case of low battery , "L"will be displayed on the screen or the display will blink.

Q:Why will no static stimulation be generated at function level 1?

A:The design aims to let your dog correct the wrong habit (or bad behavior) by progressive correction, rather than simply punish it.

Q:Any after-sales service available for the product?

A:Our product has one-year warranty.

Any product with the quality issue not artificially induced damage, not caused by misuse can be repaired for free.

TROUBLESHOOTING

The product cannot be turned on	Check the power of the dry battery of the product. "L" will be displayed on the screen in case of a low battery.
It seems that the pet is not stimulated	Adjust the position and tension of the collar, ensuring that the contact points come into contact with the dog skin directly; the ideal function and sensitivity levels for dogs vary; in case of inadequate stimulation, you may select the higher function level or change the sensitivity level setting.
The product does not respond to dog barking	The product is set to be triggered by not less than 2 barks within 10 s, therefore it will not be triggered by only one bark.

TROUBLESHOOTING

The button does not work	The button is not pressed properly. Or you may check the power of the dry battery.
The screen blinks	The screen will blink in case of a low battery. In that case, the battery should be replaced in time.
Poor static stimulation effect	Please renew the battery because the poor effect may be due to low battery.
The dog wearing the product does not hear the sound from the product	It is easy for the dog to hear the sound from the product, except in case of improper attaching of the product or in noisy environments. You can trigger the product test function by simulation of dog barking.

PRODUCT MAINTENANCE AND WARRANTY

- 1.If you find a problem with the product within 30 days of receiving it, you need to take a video or picture of the fault. After verification by our customer service department, the product can be returned. The product with quality problems must be returned within 7 days. And upon receipt of the product concerned and the verification, the replacement product will be sent.
- 2.Within the one-year warranty period, the product with a quality problem can be returned by the customer at the cost of freight only. And if the quality problem is verified, we will repair the product for free.
- 3.This warranty is a supplement to any other specified rights and remedies. By law, you are entitled to a replacement or refund for major failures and any other damages if the loss or damage is reasonably foreseeable.
- 4.You also have the right to ask for repair or replacement of the product under the following conditions: the product is of inferior quality and the failure does not constitute a major failure. If you have any questions or need more information, please contact our customer service department.

FCC COMPLIANCE

This device complies with part 15 of the FCC Rules. Operation is subject to the following two conditions:

- (1) This device may not cause harmful interference,
- (2) this device must accept any interference received, including interference that may cause undesired operation.



MADE IN CHINA

The device has been approved for use in EU countries and is therefore provided with the **CE mark**. All necessary documentation is available on the website: www.electric-collars.com
Changes to technical parameters, properties and printing errors reserved.

Service center and distribution

Reedog, sro

Sedmidomky 459/8 101

00 Prague 10

Phone: +1 646 980 4569

Email: info@electric-collars.eu