



protect. **teach.** love.

Outdoor Bark Control

operating guide

Model Number
PBC00-11216

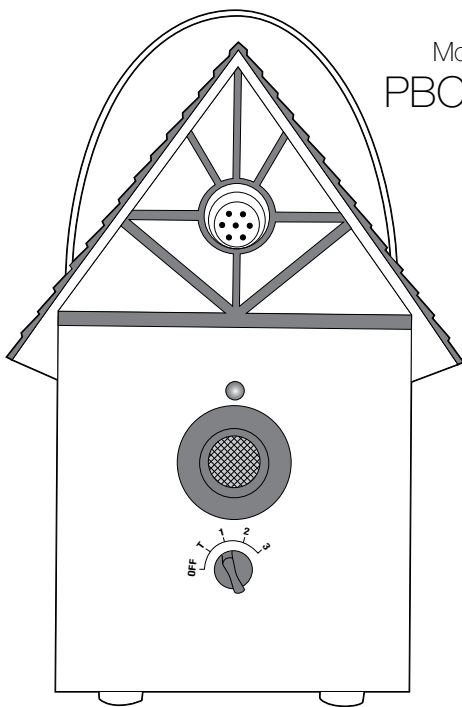

PLEASE READ THIS ENTIRE GUIDE BEFORE BEGINNING

Important Safety Information

Explanation of Attention Words and Symbols used in this guide



This is the safety alert symbol. It is used to alert you to potential personal injury hazards. Obey all safety messages that follow this symbol to avoid possible injury or death.

⚠ WARNING

WARNING indicates a hazardous situation which, if not avoided, could result in death or serious injury.

⚠ CAUTION

CAUTION, used with the safety alert symbol, indicates a hazardous situation which, if not avoided, could result in minor or moderate injury.

CAUTION

CAUTION, used without the safety alert symbol, indicates a hazardous situation which, if not avoided, could result in harm to your pet.

⚠ WARNING

Risk of explosion. Do not short circuit, mix old and new batteries, dispose of in fire, or expose to water. When batteries are stored or disposed, they must be protected from shorting. Dispose of used batteries properly.

⚠ WARNING

Not for use with aggressive dogs. Do not use this Product if your dog is aggressive, or if your dog is prone to aggressive behavior. Aggressive dogs can cause severe injury and even death to their owner and others. If you are unsure whether this product is appropriate for your dog, please consult your veterinarian or certified trainer.

⚠ CAUTION

Humans cannot hear the ultrasonic sound, however precautions should be taken when preparing the Outdoor Bark Control for use.

- : Keep at arms length away from the human ear to avoid hearing damage if a dog begins barking while you are setting up, mounting or hanging the Outdoor Bark Control.
- : Humans should also avoid standing very close to the Outdoor Bark Control when it is on.
- : This device is intended for use only with dogs. Never attempt to use it for any purpose not described in this manual.
- : For outdoor use only. Please visit our website or contact the Customer Care Center for information on PetSafe® Bark Control products.
- : The Outdoor Bark Control is not a toy. Keep it out of the reach of children. Use it only for its bark control purpose.

Thank you for choosing the PetSafe® brand. You and your pet deserve a companionship that includes memorable moments and a shared understanding together. Our products and training tools promote a lifestyle of protection, teaching, and love—essentials that influence memories for a lifetime. If you have any questions about our products or training your pet, please visit our website at www.petsafe.net or contact our Customer Care Center at 1-800-732-2677.

To get the most protection out of your warranty, please register your product within 30 days at www.petsafe.net. By registering and keeping your receipt, you will enjoy the product's full warranty and should you ever need to call the Customer Care Center, we will be able to help you faster. Most importantly, PetSafe® will never give or sell your valuable information to anyone. Complete warranty information is available online at www.petsafe.net.

Table of Contents

Components.....	4
Features.....	4
Possible Uses for the Outdoor Bark Control.....	4
How the PetSafe® Outdoor Bark Control Works.....	4
Key Definitions	5
Installation and Setup.....	5
To Insert and Remove the Battery.....	6
Modes of Operation	6
What to Expect During Use of the Outdoor Bark Control	7
Regular Maintenance	7
To Test the Outdoor Bark Control.....	7
Frequently Asked Questions	8
Troubleshooting.....	8
Terms of Use and Limitation of Liability	9
Customer Care International	9
Battery Disposal	10
FCC	10

Components

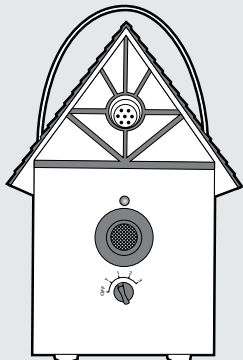

**PetSafe®
Outdoor Bark Control**

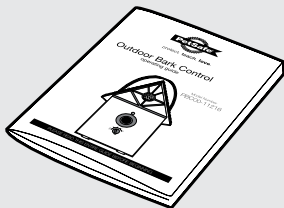

Operating Guide

Features

- : Uses ultrasonic sound to deter unwanted barking
- : Detects barks up to 50 feet with the use of an internal microphone
- : 4 levels of operation including a test mode
- : Durable and weatherproof for outdoor use

Possible Uses for the Outdoor Bark Control

- : Stop your barking dog
- : Stop your neighbors' barking dog
- : Train puppies not to bark
- : Deter barking dogs on camping trips

How the PetSafe® Outdoor Bark Control Works

When the PetSafe® Outdoor Bark Control is within range of a barking dog, an internal microphone picks up the sound and the unit is automatically activated. The Outdoor Bark Control emits an ultrasonic sound. The ultrasonic sound can be heard by dogs but is silent to humans. Startled by the high-pitched sound that is safe and effective, the dog should stop barking, as it will associate its bark with this unpleasant noise. When the dog stops barking the ultrasonic sound also stops. The PetSafe® Outdoor Bark Control has 3 range levels and a test mode. It is effective up to 50 feet.

Note: If the dog is deaf or hearing impaired, he may not react to the Outdoor Bark Control.

Key Definitions

Two Color LED: Shows good or low battery.

Microphone: Used to detect barking.

Sound Activated Speaker: Produces the ultrasonic sound.

Switch with 4 Levels of Operation:

Off: Used to conserve battery life

Test: Used to verify the microphone and speaker are functional

1=Low Range: Up to 15 feet

2=Medium Range: Up to 30 feet

3=High Range: Up to 50 feet

Metal Hanger: For hanging the Outdoor Bark Control.

Provisions for Mounting: Used to mount the Outdoor Bark Control on a tree, post, etc.

Battery Door: Used to enclose the battery.

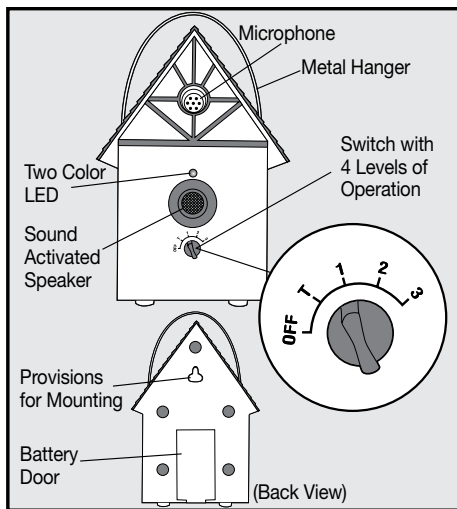

Installation and Setup

The PetSafe® Outdoor Bark Control should be placed facing the dog and within range of the dog. The unit is designed with provisions for hanging or mounting and should be positioned at a height of no more than 5 feet. The Outdoor Bark Control can also stand alone. It can be placed in a tree, hanging from a pole, on a fence post, etc. For best results, the area between the Outdoor Bark Control and the dog should be free of any large obstacles.

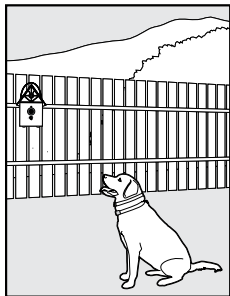

To Insert and Remove the Battery

1. The PetSafe® Outdoor Bark Control utilizes a replaceable 9-volt battery (not included). The battery door is located on the back of the unit. Pull the battery door open.
2. Insert the 9-volt battery with the positive side oriented as shown.

Replace the battery door by positioning the top edge, and snap the bottom of battery door into place.

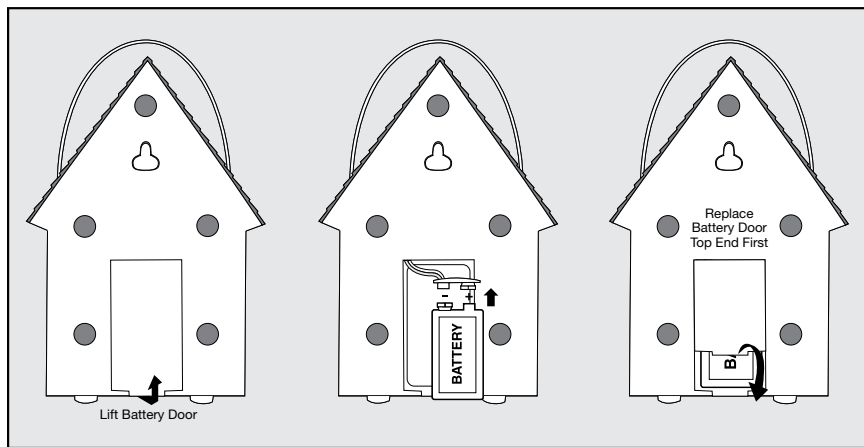

Battery Life

Average battery life is 2 months, depending on how often the dog barks. To conserve battery life, turn to the "OFF" position when the Outdoor Bark Control is not in use.

⚠ WARNING

Do not attempt to cut into or pry open the battery. Be sure to discard the used battery properly.

Two Color LED

The two color LED indicator shows good or low battery. Good battery equals 1 flash every 5 seconds with Green LED. Low battery equals 3 flashes every 5 seconds with the Red LED. If there are no LED lights it is time to change the battery. When emitting the ultrasonic sound, the Red LED is solid. When in test mode, the Red LED will flash if battery is low.

Modes of Operation

- Begin use of the Outdoor Bark Control on the Low Range setting and only increase to the Medium Range setting if the dog does not respond.
- If the dog does not respond to the Medium Range, increase to High Range.
- Turn to the TEST Mode to verify that your Outdoor Bark Control is working properly. Do not use this Mode for normal operation. See "To Test the Outdoor Bark Control."

Sensitivity Setting	Range
Low	Up to 15 feet
Medium	Up to 30 feet
High	Up to 50 feet

What to Expect During Use of the Outdoor Bark Control

Place the PetSafe® Outdoor Bark Control within range of the dog with the unit switched to Low, Medium or High. Most dogs will understand very quickly that the Outdoor Bark Control is disrupting their urge to bark and will relax and stop barking.

You should notice a reduction in the dog's barking within the first two weeks that the Outdoor Bark Control is in use. Please note this product may not work on deaf or hearing impaired dogs.

Excessive barking can cause a real strain on your relationship with your pet, as well as cause disruptions in your neighborhood. In some situations this product may become an aid to barking cessation, and not necessarily a cure. Please visit www.petsafe.net to view other customized solutions to the problem of too much barking.

Regular Maintenance

- : Remove the battery before cleaning.
- : Clean the PetSafe Outdoor Bark Control with a damp cloth.
- : Do not use any kind of spray chemicals or solvent to clean.
- : Do not immerse in water or any other liquid.

Note: the Outdoor Bark Control is weatherproof. However, if water enters into the microphone it may disrupt the unit's operation. After the microphone is dry it will resume working properly.

To Test the Outdoor Bark Control

1. Turn the Mode Switch to TEST.
2. Hold the unit with the Indicator Light facing towards you. The unit should be arms length away from your mouth.
3. In order to trigger the unit, say "Woof" loudly towards the Microphone.
4. The LED light will flash red and there will be an audible sound to indicate that it is functioning properly.
5. If the Indicator Light does not flash and there is no audible sound, ensure that the battery is properly installed and/or replace the battery. If the Indicator Light still does not flash, contact the Customer Care Center.
6. Return the Mode Switch to Low Range before you begin using the Outdoor Bark Control.

Note: The TEST Mode is not intended for normal operation. If the Outdoor Bark Control is left in TEST Mode, it can send false signals and may reduce battery life.

Frequently Asked Questions

What is the range for the PetSafe® Outdoor Bark Control?	: The PetSafe® Outdoor Bark Control detects barking and sends the ultrasonic sound up to 50 feet.
Is the Outdoor Bark Control effective on all dogs?	: The product may not work on deaf or hearing impaired dogs.
Will the Outdoor Bark Control work for multiple dogs?	: Yes, it is effective on all dogs within range of the Outdoor Bark Control.
Can I use the Outdoor Bark Control indoors?	: No, we do not recommend using the product indoors. For Indoor Bark Control product information, please visit our website at www.petsafe.net or call our Customer Care Center.
Can a dog become desensitized to the ultrasonic sound?	: There are some situations where dogs become desensitized. To avoid this, only turn the Outdoor Bark Control on during periods of unwanted barking (i.e. leave it off when you are away).
Can humans hear the ultrasonic sound?	: The ultrasonic sound cannot be heard by humans. Occasionally the speaker may vibrate which can make a sound.

Troubleshooting

The green LED light stopped flashing and there is no red light.	<ul style="list-style-type: none">: Ensure that the battery is properly installed.: Replace the battery.: If the green LED light is still not flashing, contact the Customer Care Center.
------------------------------------------------------------------------	---------------------------------------------------------------------------------------------------------------------------------------------------------------------------------------------------------------------------

Terms of Use and Limitation of Liability

1. Terms of Use

This Product is offered to you conditioned upon your acceptance without modification of the terms, conditions and notices contained herein. Usage of this Product implies acceptance of all such terms, conditions, and notices.

2. Proper Use

This Product is designed for use with pets where training is desired. The specific temperament of your pet may not work with this Product. We recommend that you not use this Product if your pet is less than 8 pounds or if your pet is aggressive. If you are unsure whether this is appropriate for your pet please consult your veterinarian or certified trainer.

Proper use includes reviewing the entire Guide provided with your Product and any specific Caution statements.

3. No Unlawful or Prohibited Use

This Product is designed for use with pets only. This pet training device is not intended to harm, injure or provoke. Using this Product in a way that is not intended could result in violation of Federal, State or local laws.

4. Limitation of Liability

In no event shall Radio Systems® Corporation be liable for any direct, indirect, punitive, incidental, special or consequential damages, or any damages whatsoever arising out of or connected with the use or misuse of this Product. Buyer assumes all risks and liability from the use of this Product.

5. Modification of Terms and Conditions

Radio Systems® Corporation reserves the right to change the terms, conditions and notices under which this Product is offered.

Customer Care International

USA & Canada - Tel: 800-732-2677

Monday - Friday 8 AM - 8 PM / Saturday 9 AM - 5 PM

Australia - Tel: 1800 786 608

Monday - Friday 8:30 AM - 5 PM

New Zealand - Tel: 0800 543 054

Monday - Friday 10:30 AM - 7 PM

This product has the benefit of a limited manufacturer's warranty. Details of the warranty applicable to this product and its terms can be found at www.petsafe.net and/or are available by sending a stamped addressed envelope to PetSafe® Ltd. Redthorn House, Unit 9, Chorley West Business Park, Ackhurst Road, Chorley, Lancashire PR7 1NL, United Kingdom.



Battery Disposal

Separate collection of spent batteries is required in many regions; check the regulations in your area before discarding spent batteries. At the end of the product life, please contact our Customer Care Center to receive instructions on proper disposal of the unit. Please do not dispose of the unit in household or municipal waste. For a listing of Customer Care Center telephone numbers in your area, visit our website at www.petsafe.net.

FCC

This device complies with IC ES-003; this device complies with Part 15 of the FCC Rules. Operation is subject to the following two conditions:

1. This device may not cause harmful interference.
2. This device must accept any interference received including interference that may cause undesirable operation.

Radio Systems® Corporation
10427 PetSafe Way
Knoxville, TN 37932
1-800-732-2677
www.petsafe.net
400-1556

©2007 Radio Systems Corporation

The device has been approved for use in EU countries and is therefore provided with the **CE mark**. All necessary documentation is available on the website: www.electric-collars.com
Changes to technical parameters, properties and printing errors reserved.

Service center and distribution

Reedog, sro

Sedmidomky 459/8 101

00 Prague 10

Phone: +1 646 980 4569

Email: info@electric-collars.eu