

SS32VHYH		宁波市德源机械有限公司	
设计	分区	更改文件号	签名
校对		标准化	年月日
审核			
工艺			
共 1 页		第 1 页	
SS32VHYH (合金文本集)			

S532VHY-W Part List

No.	Material No.	Description in English	Qty	Unit Price
1	70500620130	upper handrail	1	5,3
2	70520390130	lower handrail	1	5
3	70540084830	stop lever	1	1,9
4	70550074130	Self-propelled Lever	1	1,9
5	20340060000	foam pipe	1	0,55
6	20030030000	lever guard	1	1,1
7	60090250000	Hexagon head bolts	2	0,06
8	60150080000	Self-locking nut	2	0,05
9	70230090000	Rope Guide	1	0,7
10	60130020000	cap nut	1	0,05
11	20650170000	Brake Cable Assy plate	1	0,6
12	70780220000	selfpropelled cable	1	1,09
13	70810030000	brake cable	1	1,09
14	20580040830	quick fix knob	2	0,6
15	70220080000	quick fix handle	2	0,2
16	60300090000	lever pin	2	0,03
17	60240290000	open ring	2	0,02
18	60190040000	big flat washer	2	0,1
19	60200470000	flat washer	2	0,02
20	20040140830	small triangle knob	2	0,5
21	60140080000	Hex nut	2	0,05
22	60090240000	Hexagon head bolts	2	0,05
23	60150020000	hex self-locking nut	2	0,05
24	60090220000	Hexagon head bolts	2	0,05
25	70080250290	aluminum bracket-upper	2	3,6
26	60180130000	conical spring washer	2	0,1
27	70030850000	rotating shaft for quick lever	2	1,1
28	70220140830	aluminium quick lever	2	1,8
29	20240020000	fastener	1	0,15
30	20400140000	rear baffle	1	4,8
31	20400150000	rear baffle window	1	0,5
32	60170290000	cessed Pan head self-tappir	18	0,06
33	20380100000	rear discharge cover	1	3

34	70030830000	shaft for rear discharge cov	1	1, 1
35	60380590000	rear discharge cover spring -	1	0, 5
36	60380580000	rear discharge cover spring	1	0, 5
37	20390040000	base of rear discharge cov	1	0, 46
38	60170600000	recessed Pan head tapping	8	0, 06
39	20160190000	mulching plug	1	2, 3
40	20750210000	rubber dust proof board	1	0, 6
41	70030840000	dust proof board for shaft	1	0, 3
42	60300030000	R type pin	2	0, 02
43	70850810000	rear drive assy	1	10, 8
44	20260240000	height adjustment handle	1	0, 8
45	20550050830	spring for height adjustment ha	1	0, 2
46	60150170000	hex self-locking nut	2	0, 05
47	60060530000	hex bolt	2	0, 06
48	60200560000	big washer	2	0, 1
49	60180120000	wave form washer	4	0, 02
50	20610160000	inner cover of hub	2	0, 56
51	20880460830	wheel assy	2	6, 62
52	60150090000	hex self-locking nut	14	0, 06
53	20620290290	outer cover of hub	2	0, 56
54	70860500000	selfpropelled assy.	1	32
55	60290070000	Ratchet Wheel pin	2	0, 1
56	20430030440	rear wheel axle sleeve	2	0, 35
57	21070030000	selfpropelled ratchet washe	4	0, 04
58	70300200000	Ratchet Wheel R	1	1, 9
59	60240060000	spring washer	6	0, 04
60	70300190000	Ratchet Wheel L	1	1, 9
61	70050310000	Brake spring	1	1, 2
62	60410560000	selfpropelled spring	1	0, 08
63	70840310000	front drive assy	1	4, 8
64	20610170290	inner cover of hub	2	0, 45
65	20880470830	wheel assy	2	3, 2
66	20620300290	outer cover of hub	2	0, 45
67	60410660000	front drive spring	2	0, 2

68	70180390830	Height Adjustment Pull Rod	1	2,30
69	60240300000	blocked plate	2	0,06
70	20200300000	front face mask	1	3,5
71	20200320830	front face screwing	1	1,9
72	20200310830	grass board	1	0,86
73	20200330830	front face plate cover	1	0,3
74	70080230290	aluminum low bracket-left	1	5,2
75	70080240290	aluminum low bracket-right	1	5,2
76	20590020000	cable stopper	1	0,02
77	60370020000	"O" ring	1	0,02
78	20460010000	inlet		0,1
79	20460030000	outlet	1	0,1
80	60040160000	f round head square neck be	4	0,06
81	70742060130	deck	1	45,00
82	70060110130	Bracket plate for defelctor	1	0,5
83	60170580000	recessed Pan head tapping	2	0,06
84	70030820000	Mulch Shaft	1	0,4
85	60390250000	mulch board spring	1	0,4
86	20120110830	mulching board	1	1,10
87	20110150000	side discharge cover	1	1,50
88	60320270000	V belt	1	1,30
89	70070570130	front drive right bracket	1	0,8
90	70070560130	front drive left bracket	1	0,8
91	60040020000	f round head square neck be	4	0,06
92	70290350000	rear drive bracket	2	0,5
93	20660230000	belt cover	1	1,82
94	70150240000	square washer	2	0,1
95	60170490000	double-head bolt	2	0,08
96	60170010000	hex tapping screws	1	0,06
97	70140780000	blade adapter	1	5,9
98	70130990000	blade	1	7,20
99	70040070000	blade washer	1	0,45
100	60100020000	bolt of blade	1	0,18
101	20080100830	top of grass box	1	6,2
102	20060060000	t board of fabric grass bag	1	0,38
103	20080110000	top grass box screwing	1	0,6
104	20100100000	lower of grass box - right	1	4,5
105	20100090000	lower of grass box - left	1	4,5

106	20060070830	grass sticker board	2	0,56
107	60171930000	alum flowe self-tapping scr	6	0,05
108	A583470	T575 Engine	1	
109	60200550000	big washer	2	0,1
110	60200110000	flat washer	2	0,04
111	20650140000	control panel upper cover	1	1,2

T475-2汽油机分解图

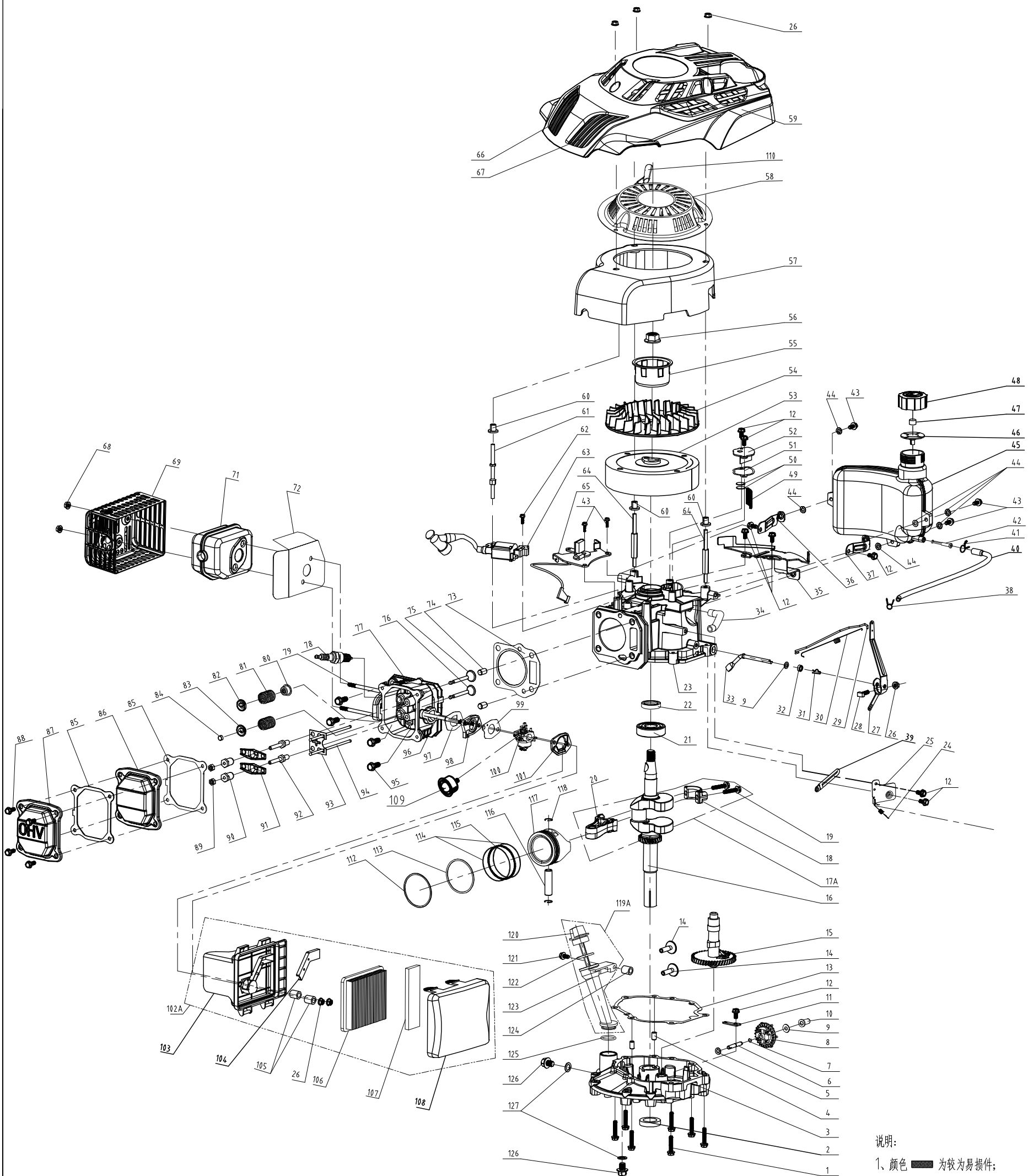

说明:

- 1、颜色 为较为易损件;
- 2、颜色 为一般易损件;
- 3、本图为带刹车装置不带调速。

修改/删除
 描图
 存盘文件名
 图库图号
 底图图号
 签字
 日期

						宁波市德霖机械有限公司			
						T475带刹车不带调速款			
标记	页数	分区	更改文件号	签名	年月日	阶段标记	数量	重量	比例
设计			标准化				1		1:4
校对			审定						
审核									
工艺			批准						
						共 1 页	第 1 页	版本 A1	

Poz.	Číslo	Poč.	Název
1	60060590000	7	Bolt
2	60360100000	1	oil seal
3	75240140000	1	Crank box cover
4	60280030000	2	spacing pin
5	60200060000	1	Gasket
6	75270010000	1	rate-limiting gear shaft
7		1	Gear Shaft circlip
8	75520020000	1	rete-limiting gear assy.
9	60200490000	2	Gasket
10	25070010000	1	Sliding Sleeve
11	75280010000	1	rate-limiting gear shaft
12	60060520000	11	Bolt
13	75720240000	1	
14	75250010000	2	pin
15	75470020000	1	camshaft assy.
16	75510600000	1	crankshaft assy.
17	75460020000	1	connecting rod assy.
18		1	
19		2	
20		1	
21	60010140000	1	rolling bearing
22	60360090000	1	oil seal
23	75500010000	1	crankshaft box
24	60410470000	1	throttle control spring
25	75360010000	1	throttle assy.
26	60150080000	6	Hex flange nuts
27	75070010000	1	throttle rocker arm
28	60060730000	1	bolt
29	75160010000	1	Handspike of Valve
30	60410050000	1	valve spring
31	60300040000	1	R type pin
32	60360080000	1	oil seal
33	75290010000	1	rate-limiting rocker arm shaft
34	25030020000	1	waste pipe
35	75330010000	1	main bracket of fuel tank
36	75310010000	1	right bracket of fuel tank
37	75340010000	1	left bracket of fuel tank
38	60230010000	1	fuel pipe lock clamp II
39	60450010000	1	clip
40	25160010000	1	fuel pipe
41	60230020000	1	fuel pipe lock clamp I
42	25150010000	1	
43	60060560000	3	Bolt
44	25310010000	6	Cushion Blocking gasket
45	25180130000	1	fuel tank body
46	60440030000	1	Fuel Tank Cap seal gasket
47	80010070000	1	fuel tank cap sponge
48	25170050000	1	fuel tank cap
49	75150010000	1	oil filter net
50	75100020000	2	
51	75720150000	1	
52	75400010000	1	Respirator Cover Plate Assy
53	75390130000	1	flywheel assy
54	25040110000	1	fan
55	75210010000	1	starter hub
56	60140050000	1	Hex flange nuts
57	25010010000	1	Blower Housing
58	75430110000	1	pull starter assy.
59	25190080000	1	
60		1	
61	60080100000	1	Different-shaped double-head bolts I
62	60060580000	1	Bolt
63	75370030000	1	ignition assy.

64	60080120000	2	Different-shaped double-head bolts BOM单
65	75380070000	1	detent assy.
66	25000020830	1	
67	25000030830	1	
68	60150100000	2	Self-locking nut
69	75530020000	1	muffler cover assy.
70			
71	75540020000	1	muffler assy.
72	75740020000	1	
73	75720100000	1	
74	60280020000	2	spacing pin
75	75170010000	1	IntakeValve
76	75190010000	1	Exhaust Valve
77	75490020000	1	cylinder head assy.
78	75140010000	1	spark plug
79	60080020000	2	Dual-head bolts
80	60360130000	1	oil seal assy
81	60380080000	2	valve spring
82	75180010000	1	Spring Coil of Intake Valve
83	75180020000	1	Spring Coil of Exhaust Valve
84	75200010000	1	Top Cover of Exhaust Valve
85	75720270000	2	
86	75220010000	1	cylinder head cover I
87	75220020000	1	cylinder head cover II
88	60060530000	4	Bolt
89	60160030000	2	And nuts
90	60160050000	2	Valve adjustment nut
91	75230010000	2	Rocker of Valve
92	60060760000	2	valve rocker arm support bolts
93	75260010000	1	push rod director plate
94	75350010000	2	push rod
95	60050030000	4	locking bolt
96	60080030000	2	Dual-head bolts
97	75730020000	1	
98	25090010000	1	Air Inlet Pipe
99	75730030000	1	
100	75410050000	1	carburetor assy.
101	75730100000	1	Steel Gasket
102			
103	25220010000	1	Air Filter Pedestal
104	25020010000	1	Exhaust Gas Cover Board
105		2	
106	25300020000	1	
107	25300010000	1	
108	25120010000	1	Air Filter Upper Cover
109	25210020130	1	prime button I
110		1	start handle
111			
112	75130060000	1	Piston Ring I
113	75130030000	1	Piston Ring II
114	75060010000	2	Guide Rail
115	75000010000	1	Bushing Ring
116	60310010000	1	piston pin
117	75120010000	1	Piston
118	60400020000	2	Piston Pin circlip
119	25200100130	1	Lubricating Gauge Assy
120		1	
121	60060570000	1	Bolt
122		1	
123		1	
124	25080010000	1	Distance Sleeve of Lubricating Setting
125		1	
126	60061020000	2	Oil drain bolt
127	60200150000	2	Oil drain bolt gasket