



**20V** LI-ION  
**FASTPOWER**



FDUK 70305-0

---

English .....	7-24
Čeština .....	25-42
Slovenčina .....	43-60
Magyarul .....	61-78
Polski .....	79-96

## Cordless circular saw

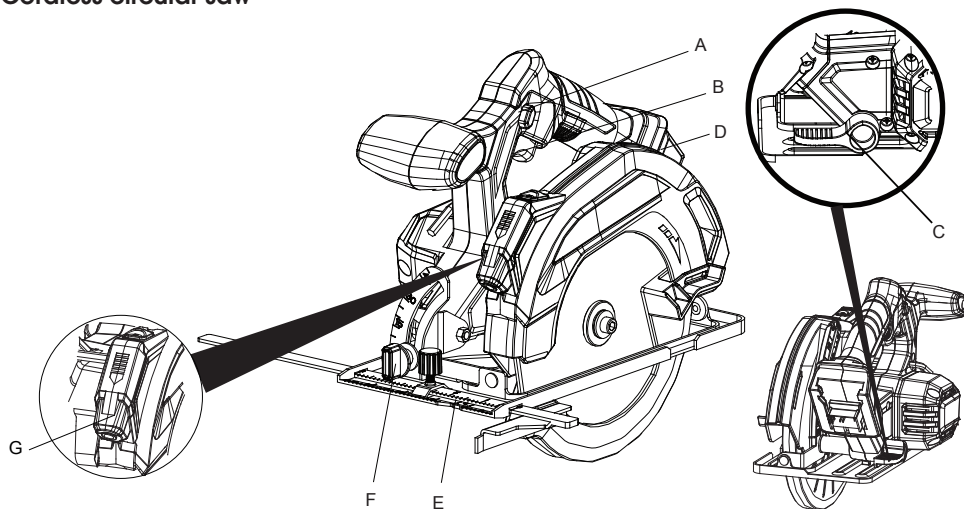

1

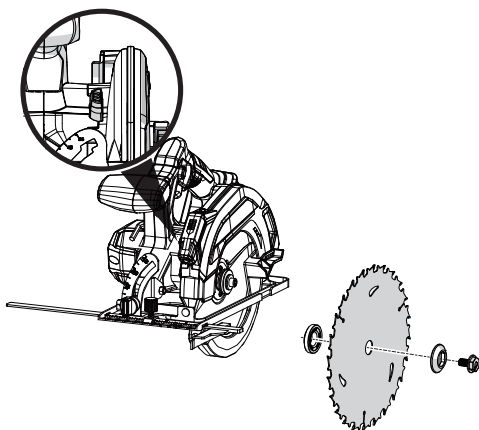

2

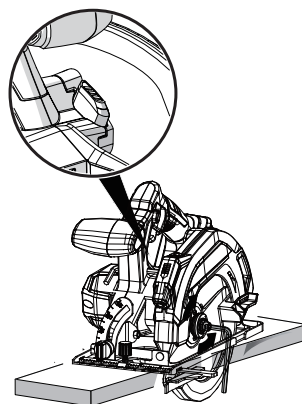

3

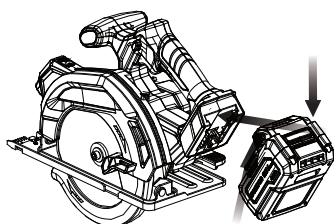

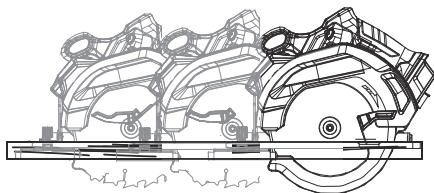

5

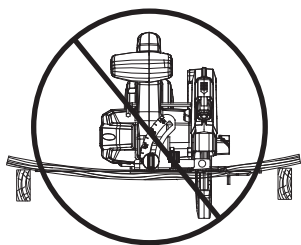

6

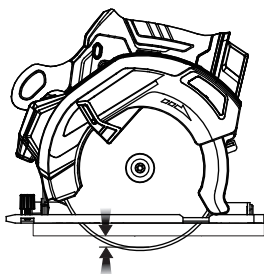

7

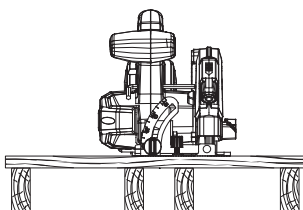

8

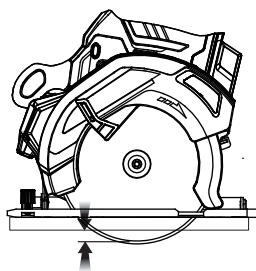

9

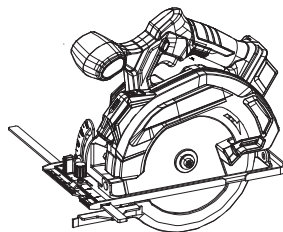

10

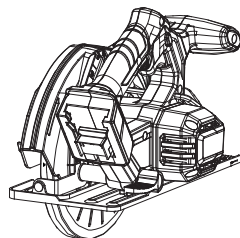

11

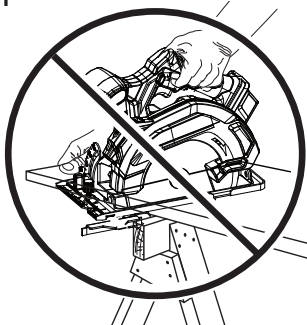

12

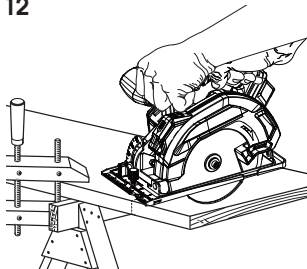

13

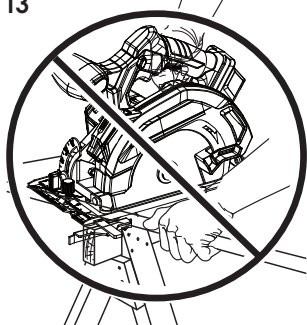

14

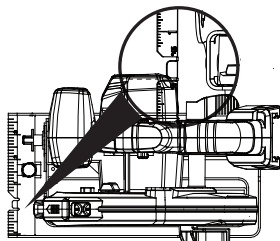

15

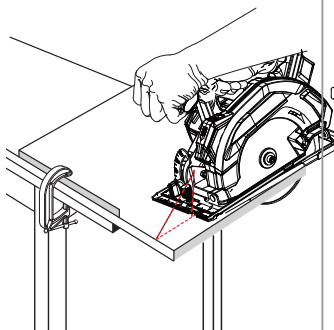

16

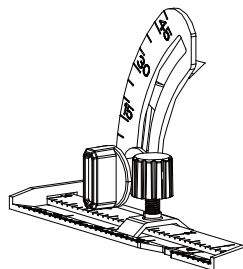

17

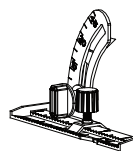
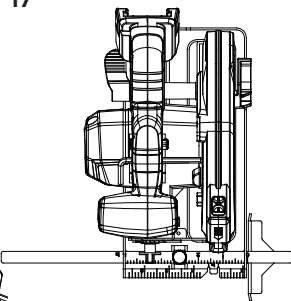

18

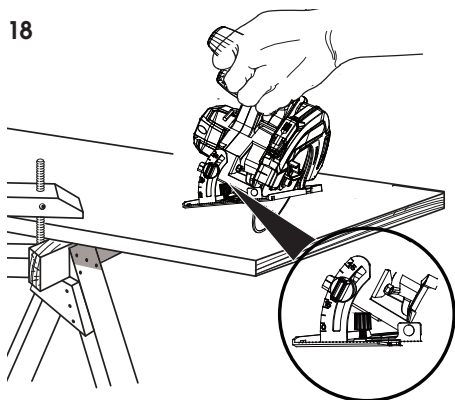

19

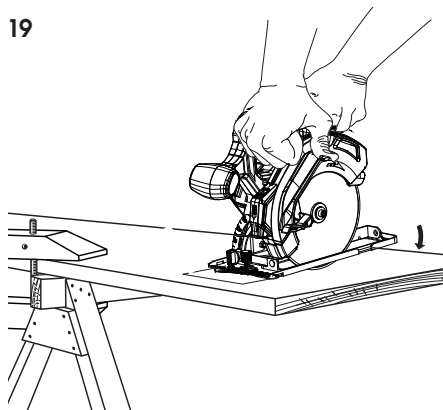

# Cordless Circular Saw

## USER'S MANUAL

**Thank you for purchasing this Cordless Circular Saw FIELDMANN. Before you start using it, please carefully read this user's manual and save it for possible future use.**

## TABLE OF CONTENTS



1. SAFETY INSTRUCTIONS.....	8
2. SYMBOLS.....	9
3. MACHINE DESCRIPTION AND ITEMS DELIVERED .....	10
4. GENERAL SAFETY INSTRUCTIONS .....	11
5. SPECIFIC SAFETY INSTRUCTIONS.....	13
6. HEARING PROTECTION .....	14
7. OPERATION .....	14
8. ASSEMBLY .....	19
9. ADJUSTMENTS.....	20
10. MACHINE CARE .....	20
11. WARRANTY .....	21
12. TECHNICAL DATA .....	22
13. TROUBLESHOOTING .....	22
14. DISPOSAL.....	23

# 1. SAFETY INSTRUCTIONS

## **WARNING!**

Carefully read the instruction manual before use.

### **Important safety warnings**

-  Unpack the product carefully and be sure not to throw away any part of the package before having found all components of the product.
-  Keep the product in a dry place out of reach of children.
-  Read all cautions and instructions. The failure to adhere to warning cautions and instructions may result in an accident, fire and/or a serious injury.

### **Packaging**

The product is placed in a package preventing damage during transport. This package is a raw material therefore it can be handed-over for recycling.

### **Instructions for use**

Before beginning to work with the machine, read the following safety rules and instructions for use. Familiarize with operating elements and the proper use of the device. Keep the manual in a safe place for future reference. We recommend keeping the original package including the inner packaging materials, cash voucher and guarantee card for a period of warranty at minimum. For a case of transportation, pack the machine into the original box from the manufacturer, thus ensuring a maximum protection of the product during a possible transport (e.g. moving or sending into a service station).

 **Note:** If you hand the machine over to next persons, hand it over together with the manual. Adherence to the attached instructions for use is a precondition for the proper use of the machine. The operation manual includes also instructions for operation, maintenance and repairs.

**The manufacturer does not take any responsibility for accidents or damages resulting from the failure to adhere to this manual.**

### **Intended use**

The jigsaw is intended to be used only by adults who have read and understood the instructions and warnings in this manual, and can be considered responsible for their actions.

With appropriate blades fitted, the product is designed to cut wood, plastic, drywall, and metal up to the depth described in the specification table.

The product is designed for handheld use. The product is not to be mounted onto a workbench unless specific instructions about how to do this are given by the manufacturer of the product.

Do not use the product for any other purpose. Use of the product for operations different from intended could result in a hazardous situation.



## 2. SYMBOLS



**The product complies with the applicable standards and regulations.**



**Read the Instruction Manual attentively prior to use.**



**Use eyes protective equipment**



**Use ears protective equipment**



**AC laser: danger of injury – do not stare into beam**

### 3. MACHINE DESCRIPTION AND ITEMS DELIVERED

Machine description (see page 3)

- A. Lock-off button
- B. Switch trigger
- C. Blade wrench storage
- D. Area depth lock lever
- E. Width of cut scale
- F. Bevel lock knob
- G. Worklight

#### Items delivered

Remove all contents from the box and inspect to ensure no damage was incurred during shipping, and that the items listed below are included.

- Circular saw
- Parallel edge guide
- 1 pc of circular saw blade
- Warranty card
- Instruction Manual

Should the components be missing or damaged, contact the dealer of the machine.

## 4. GENERAL SAFETY INSTRUCTIONS

**Please read these safety instructions carefully, remember them and keep them in a safe place**

**⚠ WARNING!** When using electric machinery and power tools, it is important to abide by and adhere to the following safety instructions for reasons of protection against injury caused by electric current, injury of persons and risk of starting fires. The term “power tools” used in the instructions below refers to power tools that are plugged into a power supply (by a power cord) as well as tools running on a battery pack (cordless). Keep all warnings and instructions for further use.

### Work environment

- ✿ Keep the work area clean and well lit. Untidiness and dark places on the job site are usually causes of accidents. Store tools that are not used.
- ✿ Do not use power tools in an environment where there is risk of starting a fire or explosion; this refers to places where there are flammable liquids, gases or dust. Sparks form on the power tool's commutator, which can cause dust or fume ignition.
- ✿ When using power tools, unauthorized persons, especially children, should be denied entry to the job site! In case you are interrupted, you can lose control of the current activity. In any case, do not leave the power tool without supervision. Prevent animals from approaching the equipment.

### Electrical safety

- ✿ The power tool's power plug must correspond to the power outlet. Never alter the plug in any way. If the tool's plug has a safety peg, never use an adapter of any kind. Undamaged plugs and corresponding outlets prevent the risk of injury by electric current. If the power cord is damaged, it must be replaced by a new power cord that can be obtained from an authorized service centre or the importer.
- ✿ Avoid bodily contact with grounded items, e.g. piping, radiators, kitchen ranges and refrigerators. The risk of injury by electric current is greater if your body is connected to the ground.
- ✿ Do not expose power tools to rain, moisture or dampness. Never touch power tools with wet hands. Never wash power tools with running water and never submerge them into water.
- ✿ Do not use the power cord for any other purpose than originally intended. Never carry or pull the power tools by the power cord. Do not pull the plug out of the outlet by pulling on the cord. Avoid mechanical damage to the power cord by sharp or hot objects.
- ✿ Power tools were manufactured exclusively for the AC power supply. Always check if the electrical voltage corresponds to the data printed on the tool's serial number label.
- ✿ Never work with a tool that has a damaged power cord or plug, or that has fallen on the ground and is damaged in any way.
- ✿ In the case of using an extension cord, always check that its technical parameters correspond to the data printed on the tool's serial number label.
- ✿ If the power tool is used outdoors, use an extension cord that is appropriate for exterior use. When using an extension cable drum, the cord must be unwound to prevent the cord from overheating. If the power tool is used in moist areas or outdoors, it is permitted to use it only if it is plugged into an electric circuit with a residual current device  $\leq 30$  mA. Using a circuit with an RCD lowers the risk of injury by electric current.
- ✿ Grasp hand power tools at the designated isolated grip areas because, during operation, one may come into contact with the cutting or drilling fittings with a hidden conductor or with the power cord.

## Personal safety

- ✿ When using a power tool, be careful and alert, pay special attention to the activity you are doing. Concentrate on your work. Do not work with power tools if you are tired or if you are under the influence of drugs, alcohol or medication. When using power tools, even a momentary lapse in attentiveness can lead to severe personal injury. Do not eat, drink or smoke while working with power tools.
- ✿ Use protective gear. Always use eye protection. Use protective gear corresponding to the type of work you are doing. Protective gear such as respirators, safety shoes with antiskid treatment, head protection or ear protection, used in accordance with working conditions, lower the risk of personal injury.
- ✿ Avoid unintentional operation of tools. Do not carry tools that are plugged into the electric grid with your finger on the switch or release trigger.
- ✿ Before connecting the tool to a power supply, make sure that the switch or release trigger are in the "off" position. Carrying tools with your finger on the switch or plugging the tool into an outlet with the switch in the "on" position can cause serious injury. Before turning tools on, remove all adjustment wrenches and tools. The adjustment wrench or tool that stays connected to the rotating part of the power tool can cause personal injury.
- ✿ Always stand firmly and keep your balance. Work only in places that you can reach safely. Never overestimate your own strength. Do not use power tools if you are tired.
- ✿ Dress appropriately. Use working clothes. Do not wear loose clothing or jewellery. Make sure that your hair, clothing, gloves or other body parts do not come overly close to rotating or heated parts of the power tool.
- ✿ Connect the equipment to the dust exhaust. If the tool offers the possibility to connect equipment for capturing dust or dust suction, make sure that it is properly connected and used. Using this equipment can reduce danger resulting from dust.
- ✿ Firmly fasten the workpiece. Use a carpenter's clamp or vice to secure the piece you will be cutting.
- ✿ Do not use power tools if you are under the influence of alcohol, drugs, medication or other narcotics or addictive substances.
- ✿ This equipment is not intended to be used by persons with limited physical, sensory or mental abilities (including children) or persons with insufficient experience and knowledge, unless they are supervised or received instructions to use the equipment from a person responsible for his/her safety. Children must be supervised in order to ensure that they are not playing with the equipment.

## Using power tools and their maintenance

- ✿ Always disconnect the power tool from the electric grid if there is any problem during work, before every cleaning or maintenance, during every shift and after finishing work! Never work with power tools if they are damaged in any way. If the tool starts emitting abnormal noises or odours, immediately stop working.
- ✿ Do not overload power tools. The power tool will function better and more safely if it operates at speeds for which it was designed. Use correct tools that are designated for the given activity. The correct tool works better and more safely.
- ✿ Do not use power tools that cannot be turned on safely and cannot be turned on and off with a control switch. Using this type of tool is dangerous. Faulty switches must be repaired at a certified service centre.
- ✿ Disconnect the tool from the power supply before you start setting, changing accessories or maintenance. This measure will prevent the risk of accidental start-up.
- ✿ Store unused power tools so that they are out of the reach of children and unauthorized persons. Power tools in the hands of inexperienced users can be dangerous. Store power tools in a dry and safe place. Keep power tools in good condition. Regularly check the setting of moving parts and their movability. Check if the protective cover or other parts that can limit the safe functioning of the power tool are not damaged. If the

tool is damaged, ensure its proper repair before the next use. Many injuries are caused by poorly maintained power tools.

- ✿ Keep cutting tools sharp and clean. Properly maintained and sharpened tools make work easier, limit the risk of injury and work with them is much more easily controlled. Using other accessories than those listed in the instruction manual can cause damage to the tool and can cause injury.
- ✿ Use power tools, accessories, work tools, etc. in accordance with these instructions and in a way that is described for the specific power tool and with regard to the given working conditions and the type of job.
- ✿ Using tools for other purposes than those intended can lead to dangerous situations.

### Using cordless tools

- ✿ Before inserting the battery, make sure that the switch is in the "O-off" position. Inserting the battery into a running tool can cause dangerous situations.
- ✿ To charge the battery, only use chargers that are specified by the manufacturer. Using a charger for a different kind of battery can cause damage to the battery and result in fire.
- ✿ Only use batteries that are designated for the given tool. Using other batteries can cause injury or result in fire.
- ✿ If the battery is not used, store it away from metal objects such as clamps, wrenches, screws and other small metal objects that could cause the connection of one battery contact with the other. Short-circuiting the battery can cause injury, burns or fire.
- ✿ Handle batteries with care. In the case of improper care, chemical substances can leak from the battery. Avoid coming into contact with this substance and if you do come into contact with it, rinse the affected area under running water. If the chemical substance comes into contact with the eye, immediately seek out medical attention. The chemical substance from the battery can cause serious injury.

### Service

- ✿ Do not change parts of the tool, do not perform repairs on your own and do not interfere with the tool's construction in any way. Leave tool repairs to qualified persons.
- ✿ Each repair or product modification performed without our company's permission is inadmissible (it can cause injury or harm to the user).
- ✿ Always leave tools to be repaired in a certified service centre. Use only original or recommended spare parts. This will ensure your and your tool's safety.

## 5. SPECIFIC SAFETY INSTRUCTIONS

**⚠ WARNING!** Before use, please read these safety Instructions and store them with care.

- ✿ Please ensure that the voltage of the mains power supply corresponds to the value stated on the type plate. The tool is equipped with a two-pole lead and plug!
- ✿ Wear safety glasses and a face or dust mask if the cutting or drilling operation is dusty. When using the tool for extended periods, or where the noise level is high, use adequate hearing protection.
- ✿ If devices are provided for the connection of dust extraction and collection facilities, ensure these are connected and properly used. Always empty the dust collection bag when full.
- ✿ Use clamps or a vice to hold the work piece. It is safer than using your hand and frees both hands to operate the tool.
- ✿ Ensure the power cord is arranged so that it cannot be tripped over, stepped on or have heavy weights rested on it; and make sure that the cord will not be subjected to any damage.

- \* A risk of injury exists in the case that instructions in this manual are not followed. The jigsaw complies with valid technical regulations and norms.
- \* When working with the jigsaw, the protective cover must always be pushed down.
- \* Regularly check both screws on the clamp of the saw blade.
- \* Do not use damaged or worn saw blades.
- \* Regularly check the setting of the guide pulley.
- \* Do not turn the saw on if the saw blade slid into the workpiece.
- \* Never overload the saw so much that the engine ceases.
- \* Never try to stop the movement of the saw blade, even when the engine is turned off.
- \* The saw blade itself is removed very quickly. The blade's teeth are very sharp.
- \* Never aim the saw at another person.
- \* Use protective gear against noise, dust and vibrations!!!

**⚠ WARNING!** Keep these safety instructions!!!

## 6. HEARING PROTECTION

**⚠ WARNING!** In case the sound pressure level exceeds the value of 90.2 dB(A), wear adequate hearing protection to avoid damage to your hearing!

## 7. OPERATION

**⚠ WARNING!** Do not allow familiarity with products to make you careless. Remember that a careless fraction of a second is sufficient to inflict serious injury.

**⚠ WARNING!** Always wear eye protection with side shields marked to comply with ANSI Z87.1. Failure to do so could result in objects being thrown into your eyes resulting in possible serious injury.

**⚠ WARNING!** Do not use any attachments or accessories not recommended by the manufacturer of this product. The use of attachments or accessories not recommended can result in serious personal injury.

**⚠ WARNING!** Never use abrasive cut-off wheels of any kind with this saw. Use of non wood cutting blades can result in property damage or serious personal injury.

### APPLICATIONS

You may use this product for the purposes listed below:

- \* Cutting all types of wood products (lumber, plywood, paneling, composition board, and hard wood)

### INSTALLING/REMOVING BATTERY PACK

See Figure 3, page 3.

- \* Insert the battery pack into the product as shown.
- \* Make sure the latches on each side of the battery pack snap in place and that battery pack is secured in the product before beginning operation.
- \* Depress the latches to remove the battery pack.

For complete charging instructions, see the operator's manuals for your battery pack and charger.

**⚠ WARNING!** Battery tools are always in operating condition. Therefore, switch should always be locked when not in use or carrying at your side.

## KICKBACK

See Figures 4 - 7, page 4.

Kickback occurs when the blade stalls rapidly and the saw is driven back towards you. Blade stalling is caused by any action which pinches the blade in the wood.

**⚠ DANGER!** Release switch immediately if blade binds or saw stalls. Kickback could cause you to lose control of the saw. Loss of control can lead to serious injury.

To guard against kickback, avoid dangerous practices such as the following:

- ✿ Setting blade depth incorrectly.
- ✿ Sawing into knots or nails in work piece.
- ✿ Twisting the blade while making a cut.
- ✿ Making a cut with a dull, gummed up, or improperly set blade.
- ✿ Supporting the work piece incorrectly.
- ✿ Forcing a cut.
- ✿ Cutting warped or wet lumber.
- ✿ Operating the tool incorrectly or misusing the tool.

To lessen the chance of kickback, follow these safety practices:

- ✿ Keep the blade at the correct depth setting. The depth setting should not exceed 1/4 in. below the material being cut.
- ✿ Inspect the work piece for knots or nails before cutting. Never saw into a knot or nail.
- ✿ Make straight cuts. Always use a straight edge guide when rip cutting. This helps prevent twisting the blade.
- ✿ Use clean, sharp, and properly set blades. Never make cuts with dull blades.
- ✿ Support the work piece properly before beginning a cut.
- ✿ Use steady, even pressure when making a cut. Never force a cut.
- ✿ Do not cut warped or wet lumber.
- ✿ Hold the saw firmly with both hands and keep your body kick back should occur.

**⚠ WARNING!** in a balanced position so as to resist the forces if  
When using the saw, always stay alert and exercise control. Do not remove the saw from the work piece while the blade is moving.

## SAW BLADES

The best of saw blades will not cut efficiently if they are not kept clean, sharp, and properly set. Using a dull blade will place a heavy load on the saw and increase the danger of kickback. Keep extra blades on hand, so that sharp blades are always available.

Gum and wood pitch hardened on blades will slow the saw down. Remove saw blade from the saw and use gum and pitch remover, hot water, or kerosene to remove these accumulations. **DO NOT USE GASOLINE.**

## BLADE GUARD SYSTEM

See Figure 8, page 4.

The lower blade guard attached to the circular saw is there for your protection and safety. Do not alter it for any reason. If it becomes damaged, do not operate the saw until you have the guard repaired or replaced. Always leave guard in operating position when using the saw.

**⚠ DANGER!** When sawing through work, lower blade guard does not cover blade on the underside of work. Since blade is exposed on underside of work, keep hands and fingers away from cutting area. Any part of your body coming in contact with moving blade will result in serious injury.

**⚠ CAUTION!** Never use saw when guard is not operating correctly. Check the guard for correct operation before each use. The guard is operating correctly when it moves freely and readily returns to the closed position. If you drop the saw, check the lower blade guard and bumper for damage at all depth settings before reuse.

## STARTING/STOPPING THE SAW

See Figure 9, page 4.

This saw is equipped with a worklight that will turn on when the trigger is depressed and will turn off when the trigger is released.

To start the saw:

- ✿ Depress the lock-off button.
- ✿ Depress the switch trigger.

Always let the blade reach full speed, then guide the saw into the work piece.

**⚠ WARNING!** The blade coming in contact with the work piece before it reaches full speed could cause the saw to “kickback” towards you resulting in serious injury.

To stop the saw: release the switch trigger.

After you release the switch trigger, allow the blade to come to a complete stop. Do not remove the saw from the workpiece while the blade is moving.

## LOCK-OFF BUTTON

See Figure 9, page 4.

The lock-off button reduces the possibility of accidental starting. The lock-off button is located on the handle above the switch trigger. The lock-off button must be depressed before you pull the switch trigger. The lock resets each time the trigger is released.

NOTE: You can depress the lock-off button from either the left or right side.

## ADJUSTING BLADE DEPTH

See Figure 10, page 4.

Always keep correct blade depth setting. The correct blade depth setting for all cuts should not exceed 1/4 in. below the material being cut. More blade depth will increase the chance of kickback and cause the cut to be rough. For more depth of cut accuracy, a scale is located on the upper blade guard.

- ✿ Loosen the depth lock lever by lifting it upward away from the base.
- ✿ Determine the desired depth of cut.
- ✿ Locate the depth of cut scale on the back of the upper blade guard.



- ✿ Hold the base flat against the workpiece and raise or lower the saw until the indicator mark on bracket aligns with the notch on the blade guard.
- ✿ Tighten the depth lock lever securely by pushing it downward toward the base.

### **⚠ DANGER! OPERATING THE SAW**

See Figures 11 - 13, page 5.

- ⚠ WARNING!** To make sawing easier and safer, always maintain proper control of the saw. Loss of control could cause an accident resulting in possible serious injury.

To make the best possible cut, follow these helpful hints.

- ✿ Hold the saw firmly with both hands.
- ✿ Avoid placing your hand on the workpiece while making a cut
- ✿ Support the workpiece so that the cut (kerf) is always to your side.
- ✿ Support the workpiece near the cut.
- ✿ Use clamps or other practical ways to secure the workpiece so that the workpiece will not move during the cut.
- ✿ Always place the saw on the workpiece that is supported, not the "cut off" piece.
- ✿ Place the workpiece with the "good" side down.
- ✿ Draw a guideline along the desired line of cut before beginning your cut.

### **CROSS CUTTING/RIP CUTTING**

See Figure 14, page 5.

When making a straight cross cut or rip cut, align the line of cut with the 00 blade guide notch on the base.

Since blade thicknesses vary, always make a trial cut in scrap material along a guideline to determine how much, if any, you must offset the guideline to produce an accurate cut.

NOTE: The distance from the line of cut to the guideline is the amount you should offset the guide.

### **RIP CUTTING**

See Figure 15, page 5.

Use a guide when making long or wide rip cuts with the saw.

- ✿ Secure the workpiece.
- ✿ Clamp a straight edge to the workpiece using C-clamps.
- ✿ Saw along the straight edge to achieve a straight rip

NOTE: Do not bind the blade in the cut.

### **WIDTH OF CUT SCALE**

See Figure 16, page 5.

A width of cut scale is located on the base of the saw. When making straight cross cuts or rip cuts, the scale can be used to measure up to 4-1/2 in. on the right side of the blade, and up to 1 in. on the left side of the blade.

### **BEVEL CUTTING**

See Figures 17 - 18, pages 5 - 6.

- ✿ Adjust the angle of the cut to any desired setting between zero and 56°. Refer to Adjusting the Bevel Setting next.
- ✿ If making a 45° bevel cut, align the line of cut with the 45° blade guide notch on the base.
- ✿ Make a trial cut in scrap material along a guideline to determine how much you should offset the guideline on.

## ADJUSTING THE BEVEL SETTING

See Figure 18, page 6.

- ✿ Loosen the bevel lock knob.
- ✿ Raise the motor housing end of the saw until you reach the desired angle setting on the bevel scale.
- ✿ Tighten the bevel lock knob securely.

**⚠ WARNING!** Attempting a bevel cut without having the bevel lock knob securely tightened can result in serious injury.

NOTE: For bevel cuts 56° and above, move the bevel lock knob into the notch at the 56° mark on the bevel scale, and tighten the knob securely.

## MAKING A BEVEL CUT

See Figure 18, page 6.

- ✿ Hold the saw firmly with both hands as shown.
- ✿ Rest the front edge of the base on the workpiece.
- ✿ Start the saw and let the blade reach full speed.
- ✿ Guide the saw into the workpiece and make the cut.
- ✿ Release the trigger and allow the blade to come to a complete stop.
- ✿ Lift the saw from the workpiece.

See Figure 19, page 16.

## POCKET CUTTING

**⚠ WARNING!** Always adjust bevel setting to zero before making a pocket cut. Attempting a pocket cut at any other setting can result in loss of control of the saw possibly causing serious injury.

- ✿ Adjust the bevel setting to zero.
- ✿ Set the blade to the correct blade depth setting.
- ✿ Swing the lower blade guard up using the lower blade guard handle.

NOTE: Always raise the lower blade guard with the handle to avoid serious injury.

- ✿ Hold the lower blade guard by the handle.

**⚠ WARNING!** Never extend your fingers while holding the lower blade guard handle. Extending your fingers may result in contact with the blade, causing serious injury.

- ✿ Rest the front of the base flat against the workpiece with the rear of the handle raised so the blade does not touch the workpiece.
- ✿ Start the saw and let the blade reach full speed.
- ✿ Guide the saw into the workpiece and make the cut.

**⚠ WARNING!** Always cut in a forward direction when pocket cutting.

Cutting in the reverse direction could cause the saw to climb up on the workpiece and back toward you.

- ✿ Release the trigger and allow the blade to come to a complete stop.
- ✿ Lift the saw from the workpiece.
- ✿ Clear corners out with a hand saw or sabre saw.

**⚠ WARNING!** Never tie the lower blade guard in a raised position. Leaving the blade exposed could lead to serious injury.

## 8. ASSEMBLY

### UNPACKING

This product requires assembly

- ✿ Carefully remove the product and any accessories from the box. All items listed in the Includes section must be included at the time of purchase.

**⚠ WARNING!** Items in this Assembly section are not assembled to the product by the manufacturer and require customer installation. Use of a product that may have been improperly assembled could result in serious personal injury.

- ✿ Inspect the product carefully to make sure no breakage or damage occurred during shipping.
- ✿ Do not discard the packing material until you have carefully inspected and satisfactorily operated the product.

**⚠ WARNING!** If any parts are damaged or missing do not operate this product until the parts are replaced. Use of this product with damaged or missing parts could result in serious personal injury.

**⚠ WARNING!** Do not attempt to modify this product or create accessories not recommended for use with this product. Any such alteration or modification is misuse and could result in a hazardous condition leading to possible serious personal injury.

**⚠ WARNING!** To prevent accidental starting that could cause serious personal injury, always remove the battery pack from the product when assembling parts.

### ATTACHING THE BLADE

See Figure 1, page 3.

**⚠ WARNING!** A 7-1/4 in. blade is the maximum blade capacity of the saw. Never use a blade that is too thick to allow outer blade washer to engage with the flats on the spindle. Larger blades will come in contact with the blade guard, while thicker blades will prevent blade screw from securing blade on spindle. Either of these situations could result in a serious accident.

- ✿ Remove the battery pack from the saw.
- ✿ Remove the blade wrench (6 mm hex key) from the storage area.
- ✿ Depress the spindle lock button and remove the blade screw and outer blade washer.

NOTE: Turn the blade screw clockwise to remove.

**NOTICE!** To prevent damage to the spindle or spindle lock, always allow motor to come to a complete stop before engaging spindle lock.

NOTE: Do not run the circular saw with spindle lock engaged.

- ✿ Wipe a drop of oil onto the inner blade washer and outer blade washer where they contact the blade.

**⚠ WARNING!** If inner blade washer has been removed, replace it before placing blade on spindle. Failure to do so could cause an accident since blade will not tighten properly.

- ✿ Fit the saw blade inside the lower blade guard and onto the spindle. NOTE: The saw teeth point upward at the front of the saw.
- ✿ Replace the outer blade washer.
- ✿ Depress the spindle lock button, then replace the blade screw. Tighten the blade screw securely by turning it counterclockwise.
- ✿ Return the blade wrench to the storage area.

NOTE: Never use a blade that is too thick to allow the outer blade washer to engage with the flats on the spindle.

## REMOVING THE BLADE

See Figure 2, page 3.

- ✿ Remove the battery pack from the saw.
- ✿ Remove the blade wrench from the storage area.
- ✿ Position the saw as shown, depress the spindle lock button, and remove the blade screw by turning it clockwise.
- ✿ Remove the outer blade washer.
- ✿ Remove the blade.

# 9. ADJUSTMENTS

**⚠ WARNING!** To prevent accidental starting that could cause serious personal injury, always remove the battery pack from the product when making adjustments.

## 0° BEVEL STOP

See Figure 20, page 6.

The saw has a 0° bevel stop that has been factory adjusted to assure 0° angle of the saw blade plate when making 90° cuts.

## CHECKING 0° BEVEL STOP

- ✿ Remove battery pack.
- ✿ Place the saw in an upside down position on a workbench.
- ✿ Check the squareness of the saw blade plate to the base of the saw using a carpenter's square.

## 10. MACHINE CARE

### **Overload**

Never use excessive force when cutting. Too much pressure reduces the speed of the machine, and the required power is greatly reduced. This may result in overload which can damage the motor of the machine. When the machine becomes too hot, allow it to run for two minutes at no load and then interrupt working for a short time. Clean the machine with a clean cloth and a brush. Ensure that the ventilation slots are not blocked.

## 11. WARRANTY

The Warranty Card shall be valid only when submitted together with the purchase receipt. Keep the both documents in a safe place. To lodge a warranty complaint, turn to your dealer or a service centre. The warranty shall apply to all product defects and faults that occurred during the warranty period and were demonstrably attributable to material or manufacturing defects. In such cases the product shall be repaired and/or adjusted. The warranty shall not apply to standard wear of the product, as well as to faults attributable to overloading, using of inappropriate accessories or improper operation of the product.

## 12. TECHNICAL DATA

Model	FDUK 70305-0	
Rated Voltage	20V	
Unloaded Speed	4 300RPM	
Saw size	φ165 x φ16 mm	
Cut depth	0°	55 mm
	45°	38 mm

### Accessories

Item number	Accessory
FDUZ 79020	Battery pack 2 Ah
FDUZ 79040	Battery pack 4 Ah
FDUZ 79100	Fast charger
FDUZ 79110	Fast dual charger

## 13. TROUBLESHOOTING

1. The trigger is pressed but the device is not working: For the cordless device to work, you need a succinctly charged battery. The battery will go flat if you do not use the cordless device for an extended period of time. Try charging the battery. Check that the battery is correctly seated in the charger. The charger will heat up while charging, this is normal.
2. The battery is leaking: At extreme temperatures or when under extreme load, a small amount of leakage may occur. If you accidentally touch this liquid, wash your skin or clothing immediately with soap and water.
3. The battery is not charging and the light on the charger is not lit: If the battery is not charging, check that it is correctly seated in the charger and check that the indicator light is lit. If it is not lit, check that the power plug of the charger is correctly plugged into the socket. If it is, check the socket's fuse/circuit breaker.
4. The body of the device heats up after extended use: Under normal load the body, trigger and battery will heat up because the energy consumed when drilling generates heat. This is normal. Simply allow the device to cool down for several minutes.
5. The battery heats up during use: Energy drawn from the battery generates heat. It does not damage the battery, heat from drawing energy is normal. If you wish to cool the battery down, allow the device to cool down for a few minutes before continuing with work.
6. The battery heats up while charging: This is normal and is the result of chemical reactions taking place inside the battery during the charging process.
7. The charging unit will heat up while charging: This is normal and is caused by the reduction of voltage from 230V to 20V.

## 14. DISPOSAL



The machine, rechargeable batteries, accessories and packaging should be sorted for environmental friendly recycling.

Do not dispose of power tools and batteries/rechargeable batteries into household waste!

### Only for EC countries:



According to the European Guideline 2012/19/EU, power tools that are no longer usable, and according to the European Guideline 2006/66/EC, defective or used battery packs/batteries, must be collected separately and disposed of in an environmentally correct manner.

### INSTRUCTIONS AND INFORMATION ON DISPOSING OF USED PACKAGING MATERIALS

Put any used package material to the place determined by the municipality for waste disposal.

### DISPOSAL OF USED ELECTRIC AND ELECTRONIC EQUIPMENT



This symbol on products or accompanying documents means that used electric or electronic products must not be put to ordinary municipal waste. Hand over such products to determined collection points for proper disposal, restoration and recycling. Alternatively, in some countries of the European Union or other European countries you can return your products to your local dealer when you buy an equivalent new product. By dutiful disposal of this product you can preserve precious natural resources and you help prevent any potential adverse effects on the environment and human health which could be the results of wrong waste disposal. Ask your local authority or the nearest collection point for additional details. In case of improper disposal of this waste kind penalties can be imposed in accordance with national regulations.

### For companies in the European Union countries

Should you want to dispose of electric and electronic devices, ask your dealer or vendor for necessary information. Disposal in other countries outside the European Union. Should you want to dispose of this product, ask your local authorities or your dealer for necessary information about disposal method.



This product fulfils all basic requirements of the EU directives that apply to it.

Text, design and technical specifications can change without prior notice and we reserve the right for their change.

User manual in the original language.

