



FIELDMANN[®]
Home & Garden Performance



FVC 3002 ED

English	3
Čeština.....	11
Slovenščina.....	19
Magyarul	27
Polski	35
Slovenščina	43

Submersible Garden Pump

USER'S MANUAL

Thank you for purchasing this pump. Before you start using it, please, carefully read this user's manual and save it for possible future use.

CONTENTS

1. GENERAL SAFETY INSTRUCTIONS	4
Important safety information	4
Packaging	4
User's Manual	4
Electrical safety	4
2. DESCRIPTION OF THE POWER TOOL AND INCLUDED CONTENTS	5
Description of the power tool (see Fig. 1)	5
3. ASSEMBLING THE PUMP	5
4. OPERATING INSTRUCTIONS	6
Applications	6
5. PUTTING INTO OPERATION	6
Setting the float switch	7
6. MAINTENANCE AND STORAGE	7
Maintenance	7
Storage	7
7. WHAT TO DO "WHEN..."	8
8. TECHNICAL SPECIFICATIONS	9
9. DISPOSAL	9

1. GENERAL SAFETY INSTRUCTIONS

Important safety notice

- ☼ Carefully unpack the product and take care not to throw away any part of the packaging before you find all the parts of the product.
- ☼ Read all warnings and instructions. Not following warnings or instructions may lead to injury by electrical shock, a fire and/or serious injuries.

⚠ ATTENTION! Protect yourself against electrical shock!

Packaging

The device is located in a package that prevents damage during transport. This package is a resource and so can be handed over for recycling.

Instructions for use

Before you start working with the pump, read the following safety instructions and user's manual. Learn about all parts and the correct use of the device. Keep the user's manual in a safe place where it can be easily retrieved for future use. If you hand over the device to somebody else, do so together with the user's manual. Following the instructions in the included user's manual is a prerequisite for safe use of the garden appliance. The user's manual also contains operating, maintenance and repair instructions.

📖 NOTE: If you hand over the appliance to somebody else, do so together with this user's manual. Following the instructions in the included user's manual is a prerequisite for the proper use of the appliance. The user's manual also contains operating, maintenance and repair instructions.

Electrical safety

The pump can be connected to any power plug installed according to given norms. The plug must be powered at 230 V ~ 50 Hz.

⚠ ATTENTION! Important for the protection of your personal safety. Before first starting your new submersible pump, have a professional check the following items:

- Grounding
- Neutral conductor

The current circuit breaker must conform to energy safety norms and must function perfectly.

The electrical connection must be protected against moisture.

If there exists a danger of the electrical connection being flooded, it must be moved higher.

Under all circumstances prevent the circulation of aggressive liquids and coarse materials.

The submersible pump must be protected against frost.

The pump must be protected against running empty.

Prevent children from accessing parts of the pump by appropriate measures.

The manufacturer takes no responsibility for accidents or damages resulting from not following the instructions in this manual.

2. DESCRIPTION OF THE GARDEN APPLIANCE AND INCLUDED CONTENTS

Description of the garden appliance (see Fig. 1)

1. Pump body
2. Power cord
3. Socket with shut-off valve
4. Hook for hanging the pump in a barrel
5. Float switch
6. Extension tube
7. Extension tube with a hanging hook
8. Outflow tube
9. Gasket seal

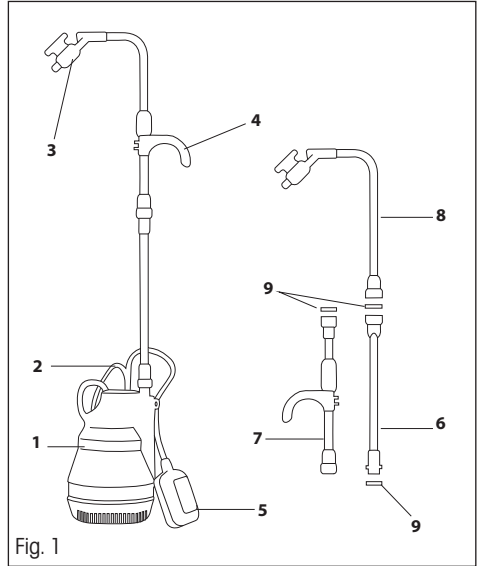

Fig. 1

3. ASSEMBLING THE PUMP

- ✿ Depending on the depth of the tank, connect one or both extension tubes to the pump body.
- ✿ Put gasket seals into the individual connection points.
- ✿ These extension tubes are telescopic, meaning that a precise length can be set depending on the depth of the tank. After setting the required length, tighten the connection points.
- ✿ A hose can be connected to the pump using a standard hose quick coupler

4. OPERATING INSTRUCTIONS

Purpose of use

- ✿ This pump may be used at any time to transfer water from one location to another.
- ✿ The appliance is intended for private household use and is not suitable for professional applications.
- ✿ It is not suitable for work with waste water in sewage systems, salt water, aggressive or easily combustible substances, for work in food processing or as a pump for water jets on garden ponds.
- ✿ It is not designed for pumping drinking water!

NOTE: Before using the submersible pump, please first carefully read all the safety and operating instructions for the pump. Only after reading these instructions will you be able to safely and reliably use all the functions of the pump. You must conform to all local regulations in force in your country. These regulations are effective together with the particulars specified in these instructions.

ATTENTION! If you will be using the pump near pools or garden ponds, or in their protective zone, the electrical grid must be equipped with a circuit breaker.
The pump must not be used, if there are people in the pool or garden pond! Also do not use it if there are fish or other living creatures in the pool or garden pond.
The submersible pump is designed to pump water at a maximum temperature of 35 °C.
The pump must not be used for other liquids, particularly motor oils, cleaning agents and other chemical products!

5. PUTTING INTO OPERATION

ATTENTION! You should never install the pump by hanging it on the outlet hose or power cord without additional support.
The submersible pump must be hung on a hook (Fig. 1, point 4) or it must be placed on the bottom of the tank.
For the pump to function correctly, the pumped liquid must not contain foreign objects that are larger than specified in the overview of technical parameters.

After carefully reading these instructions you can prepare your pump for operation, however, keep the following points in mind:

- ✿ Check that the pump is standing on the bottom of the tank or that it is hung by the hook.
- ✿ Check that the outlet hose has been attached correctly.



Fig. 2

- ☼ Ensure that the moisture from the water can never get to the electrical power source.
- ☼ Prevent the pump from running empty.

Setting the float switch

⚠ ATTENTION! The float switch is installed in such a way that it is possible to reach the activation level or the shut off level with only a small amount of force. After checking this installation, place the pump into a tank with water and carefully lift the float switch by hand and then put it down again. During this activity watch that the pump has started and then turned itself off.

By shortening the available length of cable between the pump and the float switch it is possible to adjust the water level at which the pump is started and stopped. The float switch can be secured in place on the side of the pump.

⚠ ATTENTION! As soon as you set the float switch, check that it is not touching anywhere before the pump turns off.

⚠ ATTENTION! Risk of dry running – The pump is cooled using the pumped liquid. In the event of dry running, the pump motor may burn up.

📖 NOTE: The tank for the pump should have the minimum dimensions of 40 × 40 × 50 cm (height × width × depth), for the float to freely move with the switch.

6. MAINTENANCE AND STORAGE

This submersible pump is approved as a maintenance-free product undergoing several final inspections. We recommend you perform regular inspections and maintenance, which will ensure a long lifetime and continuous performance.

⚠ ATTENTION! Disconnect the power source before performing any maintenance.

Maintenance

- ☼ If the pump is regularly moved during operation, it should be rinsed out after each use with clean water.
- ☼ If the pump is permanently installed, the working order of the float switch should be checked every 3 months.
- ☼ Any fibrous deposits that could deposit themselves inside the pump, should be removed using a water current.
- ☼ Remove deposits on the float using clean water.
- ☼ If an excessive amount of debris accumulates in the body of the pump, flush the pump out with clean water.





Storage

- ☼ Store the thoroughly cleaned out pump in a dry place out of children's reach.

7. WHAT TO DO "WHEN..."

When...	Causes	Repairs
The pump does not start	No power supply	Check the power supply
	The float does not switch	Move the float to a higher position
Not flowing	The suction sieve is clogged	Flush out the suction sieve with a current of water
	The pressure hose is bent	Straighten the hose
The pump does not turn off	The float cannot fall lower	Place the pump correctly on the floor of the tank
Insufficient flow	The suction sieve is clogged	Clean the suction sieve
	Lowered pump capacity due to dirty and silted water	Clean the pump and flush the hose with clean water
The pump turns off after a short time	The temperature fuse stops the pump due to dirty water	Disconnect the power plug. Clean the pump and the pumping pit
	The water is too hot. The temperature fuse stops the pump	Check that the maximum water temperature of 35 °C is not exceeded

NOTE: Not covered by warranty:

-  Damage to the rotating mechanical gasket caused by running the pump empty, or by foreign objects in the water
-  Blocking of the running wheel by foreign objects
-  Damage during transport
-  Damage caused by unprofessional alterations by persons

8. TECHNICAL SPECIFICATIONS

Model	FVC 3002-ED
Voltage/Frequency	230 V ~ 50 Hz
Power input	250 W
Maximum transferred amount	2,200 l/h
Maximum delivery	9 m
Maximum submersible depth.....	7 m
Maximum media temperature.....	35 °C
Maximum size of solid particles in the media Dia.....	3 mm
Height of the switching point: Started.....	approx. 50 cm
Height of the switching point: Stopped.....	approx. 5 cm
Length of the power cord	10 m
Maximum pressure	0.9 bar
Hose connection	standard quick coupler
Total height of the pump	120 cm
Weight.....	3.5 kg

9. DISPOSAL

INSTRUCTIONS AND INFORMATION REGARDING THE DISPOSAL OF USED PACKAGING MATERIALS

Dispose of used packaging material at a site designated for waste in your municipality.



The appliance and its accessories are manufactured from various materials, e.g. metal and plastic.

Take damaged parts to a recycling centre. Inquire at the relevant government department.



This appliance meets all the basic requirements of EU directives related to it.

Changes in the text, design and technical specifications may be made without prior notice and we reserve the right to make these changes.

User's manual in the original language.

